

CERTIFICATE OF LOCATION OF GOVERNMENT CORNER

County of Anoka

State of Minnesota

West 1/4 Corner of Sec. 35 Township 33 Range 22

On the 28th day of October, 1971, the described corner was evidenced by a concrete monument

and to perpetuate the location of said corner, at the exact location thereof, a permanent marker was placed consisting of the same concrete monument

AND on the 12th day of July, 2003, said permanent marker was found laying on its side facing west. It was reset and the ties were updated.

Updated reference ties are as shown below.

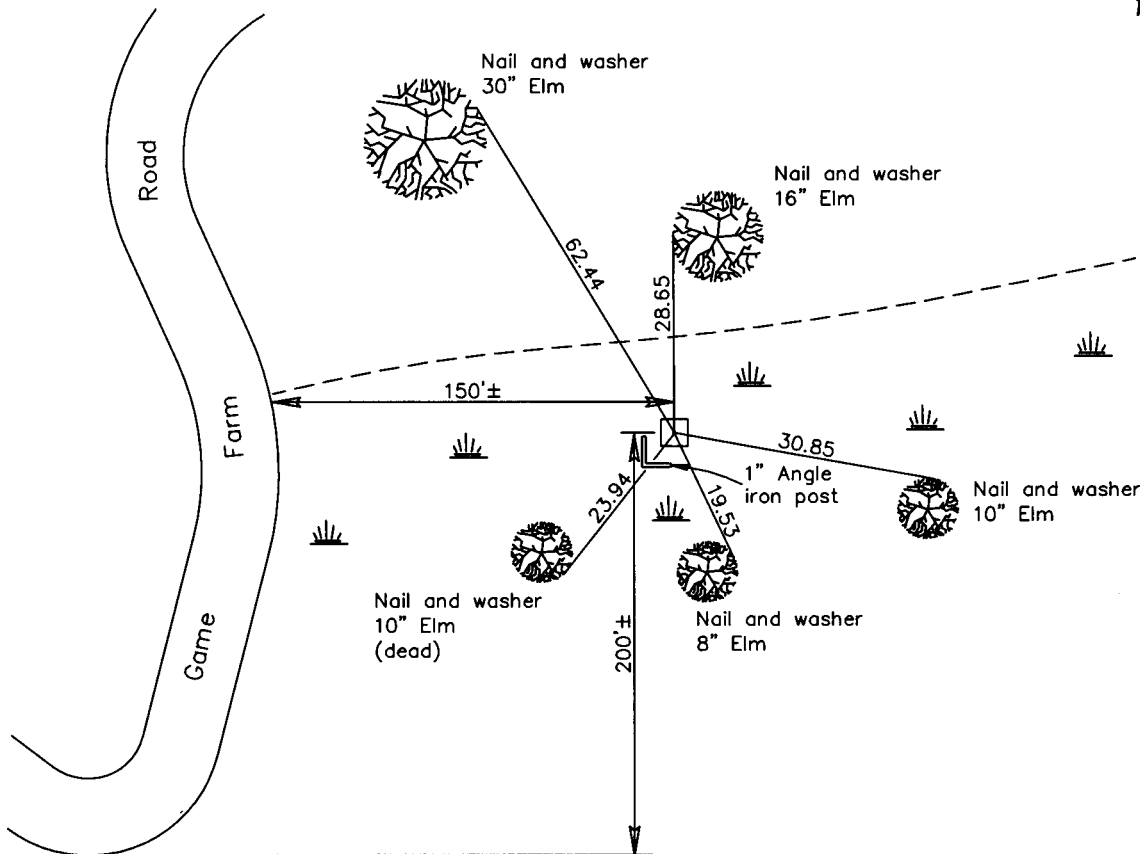
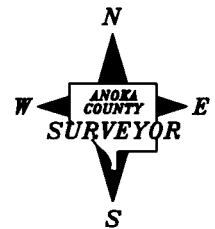

Revised date

10/17/90
7/12/03
5/04/05

N.A.D. 1983 Coordinates
(1996 Adjustment)

County Project Coordinates	
Northing	<u>198133.6045</u>
Easting	<u>553022.0571</u>
Date	<u>5/04/05</u>

I hereby certify that this United States public land survey monument record is correct and complete to the best of my knowledge and belief.

Larry D. Hoium Date 5/04/05
 _____, Anoka County Surveyor
 Minnesota License Number 18165