

CERTIFICATE OF LOCATION OF GOVERNMENT CORNER

County of Anoka

State of Minnesota

North 1/4 Corner of Sec. 26 Township 34 Range 22

On the 19th day of August, 1966, the described corner was evidenced by a cast iron monument set by N.C. Hoium in place of a concrete monument

and to perpetuate the location of said corner, at the exact location thereof, a permanent marker was placed consisting of the same cast iron monument with a sign and post on the north side

AND on the 4th day of February, 2014, said permanent marker was found and the ties were updated

Updated reference ties are as shown below.

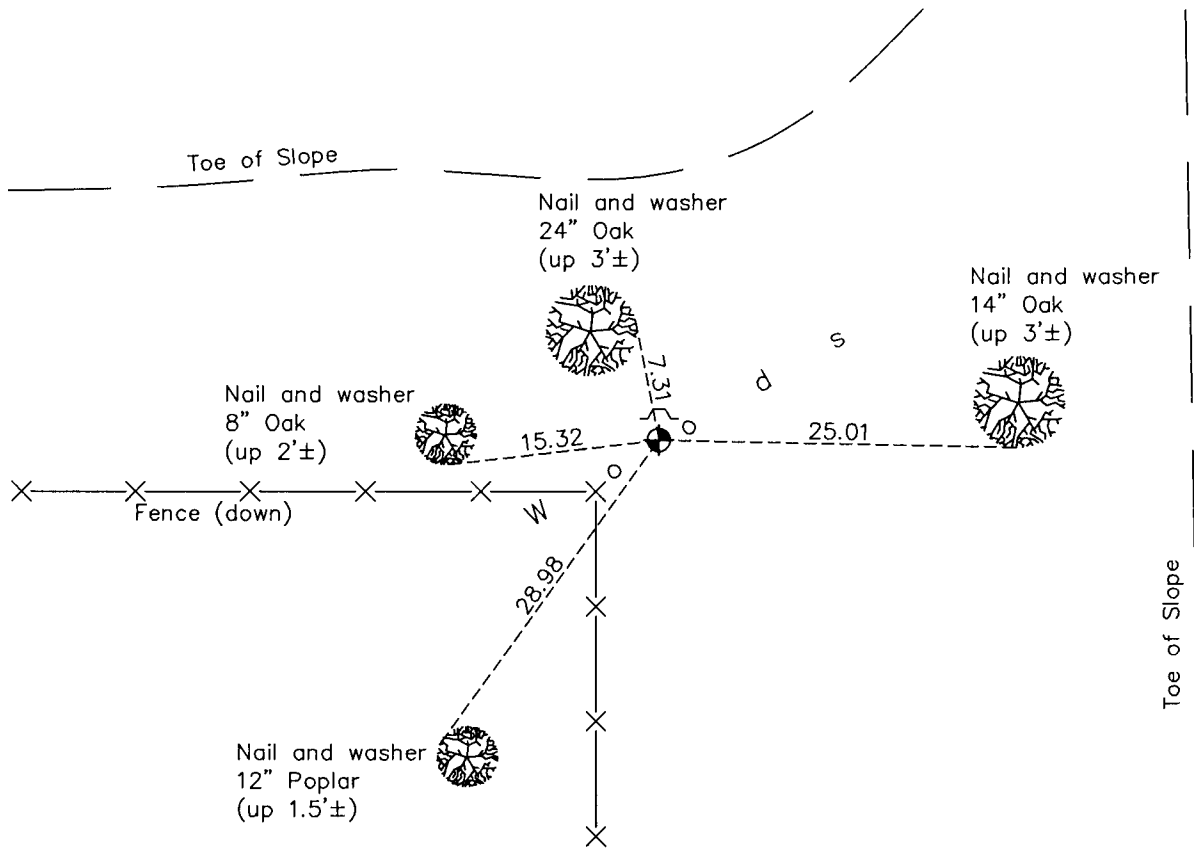

N

ANOKA COUNTY SURVEYOR

S

Revision Date

11/05/15

N.A.D. 1983 Coordinates
(1996 Adjustment)

County Project Coordinates	
Northing	237541.5829
Easting	555560.3500
Date	1/20/04

I hereby certify that this United States public land survey monument record is correct and complete to the best of my knowledge and belief.

Larry D. Hoium Date 11/05/15

Larry D. Hoium, Anoka County Surveyor

Minnesota License Number 18165