

CERTIFICATE OF LOCATION OF GOVERNMENT CORNER

County of Anoka

State of Minnesota

South $\frac{1}{4}$ Corner of Sec. 26 Township 34 Range 22

On the 16th day of August, 1966, the described corner was evidenced by a concrete monument

and to perpetuate the location of said corner, at the exact location thereof, a permanent marker was placed consisting of the same concrete monument with a sign and post on the north side

AND on the 15th day of January, 2014, said permanent marker was found up 0.5'± with a sign and post on the south side and the ties were updated

Updated reference ties are as shown below.

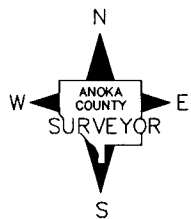
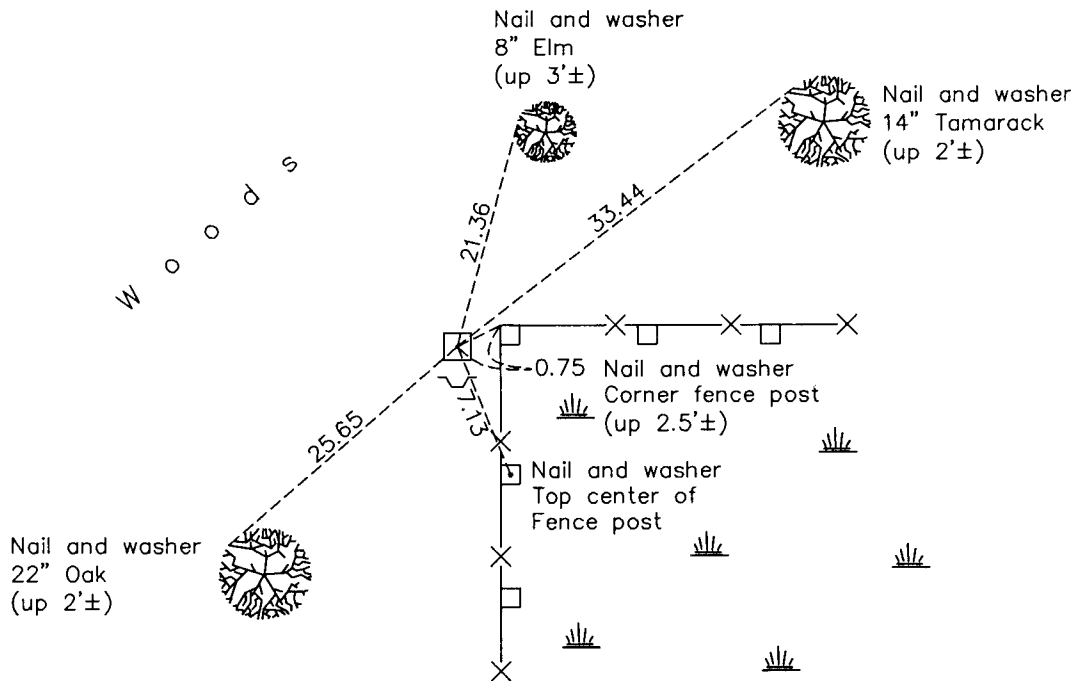

Revision Date
12/18/15

N.A.D. 1983 Coordinates
(1996 Adjustment)

County Project Coordinates	
Northing	<u>232250.7443</u>
Easting	<u>555699.6138</u>
Date	<u>1/21/04</u>

I hereby certify that this United States public land survey monument record is correct and complete to the best of my knowledge and belief.

Larry D. Hoium Date 12/18/15

Larry D. Hoium, Anoka County Surveyor

Minnesota License Number 18165