

CERTIFICATE OF LOCATION OF GOVERNMENT CORNER

County of Anoka

State of Minnesota

Meander Corner of Sec. 34 Township 34 Range 22

(on west line of section)

On the 27th day of April, 1966, the described corner was evidenced by a 1/2" pinched iron pipe. Also the southwest corner of Lot 1, Block 1, Hewson's Addition.

and to perpetuate the location of said corner, at the exact location thereof, a permanent marker was placed consisting of a cast iron monument

AND on the 5th day of May, 2014, said permanent marker was found down 1'± and the ties were updated

Updated reference ties are as shown below.

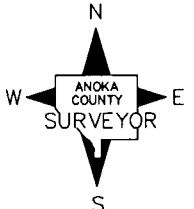
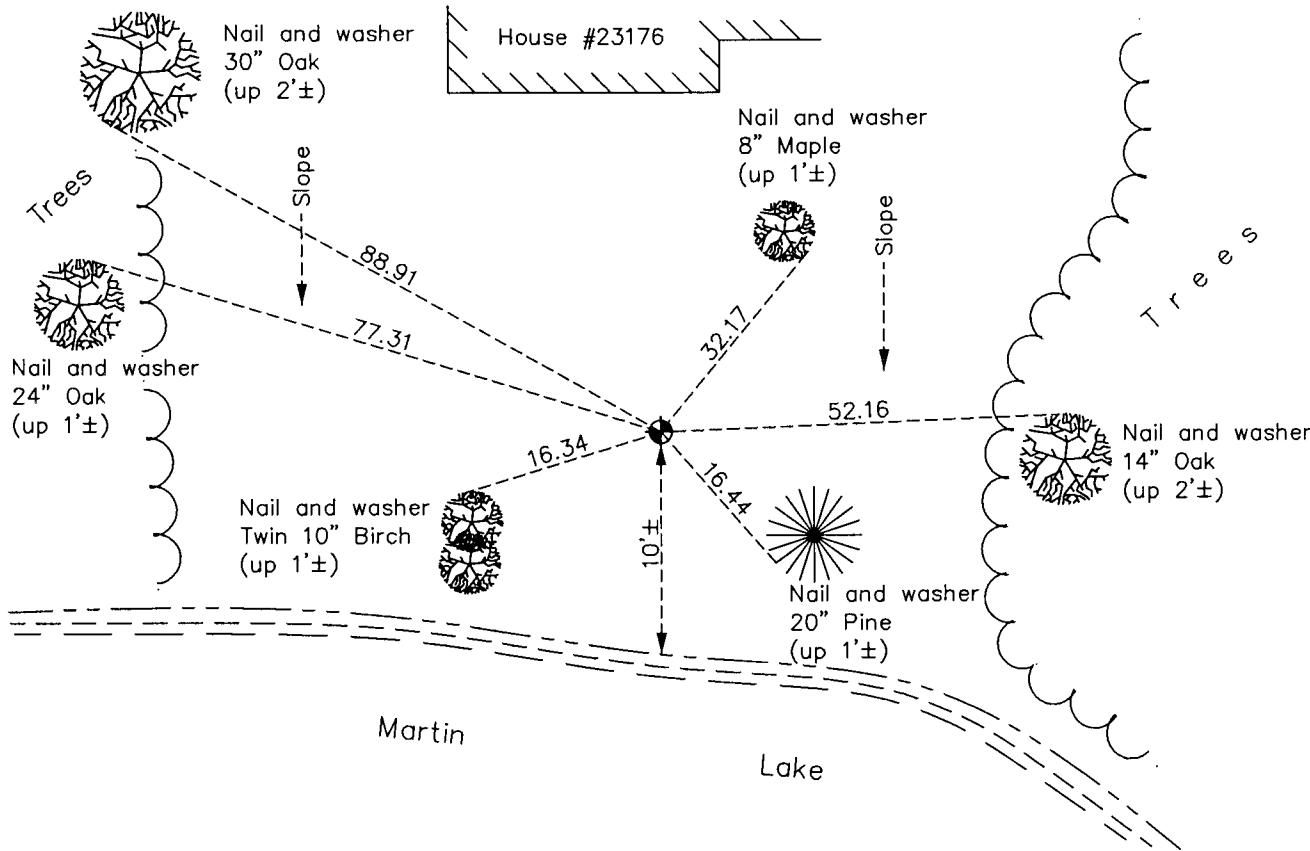

Revision Date
 12/24/15

N.A.D. 1983 Coordinates
 (1996 Adjustment)

| | |
|----------------------------|-------------|
| County Project Coordinates | |
| Northing | 228942.1993 |
| Easting | 547788.8844 |
| Date | 2/02/05 |

I hereby certify that this United States public land survey monument record is correct and complete to the best of my knowledge and belief.

Larry D. Hoium Date 12/24/15
 Larry D. Hoium, Anoka County Surveyor
 Minnesota License Number 18165