

# CERTIFICATE OF LOCATION OF GOVERNMENT CORNER

County of Anoka

State of Minnesota

## Northeast Corner of Sec. 30 Township 34 Range 23

On the 23rd day of December, 1966, the described corner was evidenced by area resurvey

and to perpetuate the location of said corner, at the exact location thereof, a permanent marker was placed consisting of a cast iron monument

AND on the 6th day of December, 2012, said permanent marker was found and the ties were updated. Found Isanti County sign and post on the west side.

Updated reference ties are as shown below.

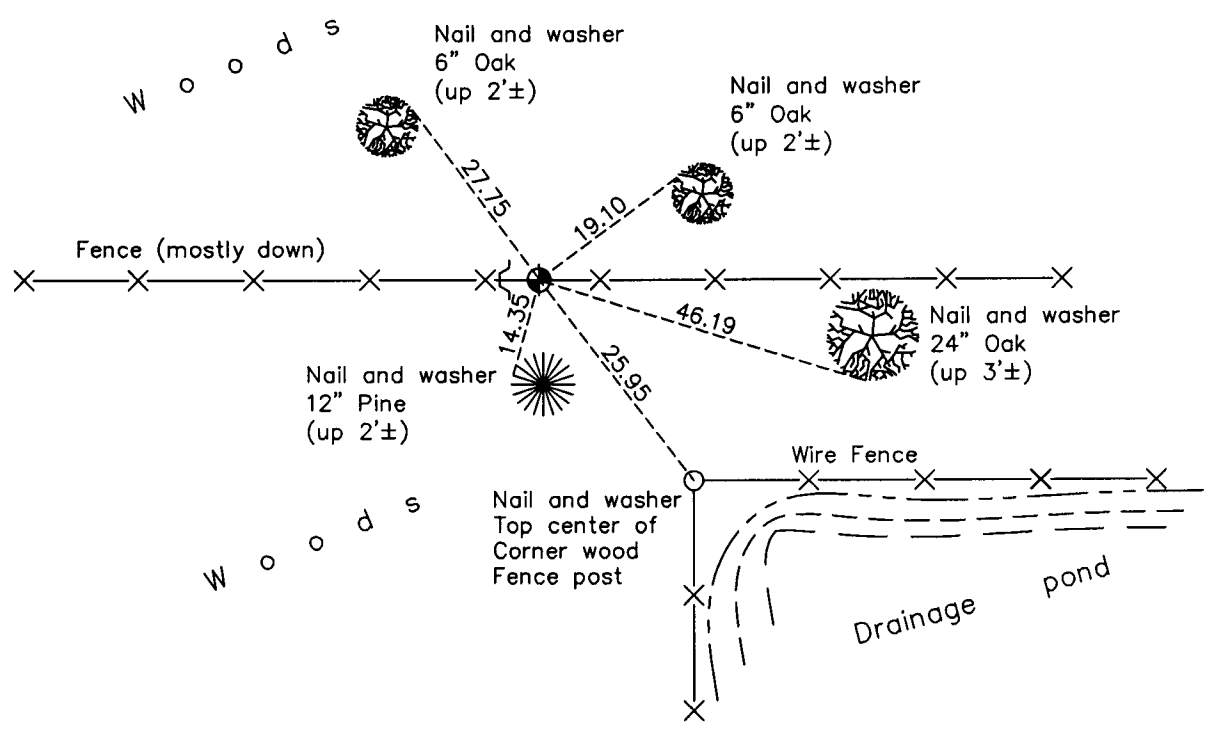

N  
W ANOKA COUNTY SURVEYOR E  
S

Revision Date  
**3/19/13**

N.A.D. 1983 Coordinates  
(1996 Adjustment)

County Project Coordinates	
Northing	238000.3809
Easting	505437.4101
Date	3/27/03

I hereby certify that this United States public land survey monument record is correct and complete to the best of my knowledge and belief.

*Larry D. Hoium* Date 3/19/13  
 Larry D. Hoium, Anoka County Surveyor  
 Minnesota License Number 18165