

# CERTIFICATE OF LOCATION OF GOVERNMENT CORNER

County of Anoka

State of Minnesota

## Meander Corner of Sec. 25 Township 34 Range 23 (on south line of NW 1/4)

On the 23rd day of April, 1965, the described corner was evidenced by a 1 1/2" iron pipe by N.C. Hoium

and to perpetuate the location of said corner, at the exact location thereof, a permanent marker was placed consisting of a cast iron monument with a sign and post on the north side

AND on the 25th day of April, 2012, said permanent marker was found down 0.2'± and the ties were updated

Updated reference ties are as shown below.

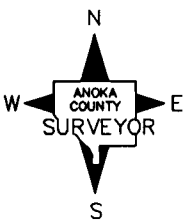
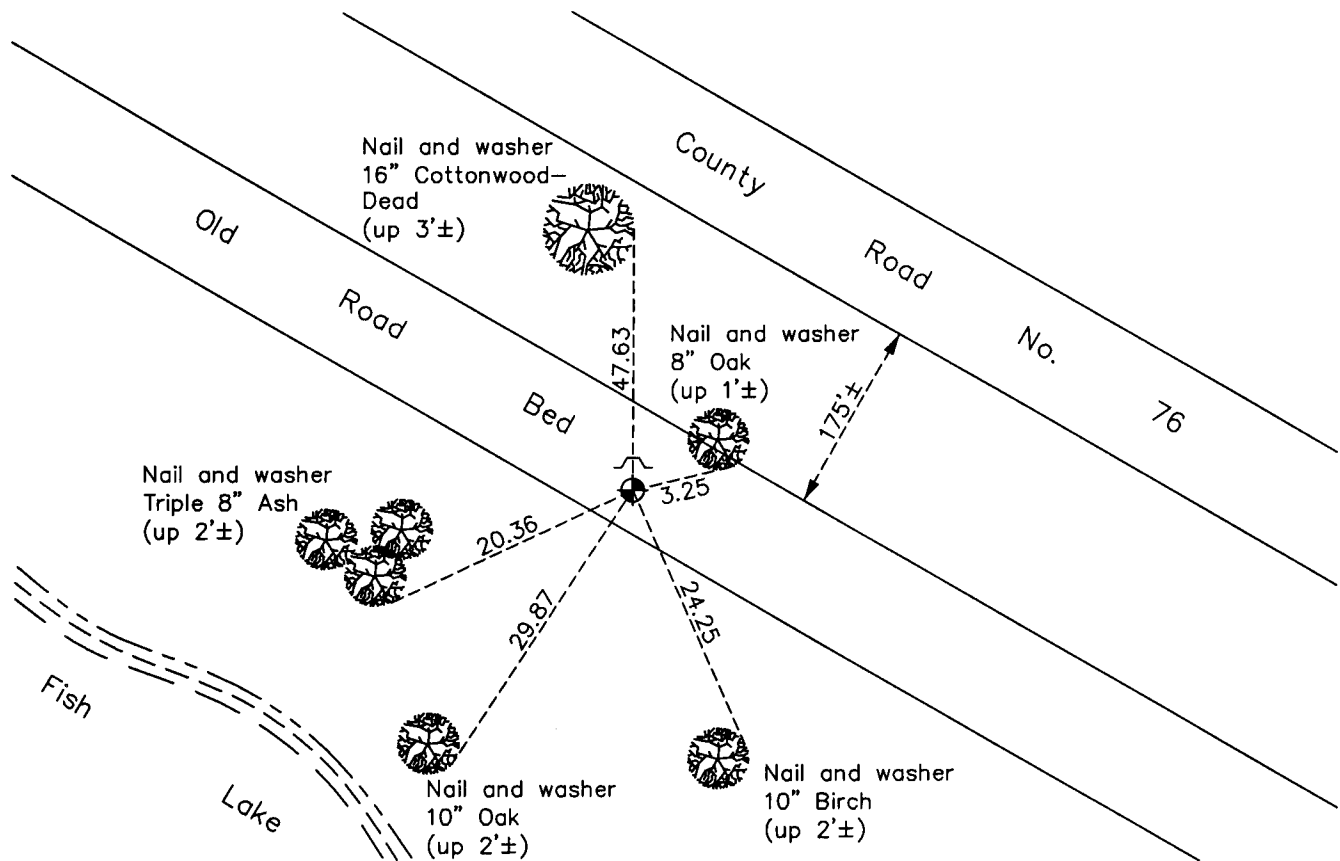

Revision Date  
3/20/13

N.A.D. 1983 Coordinates  
(1996 Adjustment)

County Project Coordinates	
Northing	235481.1290
Easting	527535.9661
Date	5/22/02

I hereby certify that this United States public land survey monument record is correct and complete to the best of my knowledge and belief.

*Larry D. Hoium* Date 3/20/13

Larry D. Hoium, Anoka County Surveyor

Minnesota License Number 18165