

CERTIFICATE OF LOCATION OF GOVERNMENT CORNER

County of Anoka

State of Minnesota

Northwest Corner of Sec. 33 Township 34 Range 23

On the 23rd day of July, 1962, the described corner was evidenced by a 1" iron pipe

and to perpetuate the location of said corner, at the exact location thereof, a permanent marker was placed consisting of a cast iron monument

AND on the 1st day of August, 2012, said permanent marker was found and the ties
were updated

Updated reference ties are as shown below.

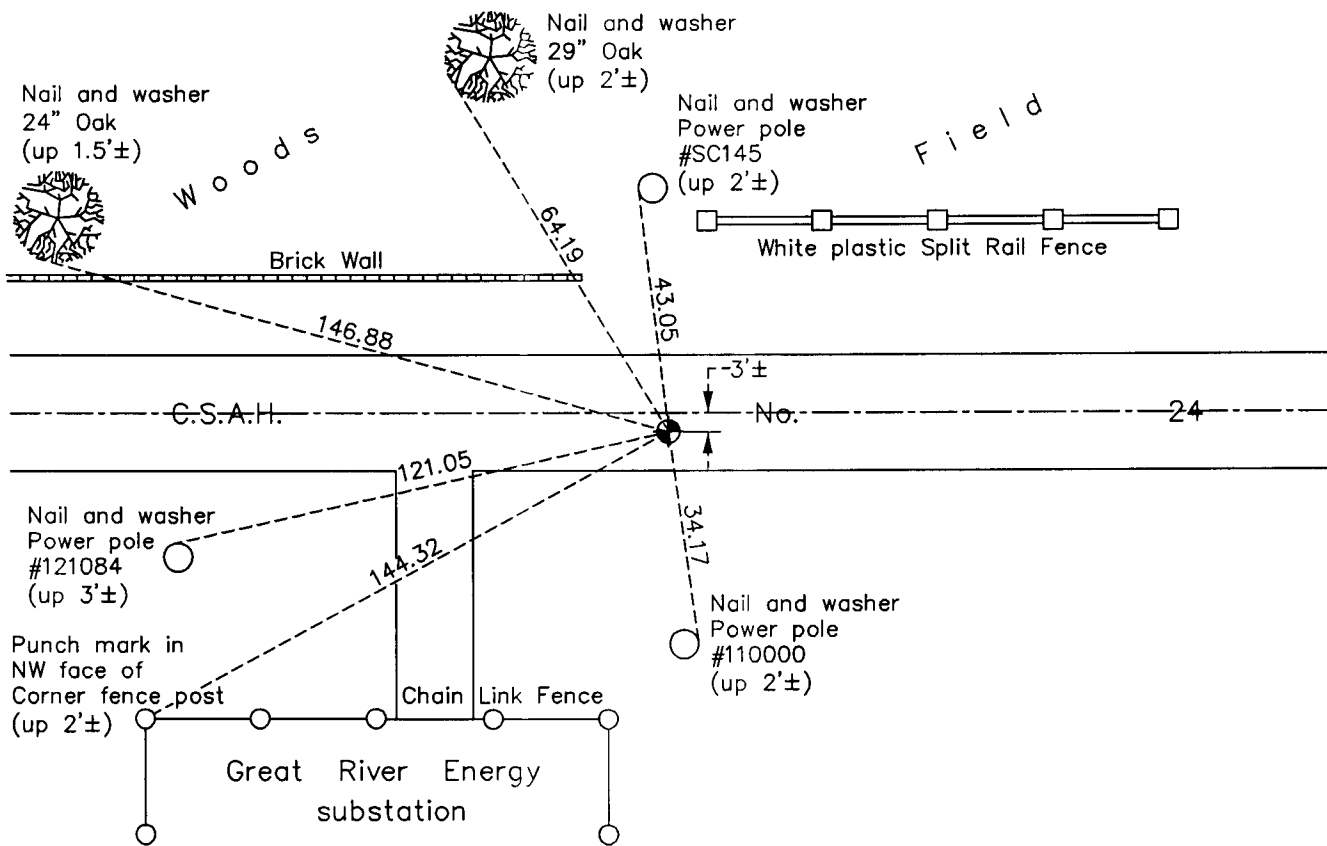

N

S

W ANOKA COUNTY SURVEYOR E

Revision Date

3/26/13

N.A.D. 1983 Coordinates
(1996 Adjustment)

County Project Coordinates	
Northing	232754.5525
Easting	510857.8128
Date	5/09/02

I hereby certify that this United States public land survey monument record is correct and complete to the best of my knowledge and belief.

Date 3/26/13

Larry D. Hoium, Anoka County Surveyor
 Minnesota License Number 18165