

CERTIFICATE OF LOCATION OF GOVERNMENT CORNER

County of Anoka

State of Minnesota

North $\frac{1}{4}$ Corner of Sec. 2 Township 30 Range 24

On the 28th day of June, 1960, the described corner was evidenced by an iron fence post

and to perpetuate the location of said corner, at the exact location thereof, a permanent marker was placed consisting of a cast iron monument

AND on the 25th day of November, 2014, said permanent marker was found and raised to flush with the surface and the ties were updated

Updated reference ties are as shown below.

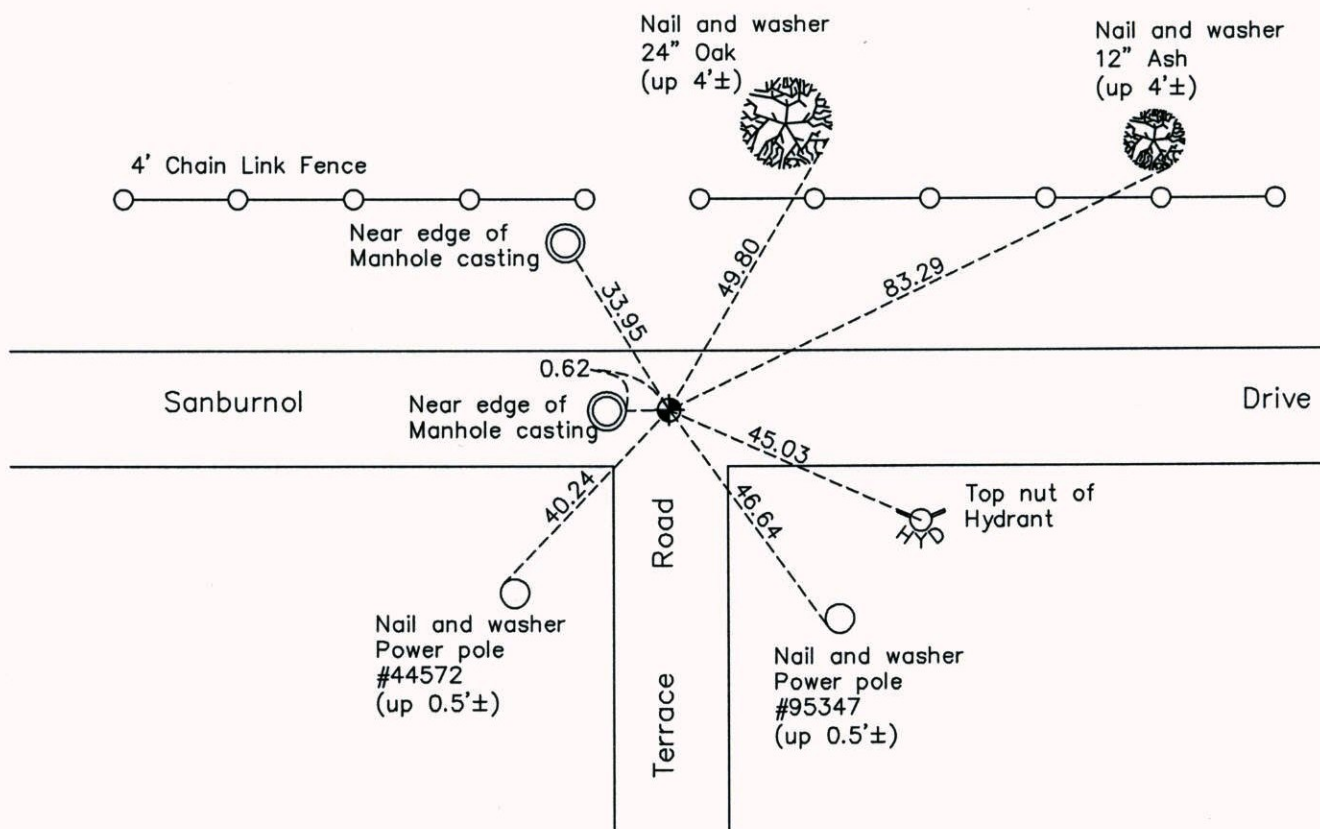

Revision Date
3/13/15

N.A.D. 1983 Coordinates
(1996 Adjustment)

County Project Coordinates	
Northing	<u>132550.4796</u>
Easting	<u>502067.1466</u>
Date	<u>7/01/04</u>

I hereby certify that this United States public land survey monument record is correct and complete to the best of my knowledge and belief.

Larry D. Hoium Date 3/13/15

Larry D. Hoium, Anoka County Surveyor
Minnesota License Number 18165