

# CERTIFICATE OF LOCATION OF GOVERNMENT CORNER

County of Anoka

State of Minnesota

## Northwest Corner of Sec. 3 Township 30 Range 24

On the 10th day of April, 1943, the described corner was evidenced by a granite monument

and to perpetuate the location of said corner, at the exact location thereof, a permanent marker was placed consisting of the same granite monument

AND on the 20th day of November, 2014, said permanent marker was found and the ties were updated

Updated reference ties are as shown below.

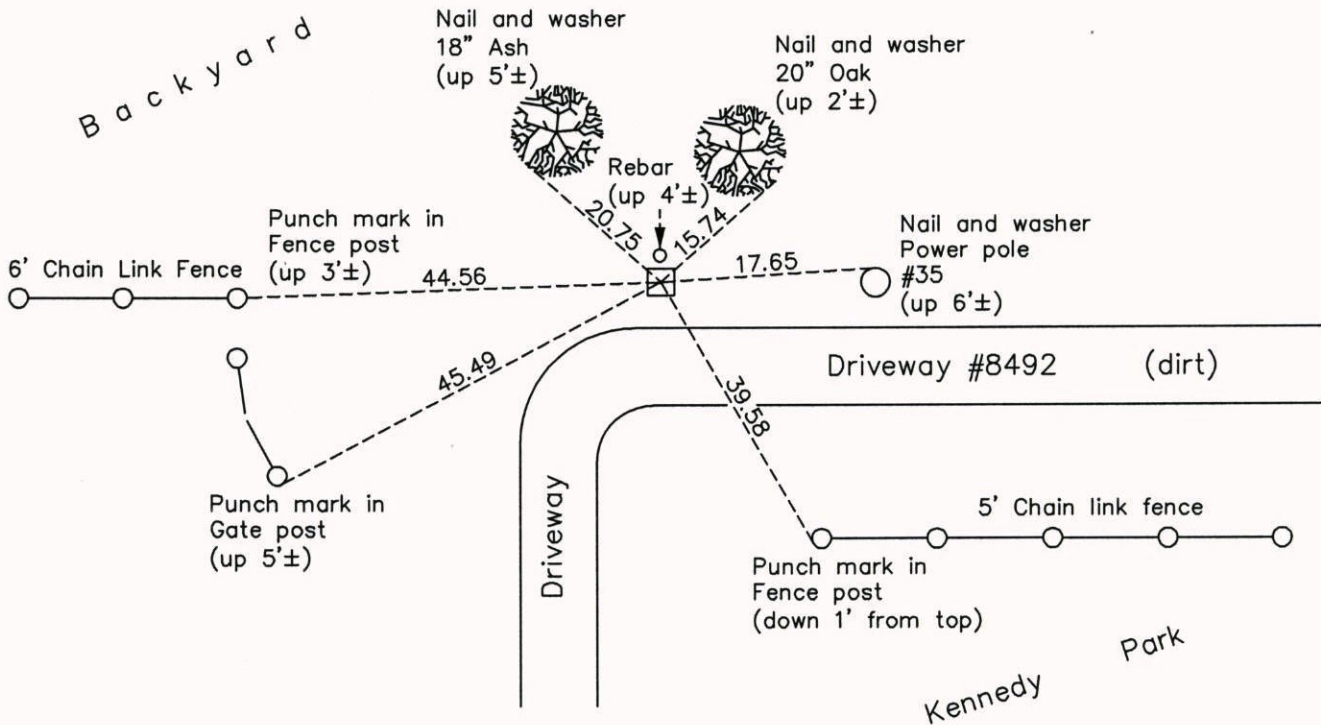

N  
  
 ANOKA COUNTY SURVEYOR  
 S  
 Revision Date  
3/16/15

N.A.D. 1983 Coordinates  
(1996 Adjustment)

County Project Coordinates	
Northing	132472.4087
Easting	494124.5336
Date	12/15/04

I hereby certify that this United States public land survey monument record is correct and complete to the best of my knowledge and belief.

*Larry D. Hoium* Date 3/16/15

Larry D. Hoium, Anoka County Surveyor  
 Minnesota License Number 18165