

CERTIFICATE OF LOCATION OF GOVERNMENT CORNER

County of Anoka

State of Minnesota

East 1/4 Corner of Sec. 2 Township 30 Range 24

On the 31st day of January, 1958, the described corner was evidenced by a 1/2" pinched iron pipe

and to perpetuate the location of said corner, at the exact location thereof, a permanent marker was placed consisting of a 1/2" iron pipe

AND on the 1st day of April, 2015, said permanent marker was found replaced by a P.K.nail. Replaced P.K. nail with a 1/2" iron pipe w/ Anoka Co. cap and the ties were updated.

Updated reference ties are as shown below.

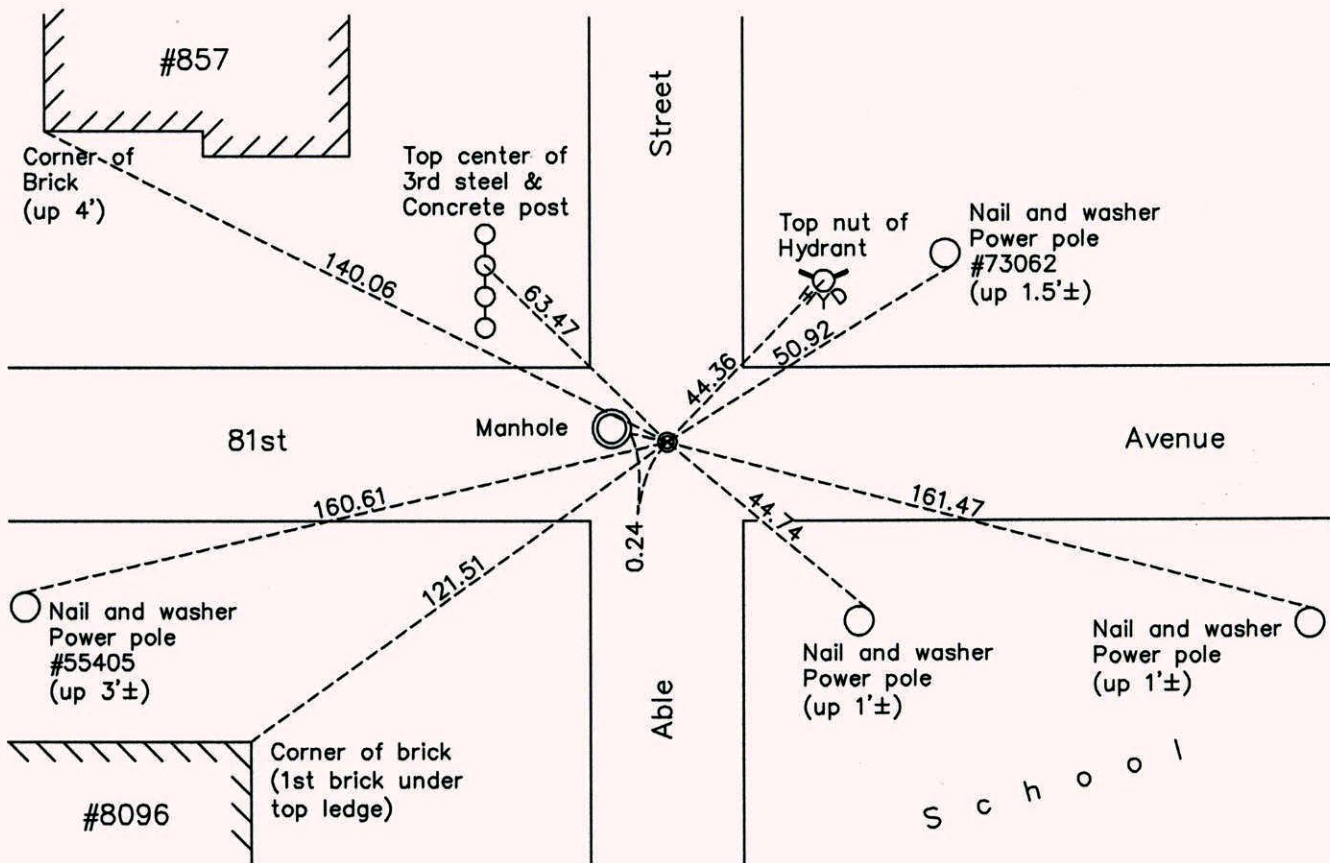

Revision Date
4/13/15

N.A.D. 1983 Coordinates
(1996 Adjustment)

County Project Coordinates	
Northing	129095.2483
Easting	504724.9179
Date	8/13/03

I hereby certify that this United States public land survey monument record is correct and complete to the best of my knowledge and belief.

Larry D. Hoium Date 4/13/15

Larry D. Hoium, Anoka County Surveyor
Minnesota License Number 18165