

# CERTIFICATE OF LOCATION OF GOVERNMENT CORNER

County of Anoka

State of Minnesota

## East 1/4 Corner of Sec. 11 Township 30 Range 24

On the 11th day of January, 1961, the described corner was evidenced by a granite monument

and to perpetuate the location of said corner, at the exact location thereof, a permanent marker was placed consisting of file marks on the manhole rim North, South, East and West of corner location which falls on the manhole cover (granite monument was removed prior to sewer const.)

AND on the 7th day of November, 2014, said permanent marker was found and the ties were updated

Updated reference ties are as shown below.

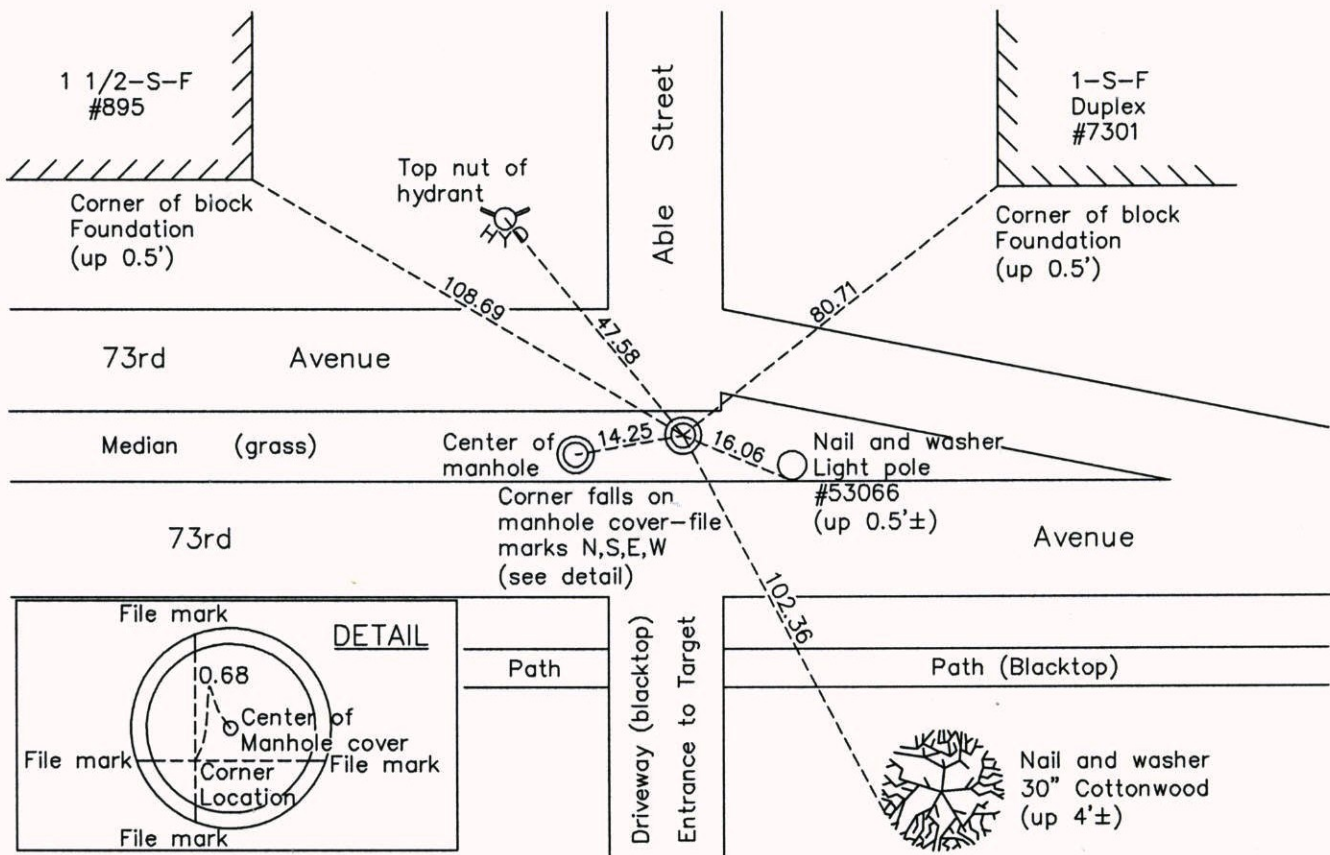

Revision Date  
3/20/15

N.A.D. 1983 Coordinates  
(1996 Adjustment)

| County Project Coordinates |             |
|----------------------------|-------------|
| Northing                   | 123798.4206 |
| Easting                    | 504710.0918 |
| Date                       | 2/15/05     |

I hereby certify that this United States public land survey monument record is correct and complete to the best of my knowledge and belief.

*Larry D. Hoium* Date 3/20/15

Larry D. Hoium, Anoka County Surveyor

Minnesota License Number 18165