

CERTIFICATE OF LOCATION OF GOVERNMENT CORNER

County of Anoka

State of Minnesota

East 1/4 Corner of Sec. 13 Township 30 Range 24

On the 19th day of September, 1961, the described corner was evidenced by a granite monument

and to perpetuate the location of said corner, at the exact location thereof, a permanent marker was placed consisting of a cast iron monument

AND on the 29th day of October, 2014, said permanent marker was found and the ties were updated

Updated reference ties are as shown below.

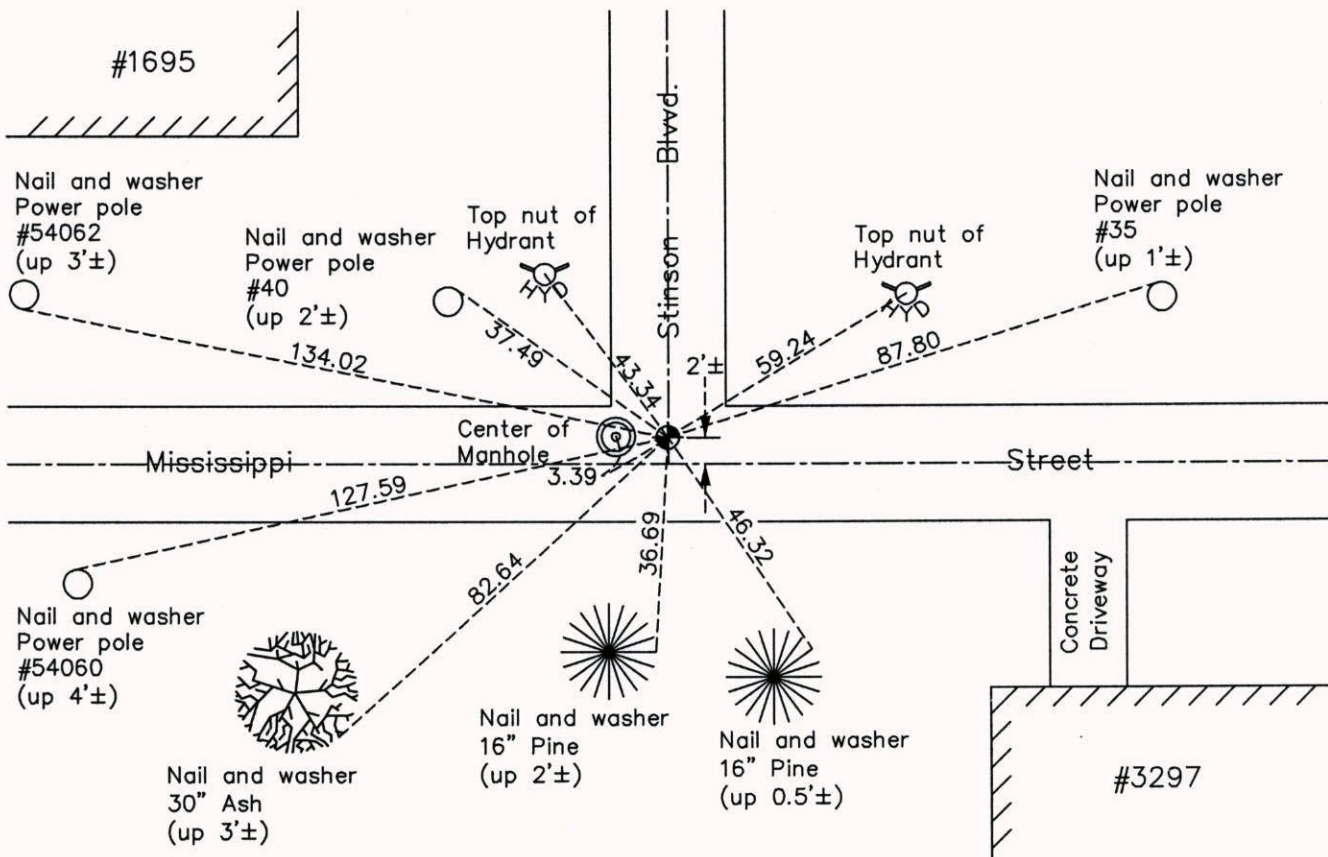

N
W ANOKA COUNTY SURVEYOR E
S

Revision Date 3/25/15

N.A.D. 1983 Coordinates
(1996 Adjustment)

County Project Coordinates	
Northing	118469.2442
Easting	510077.1391
Date	7/21/04

I hereby certify that this United States public land survey monument record is correct and complete to the best of my knowledge and belief.

Larry D. Hoium Date 3/25/15

Larry D. Hoium, Anoka County Surveyor
Minnesota License Number 18165