

CERTIFICATE OF LOCATION OF GOVERNMENT CORNER

County of Anoka

State of Minnesota

Northwest Corner of Sec. 26 Township 30 Range 24

On the 13th day of September, 1964, the described corner was evidenced by a penny nail

and to perpetuate the location of said corner, at the exact location thereof, a permanent marker was placed consisting of a cast iron monument

AND on the 27th day of October, 2014, said permanent marker was found and the ties were updated

Updated reference ties are as shown below.

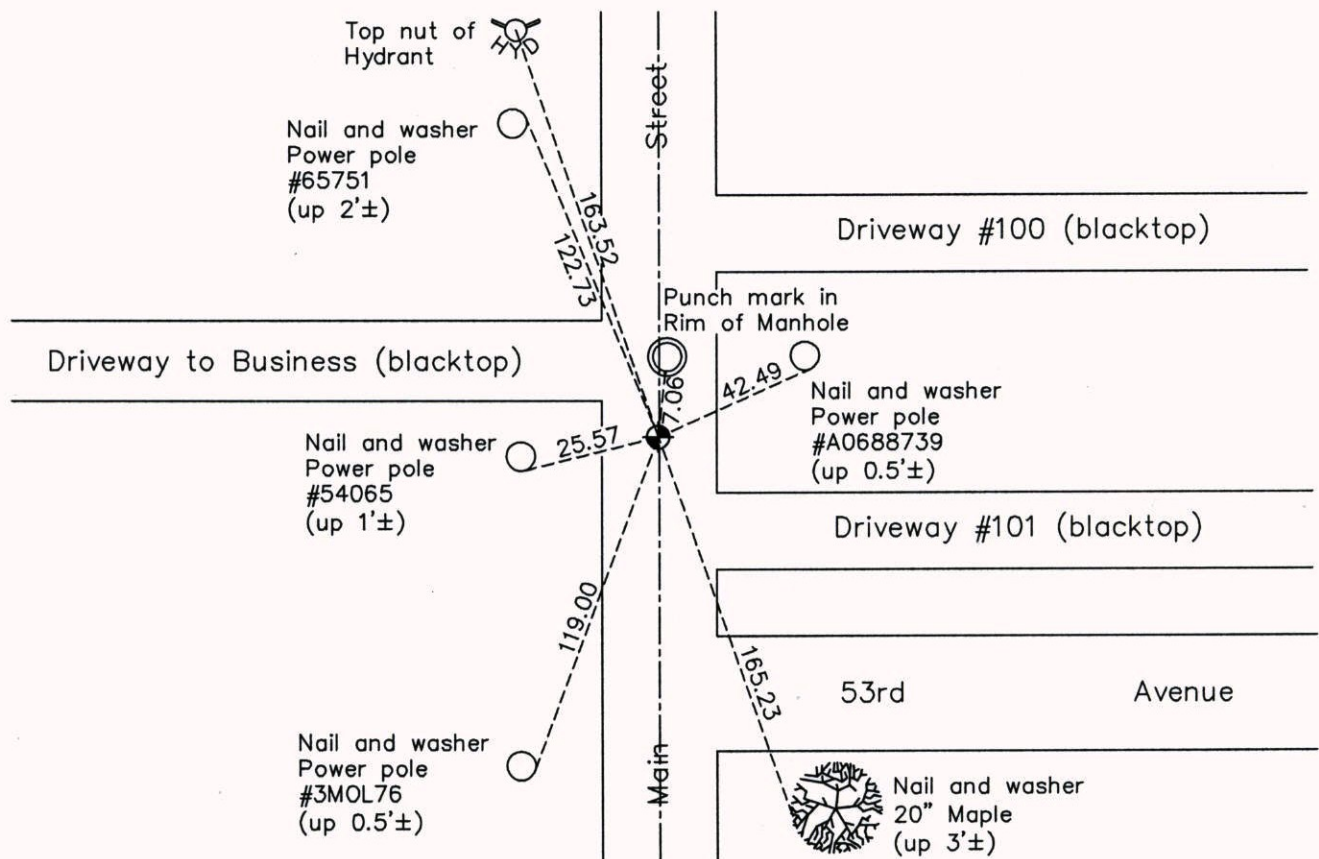

N.A.D. 1983 Coordinates
(1996 Adjustment)

County Project Coordinates

Northing 110644.3110

Easting 499649.1248

Date 8/18/03

Revision Date

3/30/15

I hereby certify that this United States public land survey monument record is correct and complete to the best of my knowledge and belief.

Larry D. Hoium Date 3/30/15

Larry D. Hoium, Anoka County Surveyor

Minnesota License Number 18165