

CERTIFICATE OF LOCATION OF GOVERNMENT CORNER

County of Anoka

State of Minnesota

North 1/4 Corner of Sec. 36 Township 32 Range 24

On the 15th day of February, 1968, the described corner was evidenced by a granite monument

and to perpetuate the location of said corner, at the exact location thereof, a permanent marker was placed consisting of the same granite monument with a sign and post on the north side

AND on the 7th day of December, 2010, said permanent marker was found leaning south and up 0.2'±. The ties were updated

Updated reference ties are as shown below.

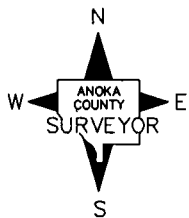
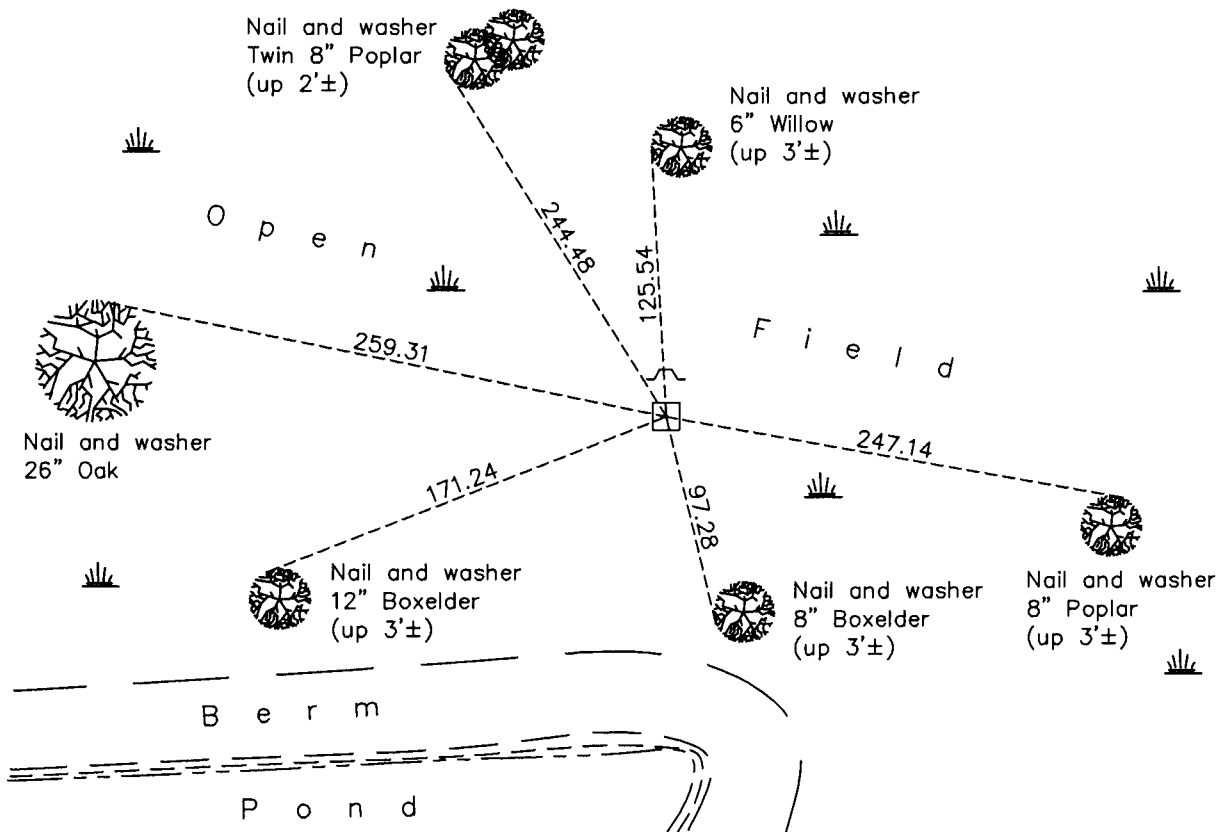

Revision Date

6/10/11

N.A.D. 1983 Coordinates
(1996 Adjustment)

County Project Coordinates	
Northing	169610.8210
Easting	497682.2009
Date	11/30/00

I hereby certify that this United States public land survey monument record is correct and complete to the best of my knowledge and belief.

Larry D. Hoium Date 6/10/11

Larry D. Hoium, Anoka County Surveyor

Minnesota License Number 18165

HISTORY OF GOVERNMENT CORNER

County of Anoka

State of Minnesota

North 1/4 Corner of Sec. 36 Township 32 Range 24

CORNER HISTORY:

February 15, 1968 - Found granite monument up 0.4'±. Established ties to monument.

July 23, 1968 - Found granite monument and updated ties.

July 10, 1972 - Found granite monument and updated ties.

June 9, 1976 - Found granite monument and updated ties.

June 13, 1979 - Found granite monument and updated ties.

June 30, 1982 - Found granite monument and updated ties.

August 31, 1988 - Reset disturbed granite monument and verified location using area resurvey. Set sign and post 1' north of monument and updated ties.

April 15, 1997 - Found granite monument with sign and post on north side and updated ties.

November 30, 2000 - Found granite monument and established NAD 1983 (1996 Adjustment) Anoka County Project Coordinates by Static GPS methods. Updated ties.

December 7, 2010 - Found granite monument leaning south and up 0.2'± with sign and post on north side. Updated ties.