

CERTIFICATE OF LOCATION OF GOVERNMENT CORNER

County of Anoka

State of Minnesota

South 1/4 Corner of Sec. 12 Township 30 Range 24

On the 12th day of September, 1960, the described corner was evidenced by a P.K. nail

and to perpetuate the location of said corner, at the exact location thereof, a permanent marker was placed consisting of a 1/2" iron pipe

AND on the 8th day of November, 2016, said permanent marker was found bent. Replaced with new 1/2" iron pipe using location of unbent part of found iron and the ties were updated

Updated reference ties are as shown below.

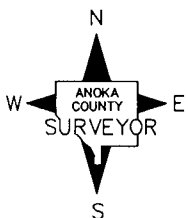
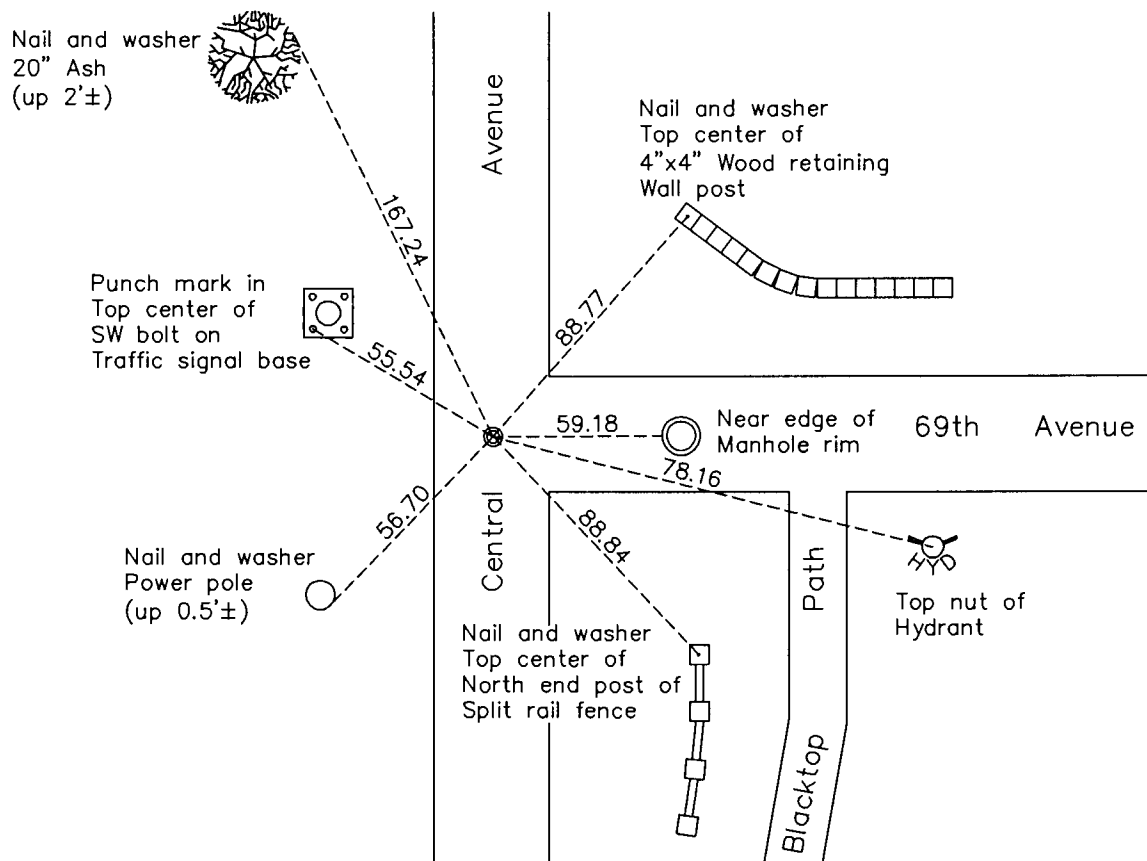

Revision Date
12/14/16

N.A.D. 1983 Coordinates
(1996 Adjustment)

| County Project Coordinates | |
|----------------------------|--------------------|
| Northing | <u>121148.8497</u> |
| Easting | <u>507420.8701</u> |
| Date | <u>7/22/03</u> |

I hereby certify that this United States public land survey monument record is correct and complete to the best of my knowledge and belief.

Larry D. Hoium Date 12/14/16

 Larry D. Hoium, Anoka County Surveyor
 Minnesota License Number 18165