

CERTIFICATE OF LOCATION OF GOVERNMENT CORNER

County of Anoka

State of Minnesota

East 1/4 Corner of Sec. 29 Township 33 Range 24

On the 19th day of September, 1963, the described corner was evidenced by a 1/2" iron pipe from N. C. Hoium

and to perpetuate the location of said corner, at the exact location thereof, a permanent marker was placed consisting of a cast iron monument

AND on the 16th day of November, 2016, said permanent marker was replaced with a cast iron monument after road construction and the ties were updated

Updated reference ties are as shown below.

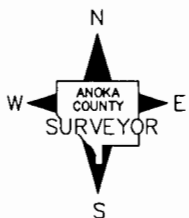
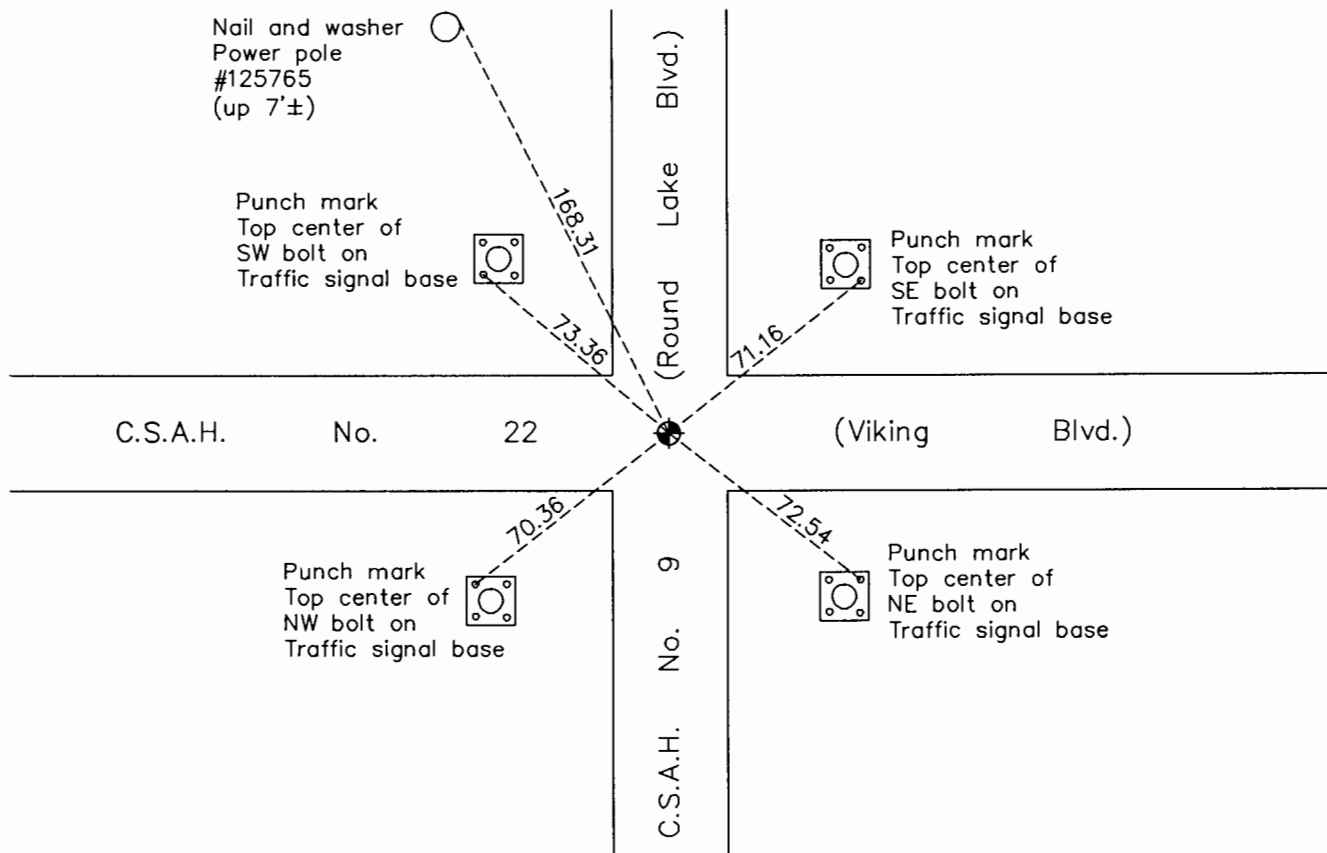

N.A.D. 1983 Coordinates
(1996 Adjustment)

County Project Coordinates	
Northing	203825.6232
Easting	479229.0176
Date	2/15/01

Revision Date
12/27/16

I hereby certify that this United States public land survey monument record is correct and complete to the best of my knowledge and belief.

Larry D. Hoium Date 12/27/16

Larry D. Hoium, Anoka County Surveyor

Minnesota License Number 18165