

*Line*

# CERTIFICATE OF LOCATION OF GOVERNMENT CORNER

County of Anoka

State of Minnesota

CENTER Corner of Sec. 15 Township 31 Range 22

I hereby certify that on the 15<sup>th</sup> day of OCT, 19 75, I found the described corner which was evidenced by 1 1/2" IRON PIPE

and I further certify that to perpetuate the location of said corner, I did, at the exact location thereof, place a permanent marker consisting of RED + WHITE IRON PIPE

which reference or witness monuments are located in the manner following:

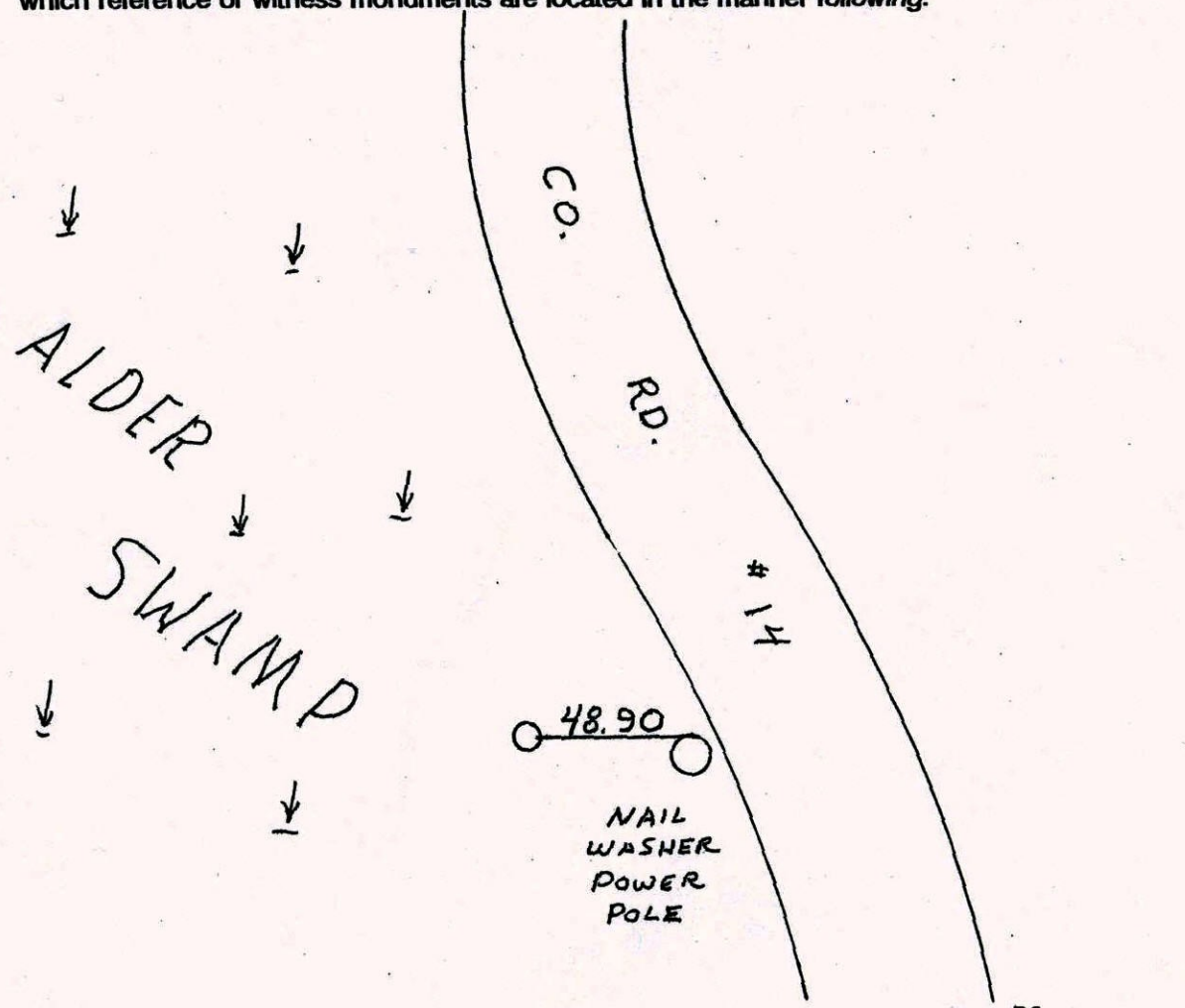

Revised date	Revised date	Revised date
10-15-75		
5-19-77		
8-1-80		
7-17-86		
6-28-91		
6-14-96		



61A

## CENTER OF SEC. 15, T31, R22

Found 1 1/2" Iron Pipe, Replaced it  
With Red & White Iron Pipe, Up 3'±

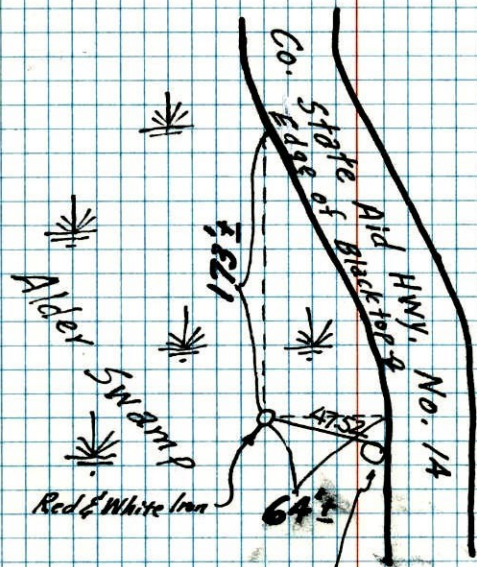

10-15-75  
H. Larson  
G. Boettcher  
R. Goetzko

nail & washer  
Power Pole #40

THE CHECK  
MAY 19, 1977  
BY SANNERUD  
V.P. DAHL  
STRIEN

## Center of Sec. 15 T31 R22

1975 61A

Found 1 1/2" Iron pipe. Replaced it with  
red & white iron pipe up 3'±

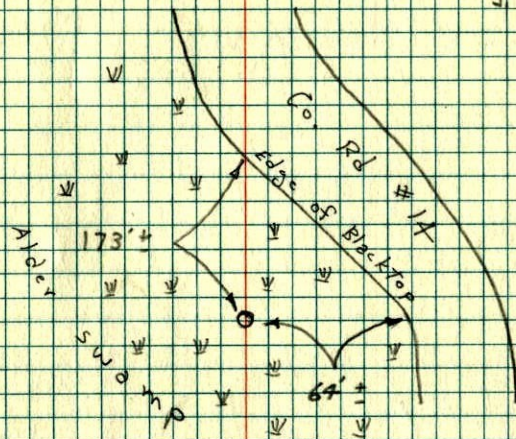

10-15-75  
H. Larson  
G. Boettcher  
J. Boettcher