

# CERTIFICATE OF LOCATION OF GOVERNMENT CORNER

County of Anoka

State of Minnesota

## South 1/4 Corner of Sec. 1 Township 31 Range 22

On the 18th day of October, 1973, the described corner was evidenced by area resurvey

and to perpetuate the location of said corner, at the exact location thereof, a permanent marker was placed consisting of a cast iron monument

AND on the 23rd day of September, 2016, said permanent marker was found flush with the surface on centerline and the ties were updated

Updated reference ties are as shown below.

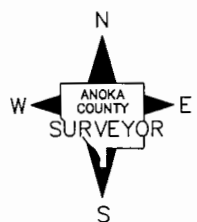
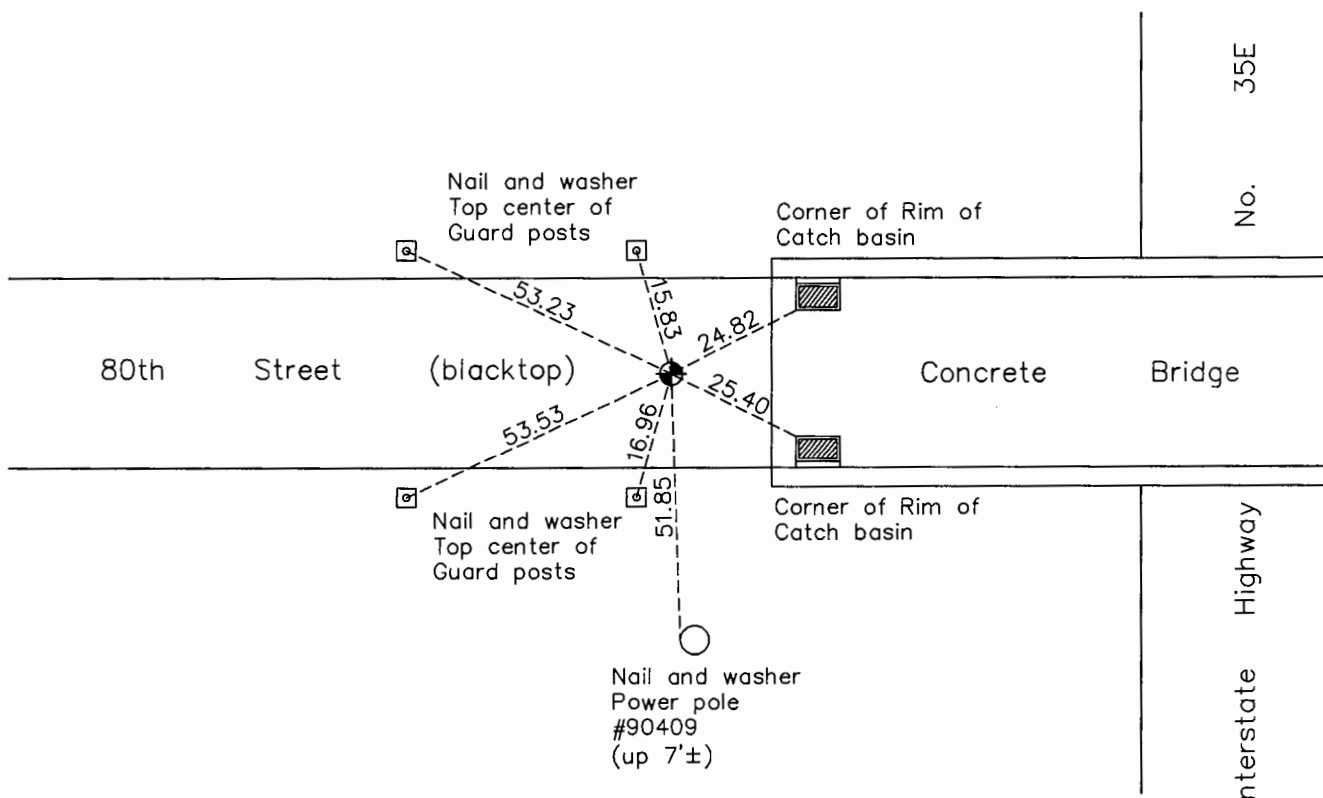

N.A.D. 1983 Coordinates  
(1996 Adjustment)

County Project Coordinates	
Northing	<u>158860.8346</u>
Easting	<u>560900.5089</u>
Date	<u>2/03/98</u>

Revision Date  
1/20/17

I hereby certify that this United States public land survey monument record is correct and complete to the best of my knowledge and belief.

*Larry D. Hoium* Date 6/28/17

Larry D. Hoium, Anoka County Surveyor  
Minnesota License Number 18165

# HISTORY OF GOVERNMENT CORNER

Page No. 23

County of Anoka

State of Minnesota

South 1/4 Corner of Sec. 1 Township 31 Range 22

## **CORNER HISTORY:**

May 11, 1961- Corner could not be located based on Hoium ties.

August 7, 1964- Corner could not be located based on Hoium ties.

October 18, 1973 - Set Cast Iron monument flush with surface using area resurvey. Established ties to monument.

August 18, 1976 - Found Cast Iron monument and updated ties.

July 25, 1980 - Found Cast Iron monument and updated ties.

July 7, 1986 - Found Cast Iron monument and updated ties.

April 11, 1989 - Set construction ties and removed Cast Iron monument prior to road construction.

July 31, 1989 - Found Cast Iron monument (date set is unknown) and updated ties.

August 30, 1991 - Found Cast Iron monument and updated ties.

June 20, 1996 - Found Cast Iron monument and updated ties.

February 3, 1998 - Found Cast Iron monument and established NAD 1983 (1996 Adjustment) Anoka County Project Coordinates by Static GPS methods. Updated ties.

July 2010 - Found Cast Iron monument flush with the surface and updated ties.

September 23, 2016 - Found Cast Iron monument flush with the surface on center line. Verified location of corner by VRS GPS methods. Updated ties.