

CERTIFICATE OF LOCATION OF GOVERNMENT CORNER

County of Anoka

State of Minnesota

East 1/4 Corner of Sec. 8 Township 31 Range 22

On the 15th day of March, 1962, the described corner was evidenced by a 1-1/2" iron pipe

and to perpetuate the location of said corner, at the exact location thereof, a permanent marker was placed consisting of a cast iron monument

AND on the 22nd day of September, 2016, said permanent marker was found and the ties were updated

Updated reference ties are as shown below.

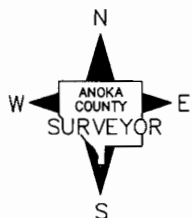
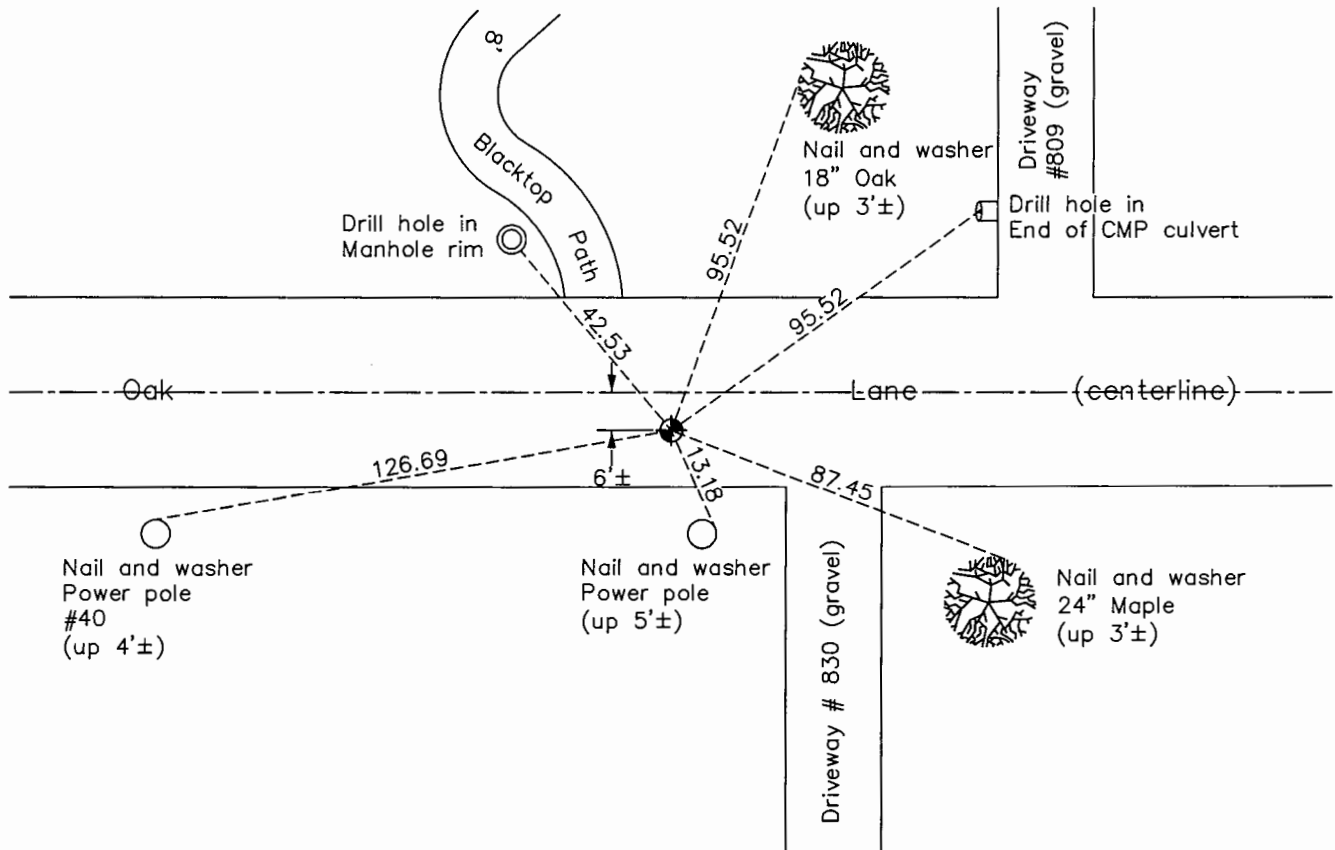

Revision Date
1/21/17

N.A.D. 1983 Coordinates
(1996 Adjustment)

County Project Coordinates	
Northing	<u>156222.3391</u>
Easting	<u>542443.7135</u>
Date	<u>2/13/98</u>

I hereby certify that this United States public land survey monument record is correct and complete to the best of my knowledge and belief.

Larry D. Hoium Date 6/28/17

Larry D. Hoium, Anoka County Surveyor

Minnesota License Number 18165

HISTORY OF GOVERNMENT CORNER

Page No. 37

County of Anoka

State of Minnesota

East 1/4 Corner of Sec. 8 Township 31 Range 22

CORNER HISTORY:

June 8, 1949 - Jackson found 1.5" Iron Pipe. Established ties to monument.

March 15, 1962 - Replaced bent 1.5" Iron Pipe with Cast Iron Monument down 0.5'± and updated ties.

July 9, 1965 - Found Cast Iron Monument and updated ties.

June 26, 1967 - Replaced Cast Iron Monument down 0.6'± and updated ties.

August 18, 1969 - Found Cast Iron Monument down 0.6'± and 6'± south of centerline. Updated ties.

June 19, 1973 - Found Cast Iron Monument and updated ties.

September, 1977 - Found Cast Iron Monument 6'± south of centerline of Oak Lane and updated ties.

August 7, 1980 - Found Cast Iron Monument and updated ties.

December 24, 1990 - Found Cast Iron Monument 6'± south of centerline and updated ties.

May 26, 1992 - Raised Cast Iron Monument and updated ties.

June 25, 1996 - Found Cast Iron Monument and updated ties.

February 13, 1998 - Found Cast Iron Monument and established NAD 1983 (1996 Adjustment) Anoka County Project Coordinates by Static GPS methods. Updated ties.

June 16, 2010 - Found Cast Iron Monument and updated ties.

September 22, 2016 - Found Cast Iron Monument and updated ties. Verified location of corner by VRS GPS methods.