

CERTIFICATE OF LOCATION OF GOVERNMENT CORNER

County of Anoka

State of Minnesota

Northeast Corner of Sec. 27 Township 31 Range 22

On the 24th day of April, 1969, the described corner was evidenced by a 2" iron pipe

and to perpetuate the location of said corner, at the exact location thereof, a permanent marker was placed consisting of a cast iron monument

AND on the 20th day of December, 2016, said permanent marker was found broken and was replaced with a new cast iron monument and the ties were updated. Set P.K. nails to N,S,E & W

Updated reference ties are as shown below.

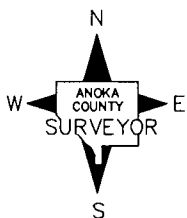
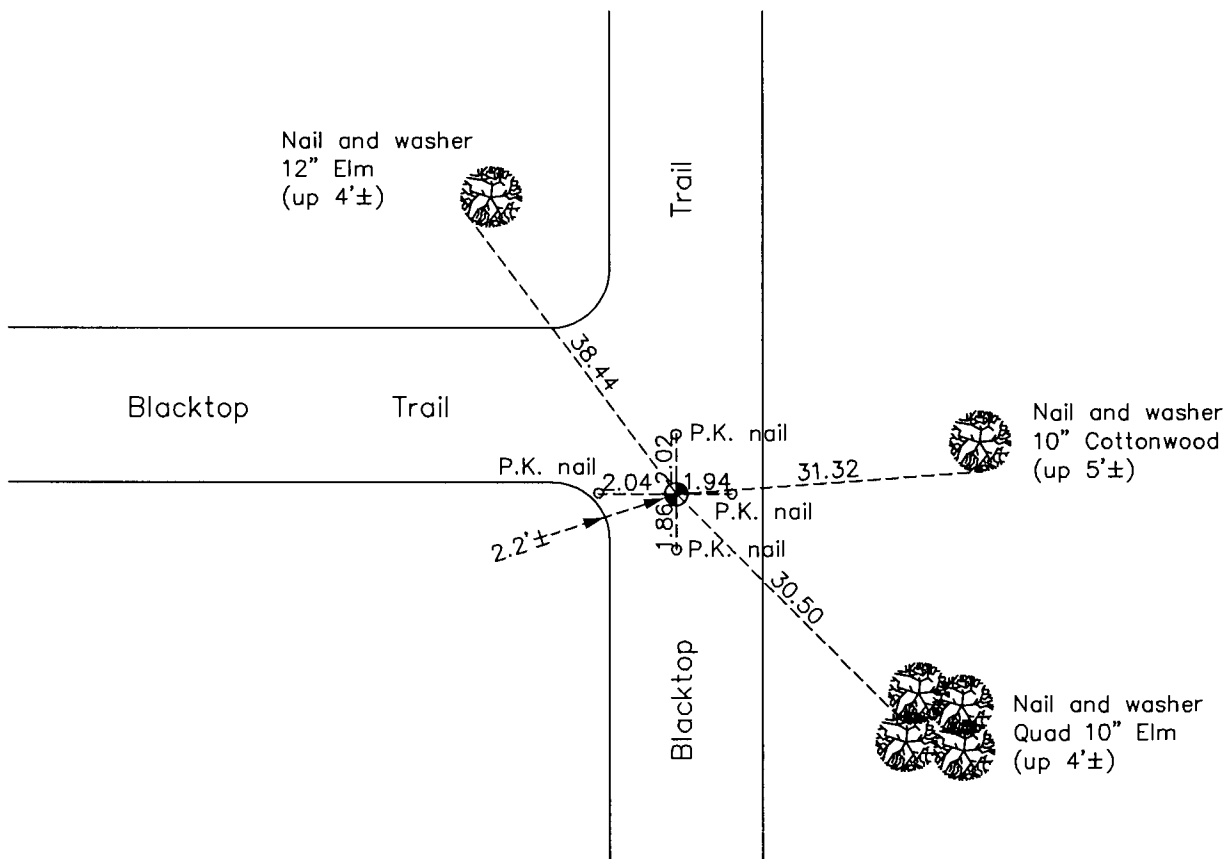

Revision Date
12/22/16

N.A.D. 1983 Coordinates
(1996 Adjustment)

County Project Coordinates	
Northing	143042.0323
Easting	553006.4090
Date	3/05/98

I hereby certify that this United States public land survey monument record is correct and complete to the best of my knowledge and belief.

Larry D. Hoium Date 12/22/16

Larry D. Hoium, Anoka County Surveyor

Minnesota License Number 18165