

# CERTIFICATE OF LOCATION OF GOVERNMENT CORNER

County of Anoka

State of Minnesota

Witness Corner of Sec. 29 Township 31 Range 22  
 (on north line of NE 1/4)

On the 24th day of December, 1968, the described corner was evidenced by area resurvey

and to perpetuate the location of said corner, at the exact location thereof, a permanent marker was placed consisting of a cast iron monument with a sign and post on the north side

AND on the 25th day of August, 2010, said permanent marker was found down 0.5'± and the ties were updated

Updated reference ties are as shown below.

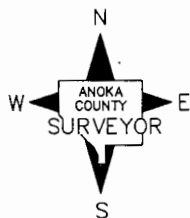
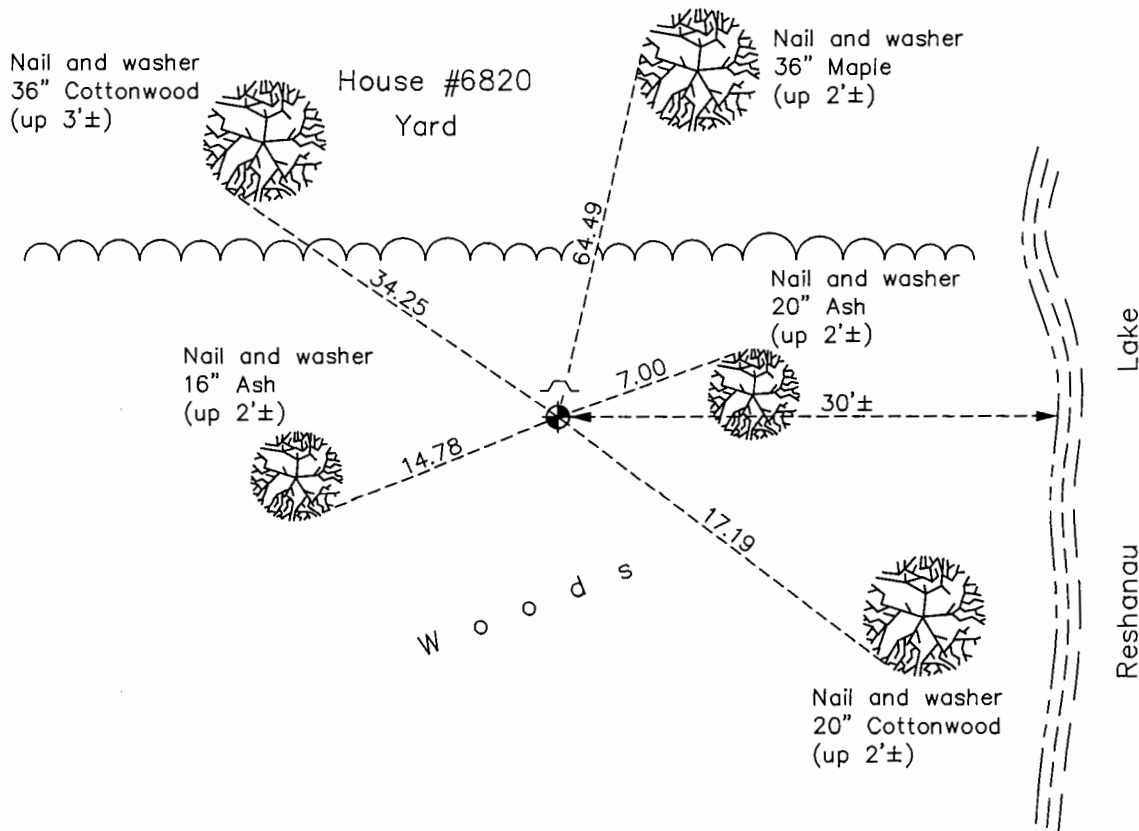

Revision Date  
2/1/17

N.A.D. 1983 Coordinates  
 (1996 Adjustment)

County Project Coordinates	
Northing	<u>143004.6066</u>
Easting	<u>541864.4227</u>
Date	<u>3/17/98</u>

I hereby certify that this United States public land survey monument record is correct and complete to the best of my knowledge and belief.

*Larry D. Hoium* Date 6/28/17

Larry D. Hoium, Anoka County Surveyor  
 Minnesota License Number 18165

# HISTORY OF GOVERNMENT CORNER

Page No. 103

County of Anoka

State of Minnesota

Witness Corner of Sec. 29 Township 31 Range 22  
(on north line of NE 1/4)

## **CORNER HISTORY:**

March 25, 1968 - Set Cast Iron Monument flush with the surface on west side of Reshanau Lake using area resurvey. Established ties to monument.

December 24, 1968 - Reset Cast Iron Monument flush with the surface and 627.90' west of NE corner of Section 29. Updated ties.

June 27, 1973 - Found Cast Iron Monument and updated ties.

May 25, 1977 - Found Cast Iron Monument and updated ties.

August 8, 1980 - Found Cast Iron Monument and updated ties.

May 25, 1977 - Found Cast Iron Monument and updated ties.

June 9, 1983 - Found Cast Iron Monument and updated ties.

July 28, 1986 - Found Cast Iron Monument and updated ties.

September 22, 1989 - Found Cast Iron Monument and set sign and post on north side. Updated ties.

October 25, 1991 - Found Cast Iron Monument and updated ties.

June 26, 1996 - Found Cast Iron Monument and updated ties.

March 17, 1998 - Found Cast Iron Monument and established NAD 1983 (1996 Adjustment) Anoka County Project Coordinates by Static GPS methods. Updated ties.

August 25, 2010 - Found Cast Iron Monument down 0.5'± with a sign and post on the north side and updated ties.

November 17, 2016 - Found Cast Iron Monument down 0.5'± with a sign and post on the north side and updated ties.