

# CERTIFICATE OF LOCATION OF GOVERNMENT CORNER

County of Anoka

State of Minnesota

## Southwest Corner of Sec. 28 Township 31 Range 22

On the 16th day of March, 1964, the described corner was evidenced by a 1/2" iron pipe

and to perpetuate the location of said corner, at the exact location thereof, a permanent marker was placed consisting of a cast iron monument with a sign and post on the north side

AND on the 15th day of December, 2016, said permanent marker was found up 0.2'± and the ties were updated

Updated reference ties are as shown below.

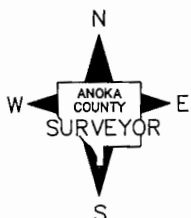
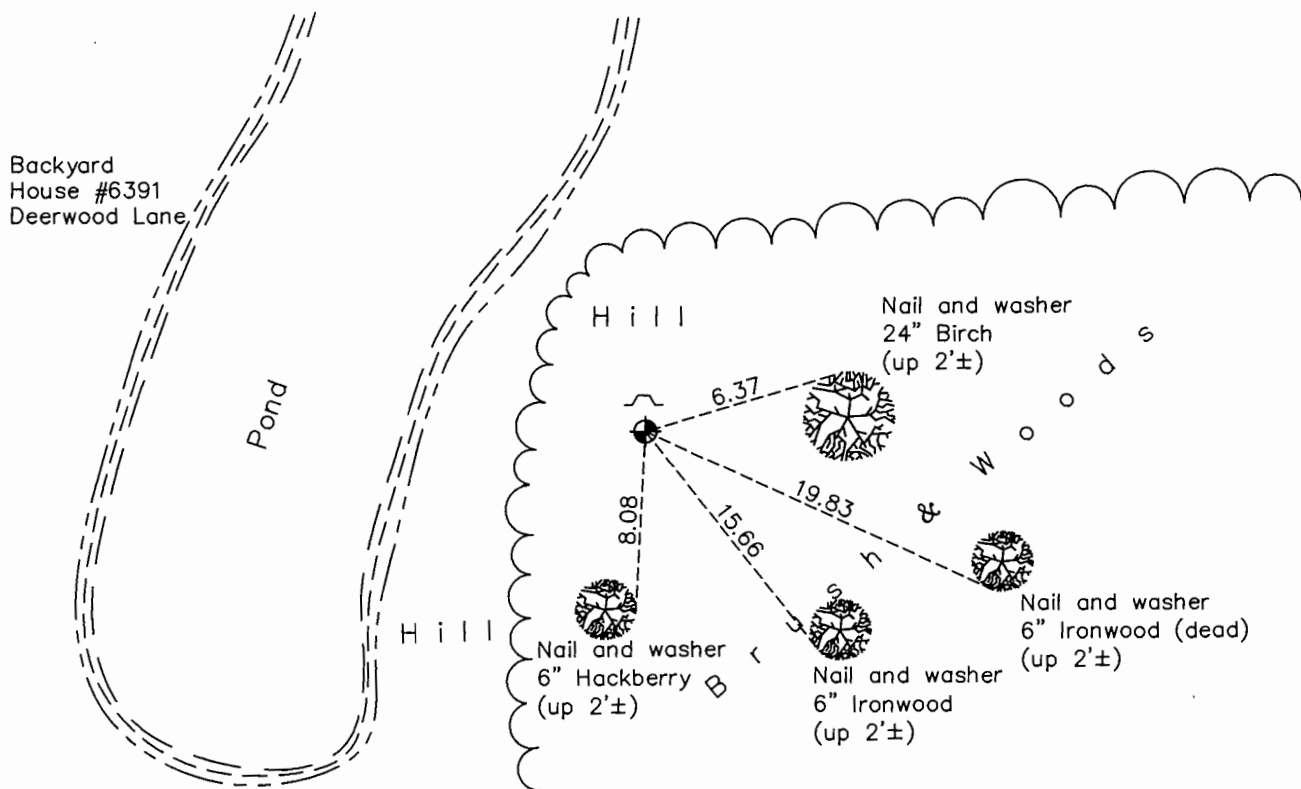

Revision Date

2/7/17

N.A.D. 1983 Coordinates  
(1996 Adjustment)

County Project Coordinates

Northing 137715.3173

Easting 542530.0562

Date 4/08/98

I hereby certify that this United States public land survey monument record is correct and complete to the best of my knowledge and belief.

*Larry D. Hoium* Date 6/28/17

Larry D. Hoium, Anoka County Surveyor

Minnesota License Number 18165

# HISTORY OF GOVERNMENT CORNER

Page No. 124

County of Anoka

State of Minnesota

## Southwest Corner of Sec. 28 Township 31 Range 22

### **CORNER HISTORY:**

March 16, 1964 - Found 1/2" Iron Pipe and established ties to pipe.

September 5, 1969 - Replaced Iron Pipe with a Cast Iron Monument set up 0.2'± and updated ties.

July 5, 1973 - Found Cast Iron Monument and updated ties.

June 3, 1977 - Found Cast Iron Monument and updated ties.

August 13, 1980 - Found Cast Iron Monument and updated ties.

July 17, 1986 - Found Cast Iron Monument and updated ties.

September 21, 1989 - Found Cast Iron Monument and updated ties.

October 25, 1991 - Found Cast Iron Monument and updated ties. Set sign and post on north side of monument.

July 8, 1996 - Found Cast Iron Monument and updated ties.

April 8, 1998 - Found Cast Iron Monument and established NAD 1983 (1996 Adjustment) Anoka County Project Coordinates by Static GPS methods. Updated ties.

September 20, 2010 - Found Cast Iron Monument up 0.2'± with a sign and post on the north side. Updated ties.

December 15, 2016 - Found Cast Iron Monument up 0.2'± with a sign and post on the north side. Updated ties.