

CERTIFICATE OF LOCATION OF GOVERNMENT CORNER

County of Anoka

State of Minnesota

East 1/4 Corner of Sec. 1 Township 32 Range 25

On the 2nd day of October, 1978, the described corner was evidenced by area resurvey

and to perpetuate the location of said corner, at the exact location thereof, a permanent marker was placed consisting of a 1/2" iron pipe in concrete apron with blacktop overlay

AND on the 27th day of July, 2015, said permanent marker was found on centerline and the ties were updated

Updated reference ties are as shown below.

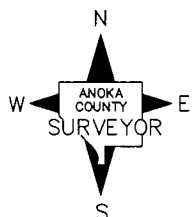
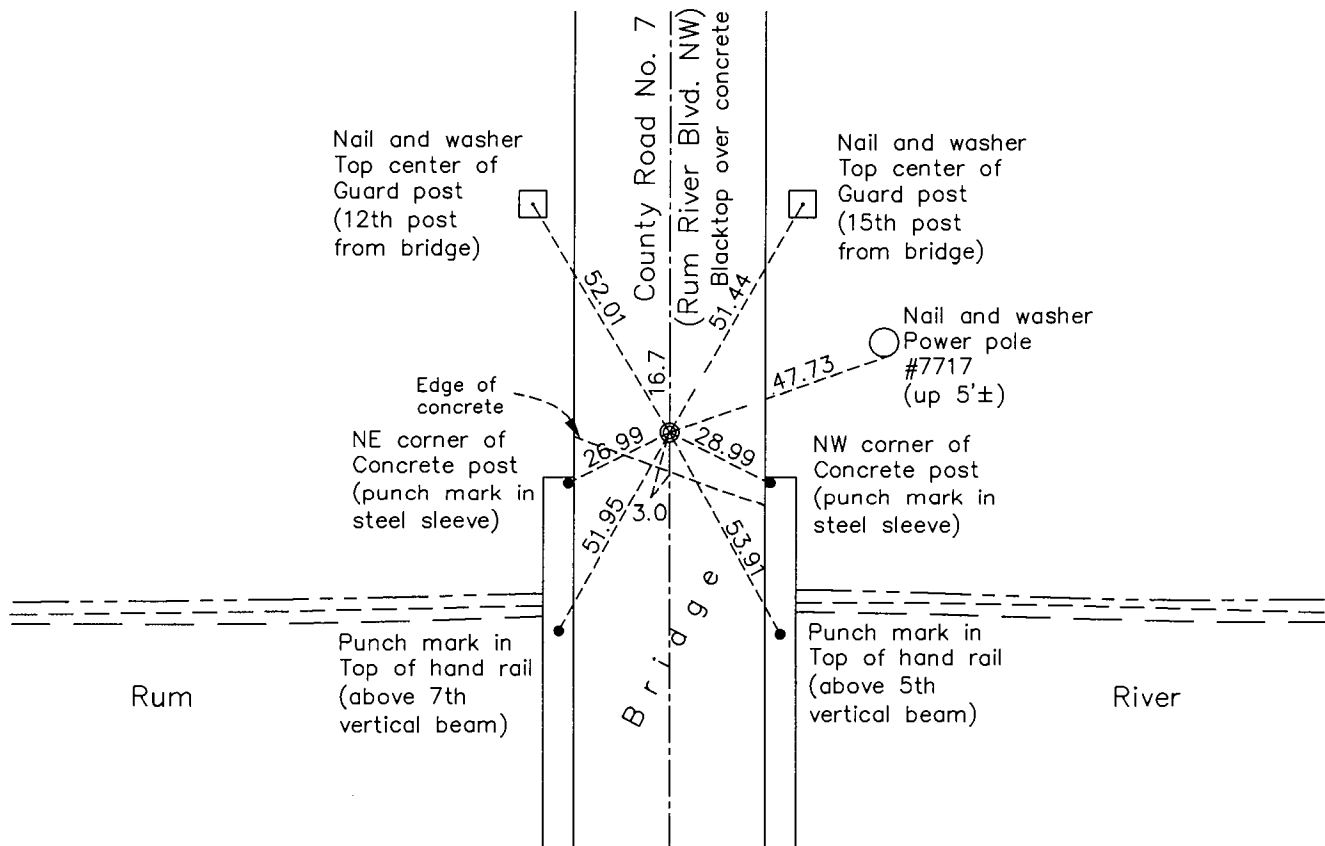

Revision Date
7/18/16

N.A.D. 1983 Coordinates
(1996 Adjustment)

County Project Coordinates	
Northing	<u>193518.4714</u>
Easting	<u>468639.1615</u>
Date	<u>1/04/00</u>

I hereby certify that this United States public land survey monument record is correct and complete to the best of my knowledge and belief.

Larry D. Hoium Date 8/25/16

Larry D. Hoium, Anoka County Surveyor

Minnesota License Number 18165

HISTORY OF GOVERNMENT CORNER

County of Anoka

State of Minnesota

East 1/4 Corner of Sec. 1 Township 32 Range 25

CORNER HISTORY:

December 15, 1965 - Set P.K. nail using area resurvey and established ties to monument. Set P.K. nails 2.00' north and east of corner location.

May 27, 1966 - Replaced P.K. nail with a cast iron monument and updated ties.

June 9, 1969 - Found cast iron monument and updated ties.

August 21, 1972 - Found cast iron monument and updated ties.

June 22, 1977 - Replaced cast iron monument with a P.K. nail during road construction and updated ties.

October 2, 1978 - Replaced P.K. nail with a cast iron monument set flush with the surface and on centerline of road after road construction. Set P.K. nails 2.00' north and east of monument and updated ties.

June 15, 1979 - Found cast iron monument and updated ties.

August 18, 1982 - Found cast iron monument and updated ties.

July 3, 1984 - Raised cast iron monument and updated ties.

July 23, 1985 - Found cast iron monument and updated ties.

July 13, 1988 - Found cast iron monument and updated ties.

August 6, 1989 - Found cast iron monument and updated ties.

August 30, 1990 - Found cast iron monument and updated ties.

August 9, 1993 - Found cast iron monument and updated ties.

September 8, 1994 - Found cast iron monument and updated ties.

June 24, 1998 - Set construction ties and removed cast iron monument prior to road construction.

November 2, 1998 - Set 1/2" iron pipe in concrete bridge apron after road construction using construction ties and updated ties.

January 4, 2000 - Found 1/2" iron pipe in concrete apron and established NAD 1983 (1996 Adjustment) Anoka County Project Coordinates by Static GPS methods. Updated ties.

May 14, 2010 - Found 1/2" iron pipe in concrete apron on centerline and updated ties.

July 27, 2015 - Found 1/2" iron pipe in concrete apron under blacktop overlay and on centerline. Verified location of corner by VRS GPS methods and updated ties.