

CERTIFICATE OF LOCATION OF GOVERNMENT CORNER

County of Anoka

State of Minnesota

Southwest Corner of Sec. 1 Township 32 Range 25

On the 12th day of August, 1960, the described corner was evidenced by a concrete monument

and to perpetuate the location of said corner, at the exact location thereof, a permanent marker was placed consisting of a cast iron monument

AND on the 18th day of September, 2015, said permanent marker was found flush and the ties were updated

Updated reference ties are as shown below.

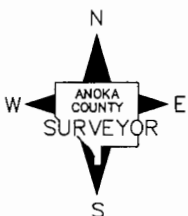
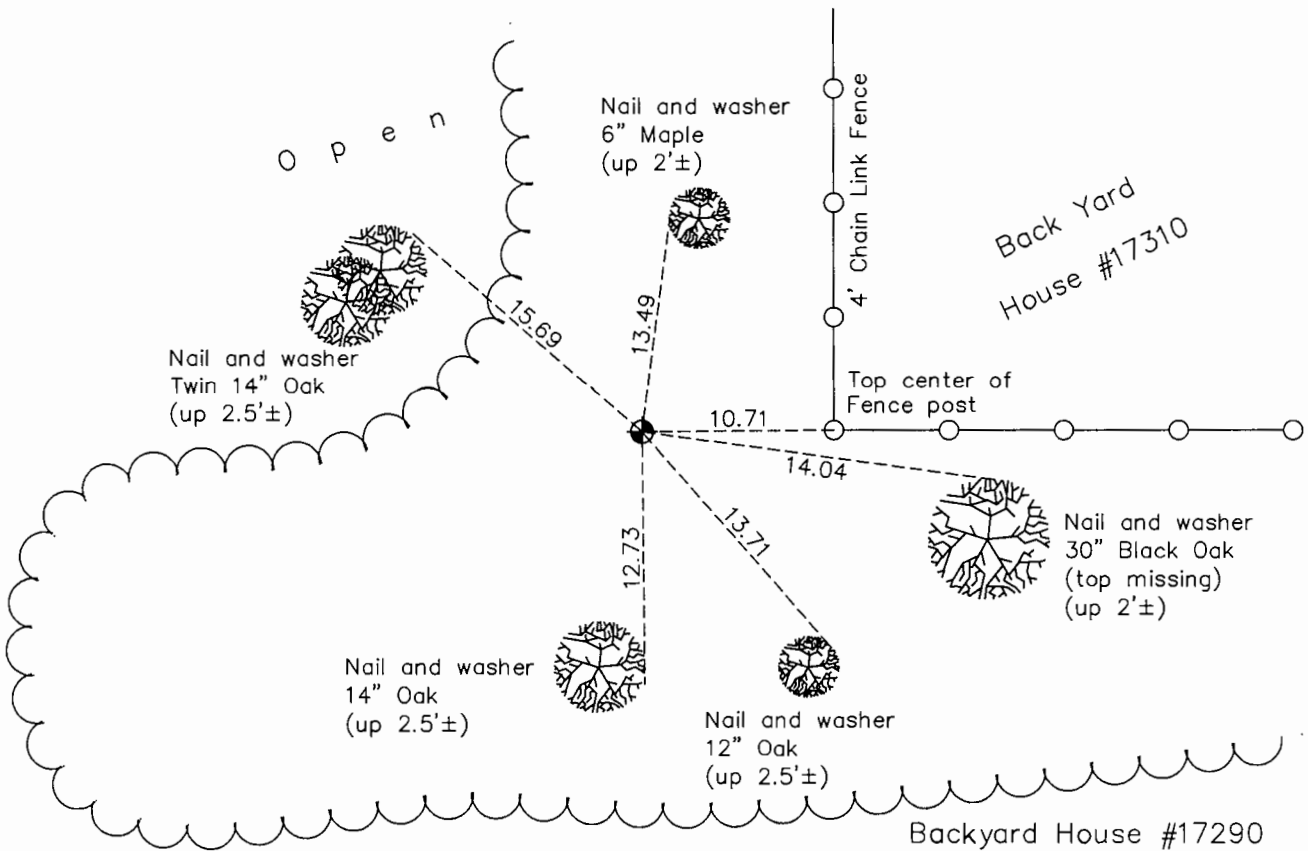

Revision Date
7/19/16

N.A.D. 1983 Coordinates
(1996 Adjustment)

County Project Coordinates	
Northing	190952.9907
Easting	463395.3506
Date	2/15/00

I hereby certify that this United States public land survey monument record is correct and complete to the best of my knowledge and belief.

Larry D. Hoium Date 8/25/16

Larry D. Hoium, Anoka County Surveyor
Minnesota License Number 18165

HISTORY OF GOVERNMENT CORNER

County of Anoka

State of Minnesota

Southwest Corner of Sec. 1 Township 32 Range 25

CORNER HISTORY:

August 8, 1945 - Cartwright found concrete monument and established ties to monument.

August 12, 1960 - Found concrete monument down 4" with an iron pipe on the north side and updated ties.

August 11, 1964 - Found concrete monument with an iron pipe on the north side and updated ties.

June 10, 1969 - Found concrete monument with an iron pipe on the north side and updated ties.

August 21, 1972 - Found concrete monument with an iron pipe on the north side and updated ties.

June 23, 1976 - Replaced concrete monument with a cast iron monument set flush with the surface. Updated ties.

June 18, 1979 - Found cast iron monument and updated ties.

August 20, 1982 - Found cast iron monument and updated ties.

November 8, 1983 - Found cast iron monument and updated ties.

July 23, 1985 - Found cast iron monument and updated ties.

June 14, 1988 - Found cast iron monument and updated ties.

August 13, 1993 - Found cast iron monument and updated ties.

February 15, 2000 - Found cast iron monument and established NAD 1983 (1996 Adjustment) Anoka County Project Coordinates by Static GPS methods. Updated ties.

May 6, 2010 - Found cast iron monument flush with the surface and updated ties.

September 18, 2015 - Found cast iron monument flush with the surface and updated ties.