

CERTIFICATE OF LOCATION OF GOVERNMENT CORNER

County of Anoka

State of Minnesota

South 1/4 Corner of Sec. 6 Township 32 Range 25

On the 7th day of November, 1968, the described corner was evidenced by area resurvey

and to perpetuate the location of said corner, at the exact location thereof, a permanent marker was placed consisting of a cast iron monument

AND on the 17th day of July, 2015, said permanent marker was found flush and the ties were updated

Updated reference ties are as shown below.

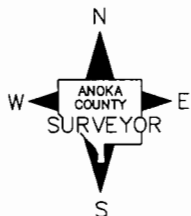
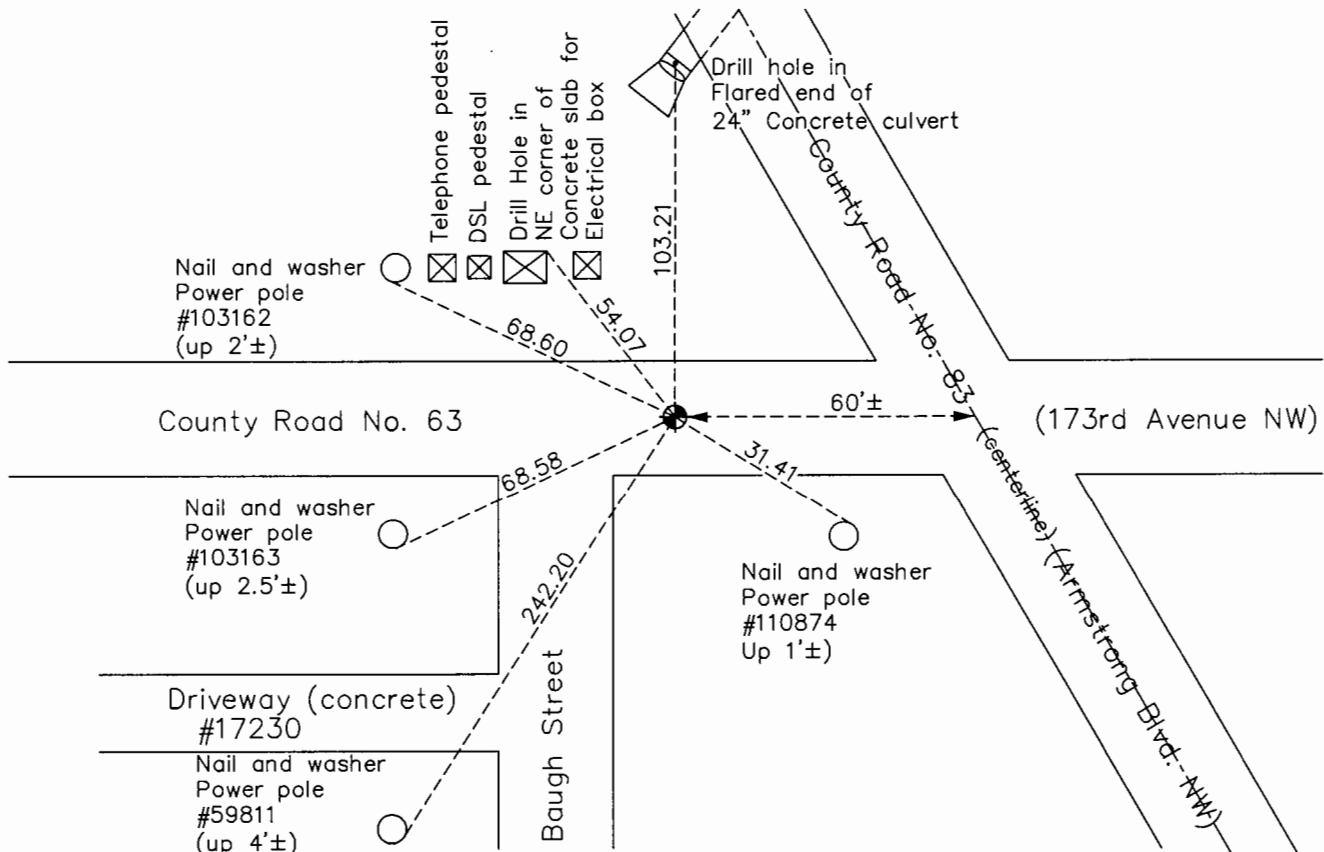

N.A.D. 1983 Coordinates
(1996 Adjustment)

County Project Coordinates	
Northing	191084.3224
Easting	439739.5848
Date	9/01/99

I hereby certify that this United States public land survey monument record is correct and complete to the best of my knowledge and belief.

Larry D. Hoium Date 8/25/16

Larry D. Hoium, Anoka County Surveyor

Minnesota License Number 18165

Revision Date
7/25/16

HISTORY OF GOVERNMENT CORNER

County of Anoka

State of Minnesota

South 1/4 Corner of Sec. 6 Township 32 Range 25

CORNER HISTORY:

November 7, 1968 - Set cast iron monument down 0.2'± using area resurvey and established ties to monument. Monument is on intersection of centerlines extended south and west.

June 11, 1969 - Found cast iron monument and updated ties.

July 17, 1972 - Found cast iron monument and updated ties.

June 22, 1976 - Found cast iron monument and updated ties.

June 18, 1979 - Found cast iron monument and updated ties.

August 19, 1982 - Found cast iron monument and updated ties.

May 1, 1990 - Set construction ties prior to road construction.

August 29, 1990 - Found cast iron monument and updated ties after road construction.

August 6, 1993 - Found cast iron monument and updated ties.

September 1, 1999 - Found cast iron monument and established NAD 1983 (1996 Adjustment) Anoka County Project Coordinates by Static GPS methods. Updated ties.

April 13, 2010 - Found cast iron monument flush with the surface and updated ties.

July 17, 2015 - Found cast iron monument and updated ties. Verified location of corner by VRS GPS methods.