

# CERTIFICATE OF LOCATION OF GOVERNMENT CORNER

County of Anoka

State of Minnesota

## West 1/4 Corner of Sec. 12 Township 32 Range 25

On the 8th day of May, 1967, the described corner was evidenced by area resurvey

and to perpetuate the location of said corner, at the exact location thereof, a permanent marker was placed consisting of a cast iron monument

AND on the 12th day of August, 2015, said permanent marker was found down 0.10'± and the ties were updated

Updated reference ties are as shown below.

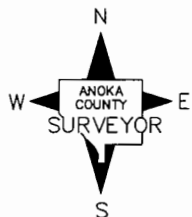
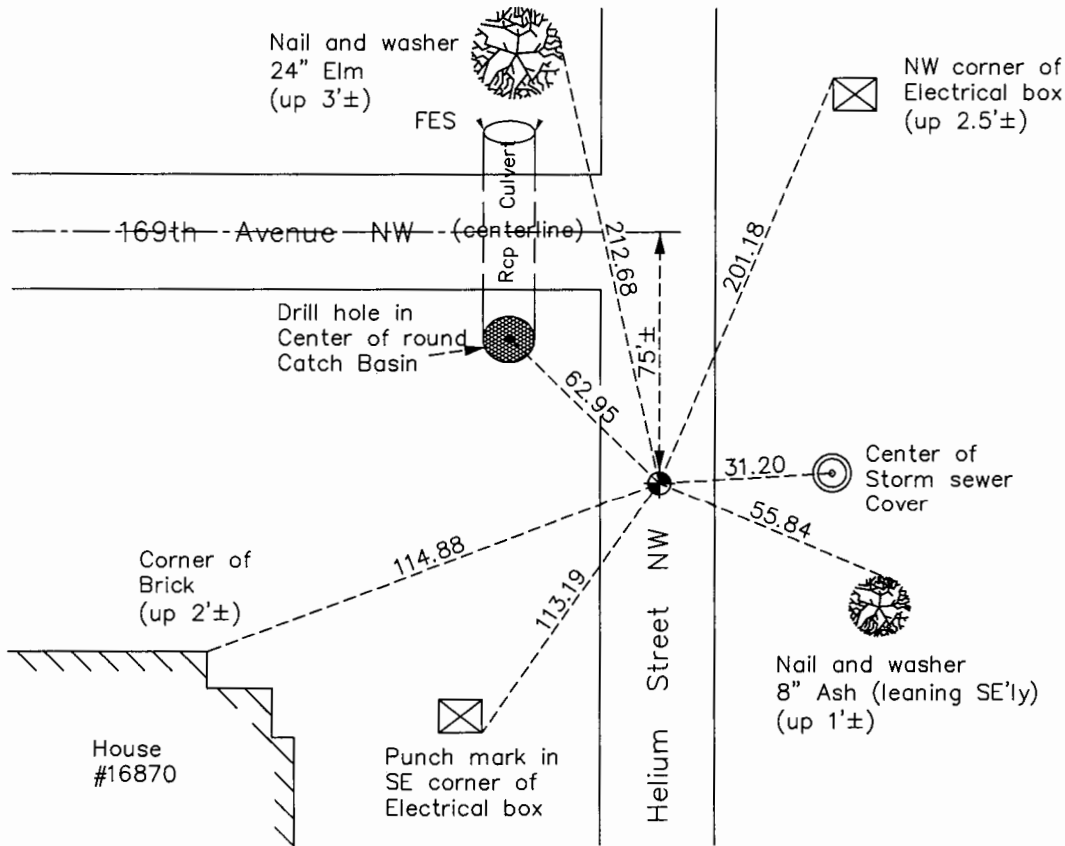

Revision Date  
7/26/16

N.A.D. 1983 Coordinates  
(1996 Adjustment)

County Project Coordinates	
Northing	188313.2849
Easting	463386.2197
Date	12/29/99

I hereby certify that this United States public land survey monument record is correct and complete to the best of my knowledge and belief.

*Larry D. Hoium* Date 8/25/16

Larry D. Hoium, Anoka County Surveyor

Minnesota License Number 18165

# HISTORY OF GOVERNMENT CORNER

County of Anoka

State of Minnesota

## West 1/4 Corner of Sec. 12 Township 32 Range 25

### **CORNER HISTORY:**

**August 8, 1945** - Cartwright found concrete monument. Established ties to monument.

October 2, 1963 - Found concrete monument missing.

May 8, 1967 - Set cast iron monument flush with the surface and 1.5'± east of north-south fence line using area resurvey and established ties to monument.

June 10, 1969 - Found cast iron monument and updated ties.

August 2, 1972 - Found cast iron monument and updated ties.

March 30, 1976 - Found cast iron monument leaning with one tie remaining. Reset cast iron monument using remaining tie and distance to NW corner of Section 12. Updated ties.

June 29, 1976 - Set construction ties and removed cast iron monument prior to road construction. Replaced cast iron monument with iron pipe.

June 18, 1979 - Found iron pipe and updated ties.

July 9, 1980 - Set cast iron monument flush with surface after road construction using construction ties. Set P.K. nails 2.00' north and east of monument.

August 18, 1982 - Found cast iron monument and updated ties.

August 13, 1993 - Found cast iron monument and updated ties.

December 29, 1999 - Found cast iron monument and established NAD 1983 (1996 Adjustment) Anoka County Project Coordinates by Static GPS methods. Updated ties.

August 12, 2004 - Found cast iron monument and updated ties.

September 7, 2005 - Found cast iron monument and updated ties.

April 15, 2010 - Found cast iron monument flush with the surface and updated ties.

August 12, 2015 - Found cast iron monument down 0.1'± and updated ties.