

# CERTIFICATE OF LOCATION OF GOVERNMENT CORNER

County of Anoka

State of Minnesota

Witness Corner of Sec. 12 Township 32 Range 25

(On south line of section)

On the 9th day of May, 1967, the described corner was evidenced by area resurvey

and to perpetuate the location of said corner, at the exact location thereof, a permanent marker was placed consisting of a cast iron monument

AND on the 12th day of August, 2015, said permanent marker was found down 0.3' and the ties were updated

Updated reference ties are as shown below.

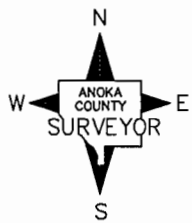
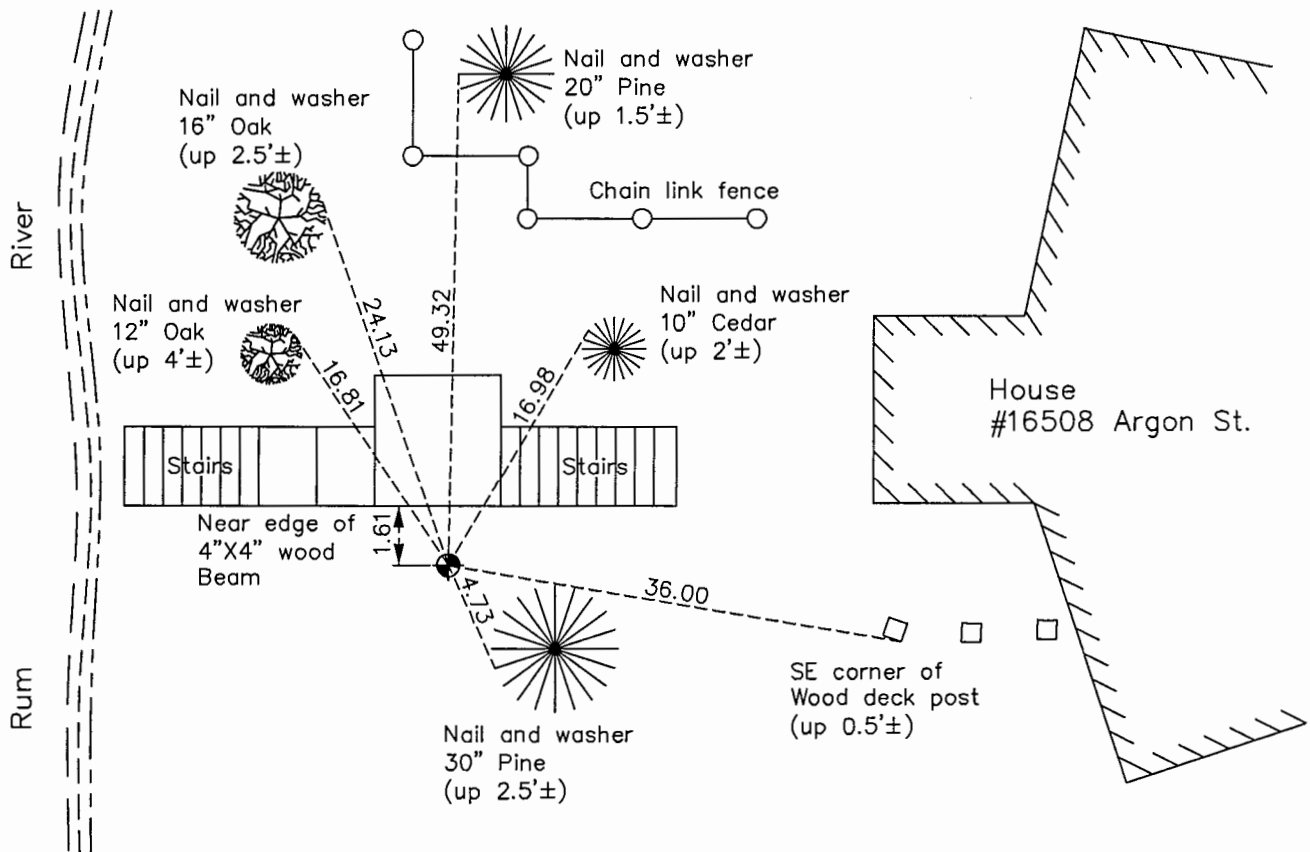

N.A.D. 1983 Coordinates  
(1996 Adjustment)

County Project Coordinates	
Northing	185665.1263
Easting	465428.9365
Date	3/29/00

I hereby certify that this United States public land survey monument record is correct and complete to the best of my knowledge and belief.

*Larry D. Hoium* Date 8/25/16

Larry D. Hoium, Anoka County Surveyor

Minnesota License Number 18165

Revision Date  
7/26/16

# HISTORY OF GOVERNMENT CORNER

County of Anoka

State of Minnesota

Witness Corner of Sec. 12 Township 32 Range 25  
(On south line of section)

**CORNER HISTORY:**

**May 9, 1967** - Set cast iron monument on east side of Rum River using area resurvey and established ties to monument.

June 18, 1969 - Found cast iron monument and updated ties.

June 25, 1976 - Found cast iron monument and updated ties.

August 16, 1978 - Found cast iron monument and updated ties.

June 18, 1979 - Found cast iron monument and updated ties.

August 18, 1982 - Found cast iron monument and updated ties.

July 23, 1985 - Found cast iron monument and updated ties.

July 14, 1988 - Found cast iron monument and updated ties.

August 20, 1993 - Found cast iron monument and updated ties.

March 29, 2000 - Found cast iron monument and established NAD 1983 (1996 Adjustment) Anoka County Project Coordinates by Static GPS methods. Updated ties.

June 9, 2010 - Found cast iron monument down 0.3'± and updated ties.

August 12, 2015 - Found cast iron monument and updated ties.