

# CERTIFICATE OF LOCATION OF GOVERNMENT CORNER

County of Anoka

State of Minnesota

## West 1/4 Corner of Sec. 13 Township 32 Range 25

On the 9th day of May, 1967, the described corner was evidenced by area resurvey

and to perpetuate the location of said corner, at the exact location thereof, a permanent marker was placed consisting of a red and white iron pipe

AND on the 1st day of October, 2015, said permanent marker was found 1.5" Red and white iron pipe rusted off 0.6' above ground and the ties were updated

Updated reference ties are as shown below.

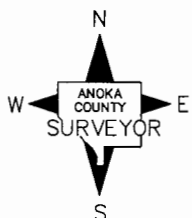
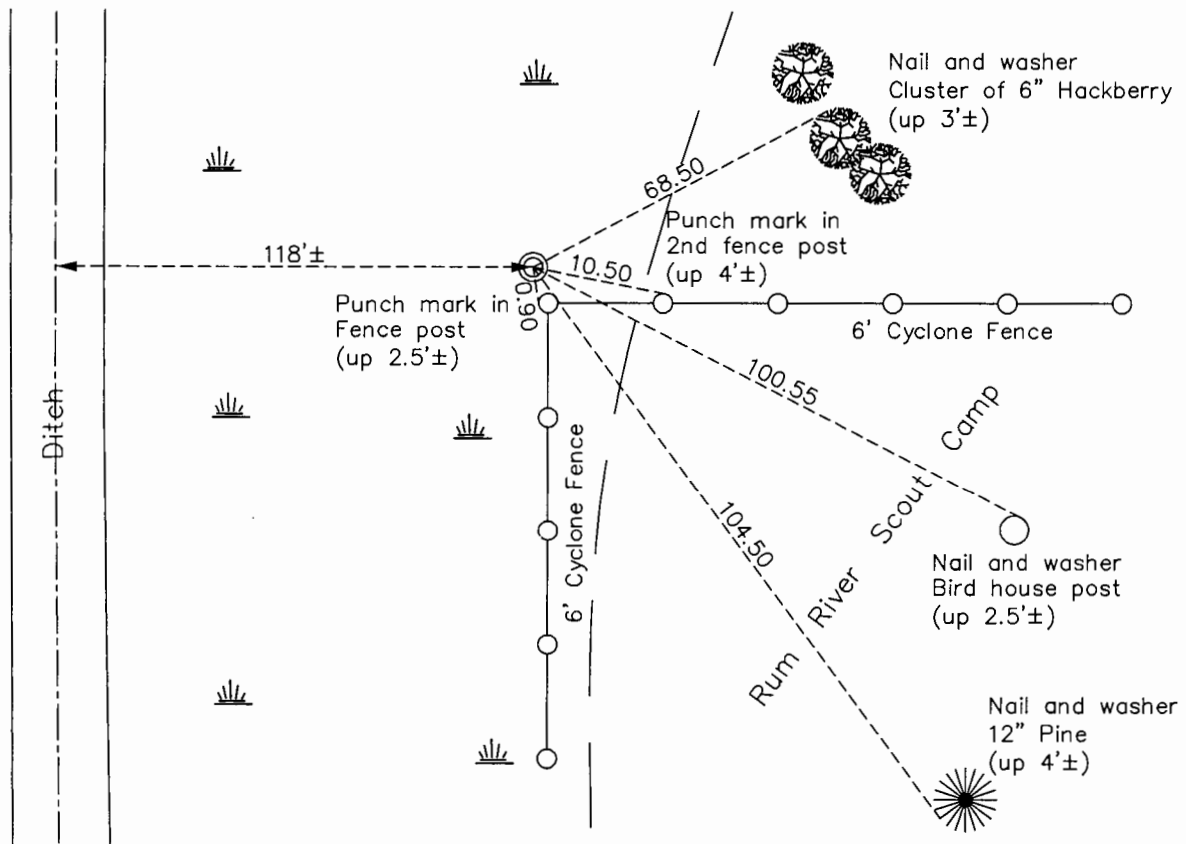

Revision Date

8/2/16

N.A.D. 1983 Coordinates  
(1996 Adjustment)

County Project Coordinates	
Northing	<u>183029.8471</u>
Easting	<u>463378.0952</u>
Date	<u>4/13/00</u>

I hereby certify that this United States public land survey monument record is correct and complete to the best of my knowledge and belief.

*Larry D. Hoium* Date 8/30/16

Larry D. Hoium, Anoka County Surveyor

Minnesota License Number 18165

# HISTORY OF GOVERNMENT CORNER

Page No. 65

County of Anoka

State of Minnesota

West 1/4 Corner of Sec. 13 Township 32 Range 25

## **CORNER HISTORY:**

May 9, 1967 - Set red and white 2"X8' iron pipe up 4'± using area resurvey and established ties to iron pipe.

June 24, 1969 - Found red and white iron pipe and updated ties.

June 30, 1976 - Found red and white iron pipe and updated ties.

March 17, 1977 - Found red and white iron pipe up 4'± and updated ties.

July 5, 1979 - Found red and white iron pipe and updated ties.

August 23, 1982 - Found red and white iron pipe and updated ties.

July 30, 1985 - Found red and white iron pipe and updated ties.

July 12, 1988 - Found red and white iron pipe and updated ties.

April 13, 2000 - Found red and white iron pipe and established NAD 1983 (1996 Adjustment) Anoka County Project Coordinates by Static GPS methods. Updated ties.

May 27, 2010 - Found red and white iron pipe rusted off 0.6'± above ground and updated ties.

October 1, 2015 - Found red and white iron pipe rusted off 0.6'± above ground and updated ties.