

CERTIFICATE OF LOCATION OF GOVERNMENT CORNER

County of Anoka

State of Minnesota

Witness Corner of Sec. 20 Township 32 Range 25
(On north line of section)

On the 14th day of June, 1968, the described corner was evidenced by area resurvey

and to perpetuate the location of said corner, at the exact location thereof, a permanent marker was placed consisting of a cast iron monument with a sign and post on the north side

AND on the 10th day of September, 2015, said permanent marker was found flush and the
ties were updated

Updated reference ties are as shown below.

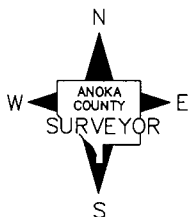
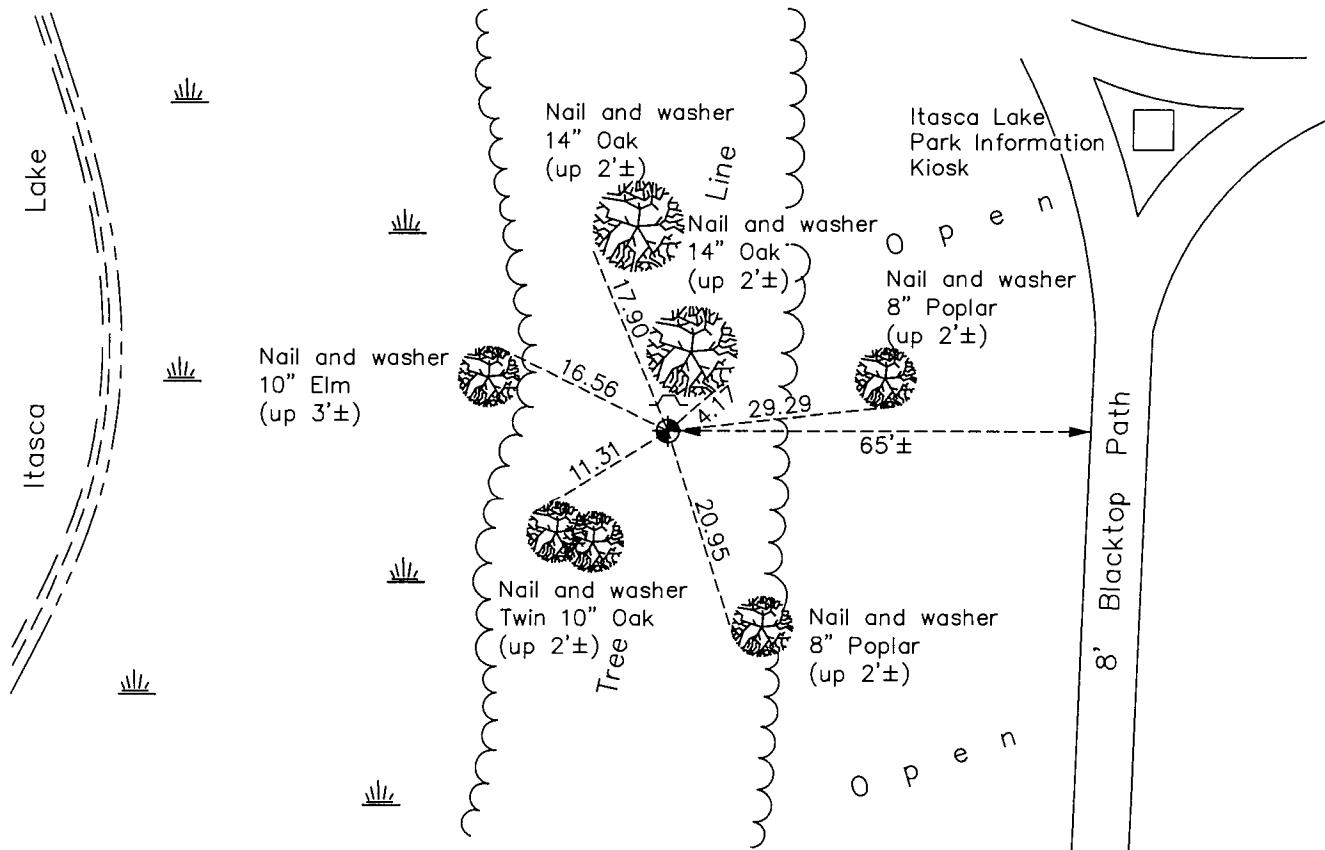

Revision Date
8/8/16

N.A.D. 1983 Coordinates
(1996 Adjustment)

County Project Coordinates	
Northing	180494.8022
Easting	443350.9312
Date	4/24/00

I hereby certify that this United States public land survey monument record is correct and complete to the best of my knowledge and belief.

Larry D. Hoium Date 8/25/16

Larry D. Hoium, Anoka County Surveyor
Minnesota License Number 18165

HISTORY OF GOVERNMENT CORNER

Page No. 78

County of Anoka

State of Minnesota

Witness Corner of Sec. 20 Township 32 Range 25
(On north line of section)

CORNER HISTORY:

June 14, 1968 - Set cast iron monument flush with the surface using area resurvey and established ties to monument.

June 13, 1969 - Found cast iron monument and updated ties.

August 1, 1972 - Found cast iron monument and updated ties.

1977 - Found cast iron monument and updated ties.

July 5, 1979 - Found cast iron monument and updated ties.

August 16, 1982 - Found cast iron monument and updated ties.

June 29, 1988 - Found cast iron monument and updated ties.

August 18, 1993 - Found cast iron monument and updated ties.

May 9, 1996 - Found cast iron monument with a sign and post on the north side and updated ties.

April 24, 2000 - Found cast iron monument with a sign and post on the north side and established NAD 1983 (1996 Adjustment) Anoka County Project Coordinates by Static GPS methods. Updated ties.

June 7, 2010 - Found cast iron monument flush with the surface with a sign and post on the north side and updated ties.

September 10, 2015 - Found cast iron monument with a sign and post on the north side and updated ties.