

# CERTIFICATE OF LOCATION OF GOVERNMENT CORNER

County of Anoka

State of Minnesota

Witness Corner of Sec. 18 Township 32 Range 25  
 (On east line of section)

On the 2nd day of October, 1963, the described corner was evidenced by a concrete  
monument (0.4' square)

and to perpetuate the location of said corner, at the exact location thereof, a permanent marker  
 was placed consisting of the same concrete monument with a sign and post on the north side

AND on the 16th day of September, 2015, said permanent marker was found up 0.6'± and  
the ties were updated

Updated reference ties are as shown below.

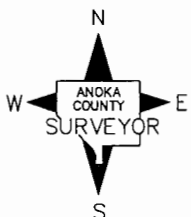
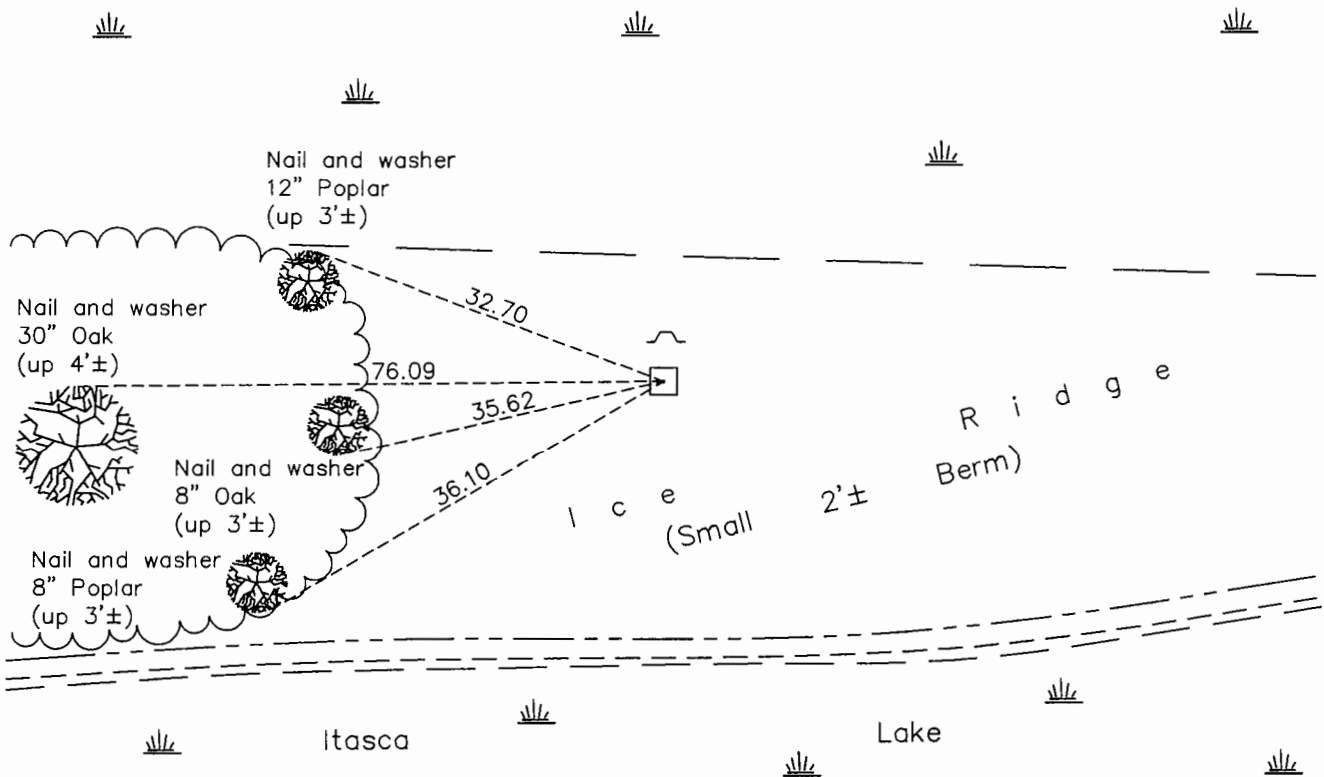

Revision Date  
8/8/16

N.A.D. 1983 Coordinates  
 (1996 Adjustment)

County Project Coordinates	
Northing	<u>181197.4222</u>
Easting	<u>442207.7210</u>
Date	<u>4/25/00</u>

I hereby certify that this United States public land survey monument record is correct and complete to the best of my knowledge and belief.

*Larry D. Hoium* Date 8/25/16

Larry D. Hoium, Anoka County Surveyor

Minnesota License Number 18165

# HISTORY OF GOVERNMENT CORNER

Page No. 79

County of Anoka

State of Minnesota

Witness Corner of Sec. 18 Township 32 Range 25  
(On east line of section)

## **CORNER HISTORY:**

November 4, 1943 - Cartwright found concrete monument set flush with the surface. Established ties to monument.

October 2, 1963 - Found 4" square concrete monument up 0.3'± and updated ties.

August 7, 1964 - Found concrete monument and updated ties.

June 16, 1969 - Found concrete monument and updated ties.

August 1, 1972 - Found concrete monument and updated ties.

July 1, 1976 - Found concrete monument and updated ties.

July 6, 1979 - Found concrete monument and updated ties.

August 12, 1982 - Found concrete monument and updated ties.

September 16, 1985 - Found concrete monument and updated ties.

June 10, 1988 - Found concrete monument and updated ties.

May 13, 1996 - Found concrete monument and updated ties. Set a sign and post on the north side.

April 25, 2000 - Found concrete monument with a sign and post on the north side and established NAD 1983 (1996 Adjustment) Anoka County Project Coordinates by Static GPS methods. Updated ties.

December 21, 2010 - Found 0.4' square concrete monument up 0.6'± with a sign and post on the north side and updated ties.

September 16, 2015 - Found 0.4' square concrete monument up 0.6'± with a sign and post on the north side and updated ties.