

CERTIFICATE OF LOCATION OF GOVERNMENT CORNER

County of Anoka

State of Minnesota

Witness Corner of Sec. 19 Township 32 Range 25
 (On west line of section)

On the 16th day of June, 1969, the described corner was evidenced by area resurvey

and to perpetuate the location of said corner, at the exact location thereof, a permanent marker was placed consisting of a cast iron monument with a sign and post 1.2'± north

AND on the 2nd day of October, 2015, said permanent marker was found up 0.1' and the ties were updated

Updated reference ties are as shown below.

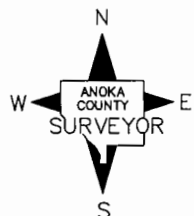
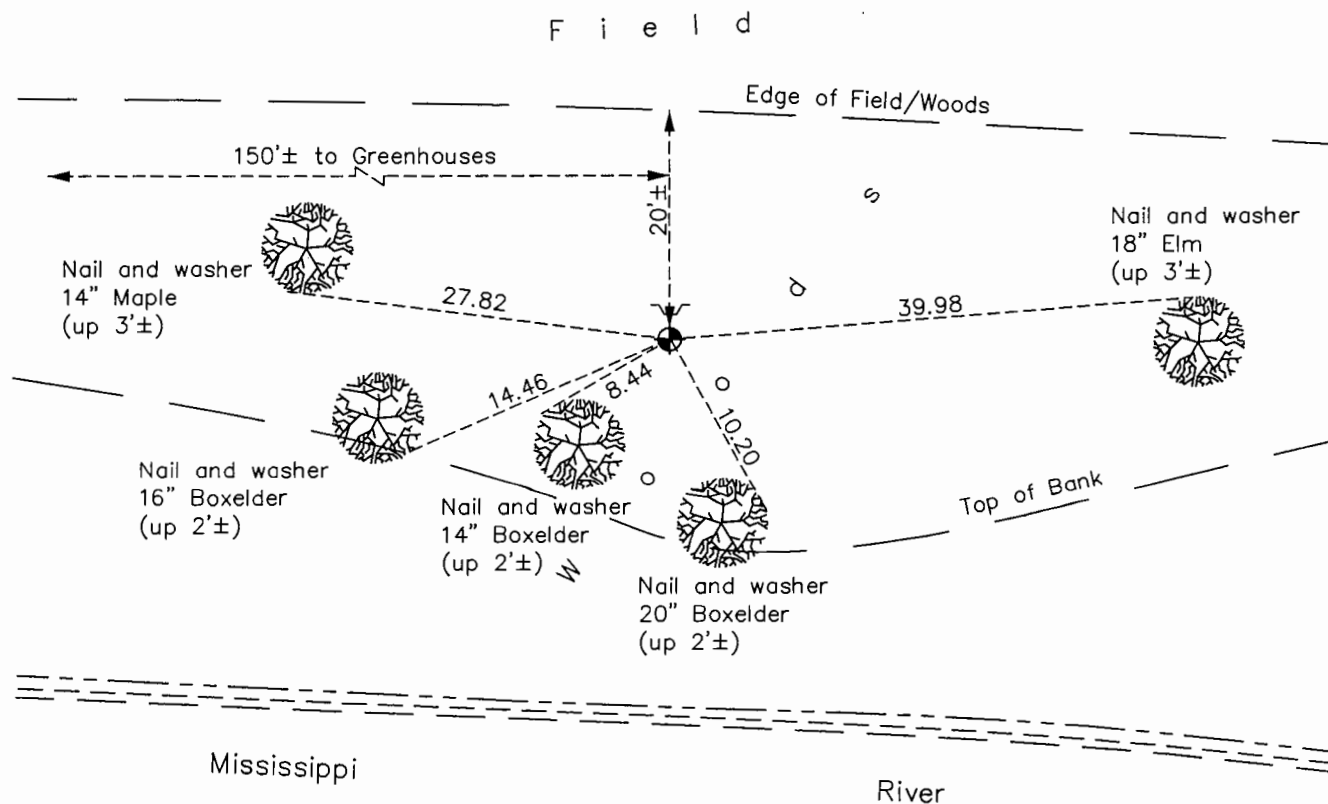

Revision Date

8/10/16

N.A.D. 1983 Coordinates
(1996 Adjustment)

County Project Coordinates	
Northing	177302.1914
Easting	436636.9631
Date	5/05/00

I hereby certify that this United States public land survey monument record is correct and complete to the best of my knowledge and belief.

Larry D. Hoium Date 8/30/16

Larry D. Hoium, Anoka County Surveyor

Minnesota License Number 18165

HISTORY OF GOVERNMENT CORNER

Page No. 85

County of Anoka

State of Minnesota

Witness Corner of Sec. 19 Township 32 Range 25
(On west line of section)

CORNER HISTORY:

December 4, 1967 - Set cast iron monument flush with the surface using area resurvey and established ties to monument.

June 16, 1969 - Found cast iron monument and updated ties.

July 27, 1972 - Found cast iron monument and updated ties.

July 6, 1976 - Found cast iron monument and updated ties.

June 22, 1979 - Found cast iron monument and updated ties.

August 16, 1982 - Found cast iron monument and updated ties.

July 25, 1985 - Found cast iron monument and updated ties.

June 23, 1988 - Found cast iron monument and updated ties.

May 5, 2000 - Found cast iron monument with a sign and post on the north side and established NAD 1983 (1996 Adjustment) Anoka County Project Coordinates by Static GPS methods. Updated ties.

May 14, 2010 - Found cast iron monument up 0.1'± with a sign and post on the north side and updated ties.

October 2, 2015 - Found cast iron monument up 0.1'± with a sign and post 1.2'± north of monument and updated ties.