

CERTIFICATE OF LOCATION OF GOVERNMENT CORNER

County of Anoka

State of Minnesota

North $\frac{1}{4}$ Corner of Sec. 36 Township 32 Range 25

On the 12th day of August, 1964, the described corner was evidenced by a 1" iron pipe

and to perpetuate the location of said corner, at the exact location thereof, a permanent marker was placed consisting of a cast iron monument with a sign and post on the East side

AND on the 17th day of August, 2015, said permanent marker was found down 0.7'± and the ties were updated

Updated reference ties are as shown below.

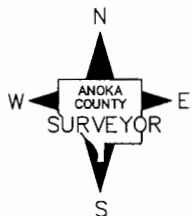
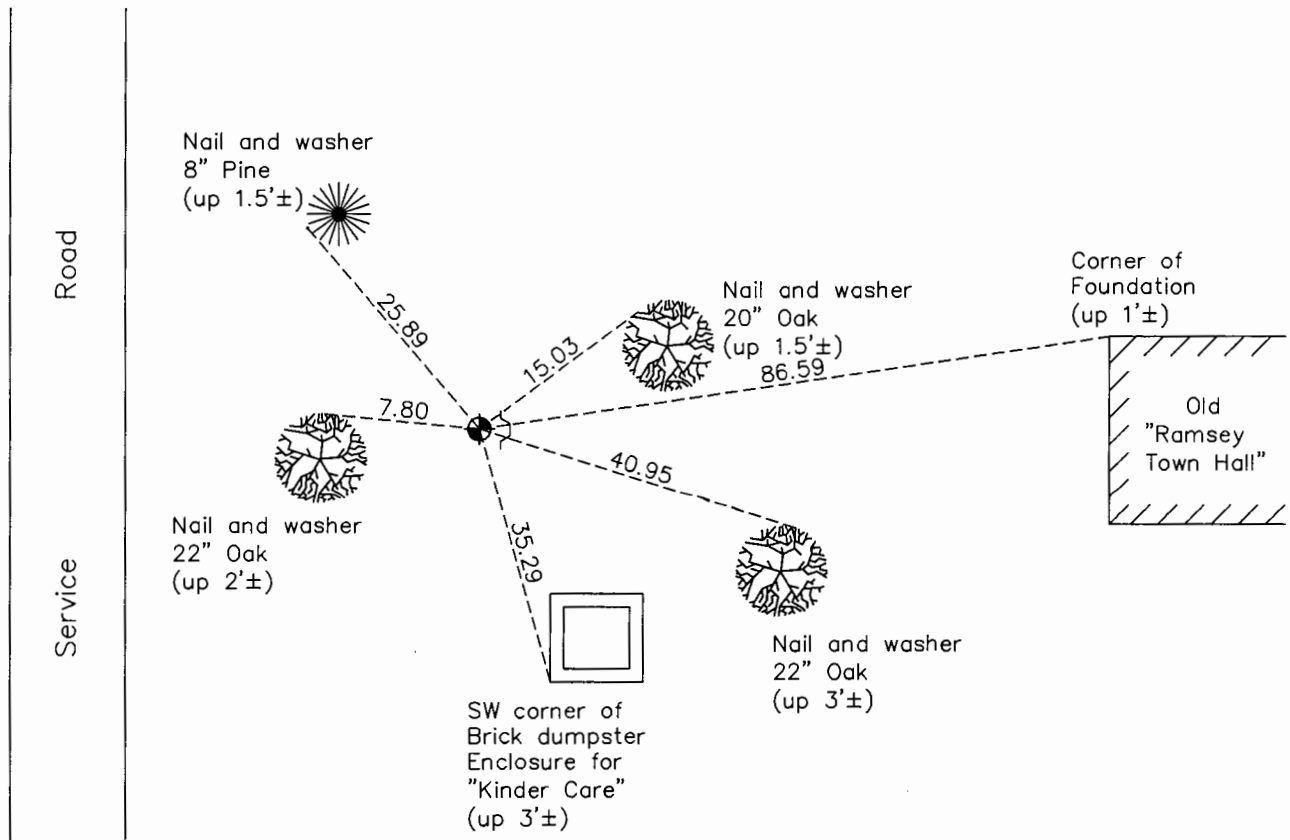

Revision Date

8/16/16

N.A.D. 1983 Coordinates
(1996 Adjustment)

County Project Coordinates	
Northing	169863.6154
Easting	465907.2953
Date	1/11/00

I hereby certify that this United States public land survey monument record is correct and complete to the best of my knowledge and belief.

Larry D. Hoium Date 8/30/16

Larry D. Hoium, Anoka County Surveyor

Minnesota License Number 18165

HISTORY OF GOVERNMENT CORNER

County of Anoka

State of Minnesota

North 1/4 Corner of Sec. 36 Township 32 Range 25

CORNER HISTORY:

July 28, 1959 - Found 1" iron pipe and established ties to iron pipe.

August 12, 1964 - Found 1" iron pipe up 0.2'± and 0.5'± east of fence corner with a metal fence post 5'± east of iron pipe. Updated ties.

June 24, 1969 - Replaced 1" iron pipe with a cast iron monument set up 0.1'±. Updated ties.

September 2, 1972 - Found cast iron monument and updated ties.

July 8, 1976 - Found cast iron monument and updated ties.

June 26, 1979 - Found cast iron monument and updated ties.

August 17, 1982 - Found cast iron monument and updated ties.

Date unknown - Found cast iron monument with a sign and post on the north side and updated ties.

June 29, 1988 - Found cast iron monument and updated ties.

August 11, 1993 - Found cast iron monument and updated ties.

January 11, 2000 - Found cast iron monument and established NAD 1983 (1996 Adjustment) Anoka County Project Coordinates by Static GPS methods. Updated ties.

April 1, 2010 - Found cast iron monument down 0.6'± with a sign and post on the north side and updated ties.

August 17, 2015 - Found cast iron monument down 0.7'± with a sign and post on the east side and updated ties.