

# CERTIFICATE OF LOCATION OF GOVERNMENT CORNER

County of Anoka

State of Minnesota

## South 1/4 Corner of Sec. 28 Township 32 Range 25

On the 24th day of August, 1964, the described corner was evidenced by a concrete monument

and to perpetuate the location of said corner, at the exact location thereof, a permanent marker was placed consisting of a cast iron monument with a sign and post on the south side

AND on the 1st day of October, 2015, said permanent marker was found down 1.5' and the ties were updated

Updated reference ties are as shown below.

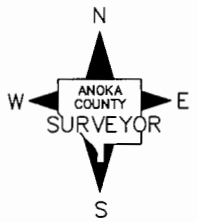
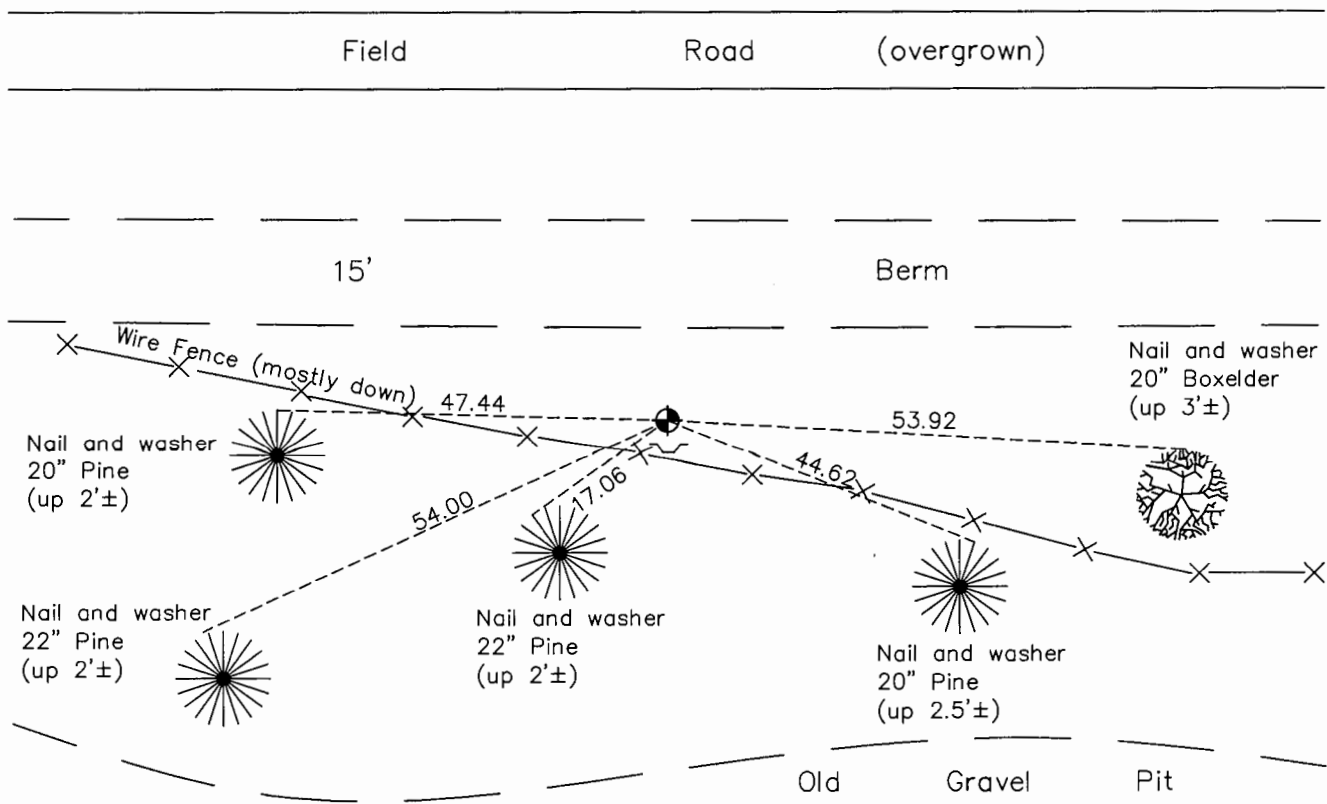

N.A.D. 1983 Coordinates  
(1996 Adjustment)

County Project Coordinates	
Northing	169797.6862
Easting	450181.4580
Date	12/22/99

I hereby certify that this United States public land survey monument record is correct and complete to the best of my knowledge and belief.

*Larry D. Hoium* Date 8/30/16

Larry D. Hoium, Anoka County Surveyor

Minnesota License Number 18165

Revision Date  
8/17/16

# HISTORY OF GOVERNMENT CORNER

County of Anoka

State of Minnesota

South 1/4 Corner of Sec. 28 Township 32 Range 25

**CORNER HISTORY:**

May 10, 1944 - Cartwright found concrete monument and established ties to monument.

August 24, 1964 - Found 4" square concrete monument flush with the surface and updated ties.

June 26, 1969 - Found concrete monument and set 1" iron pipe on north side of monument. Updated ties.

August 7, 1972 - Found concrete monument and updated ties.

July 8, 1976 - Found concrete monument and updated ties.

June 22, 1979 - Found concrete monument and updated ties.

August 18, 1982 - Found concrete monument and updated ties.

July 26, 1985 - Found concrete monument and updated ties.

June 27, 1988 - Found cast iron monument, date set unknown, and updated ties.

August 20, 1993 - Found cast iron monument and updated ties.

December 22, 1999 - Found cast iron monument with a sign and post on the north side and established NAD 1983 (1996 Adjustment) Anoka County Project Coordinates by Static GPS methods. Updated ties.

April 29, 2010 - Found cast iron monument down 1.5'± with a sign and post on the south side and updated ties.

October 1, 2015 - Found cast iron monument down 1.5'± with a sign and post on the south side and updated ties.