

CERTIFICATE OF LOCATION OF GOVERNMENT CORNER

County of Anoka

State of Minnesota

South $\frac{1}{4}$ Corner of Sec. 29 Township 32 Range 25

On the 19th day of April, 1962, the described corner was evidenced by a 4" square concrete monument

and to perpetuate the location of said corner, at the exact location thereof, a permanent marker was placed consisting of the same concrete monument with a $\frac{3}{4}$ " iron pipe on the north side and a sign and post on the south side

AND on the 2nd day of October, 2015, said permanent marker was found down 0.3' and the ties were updated

Updated reference ties are as shown below.

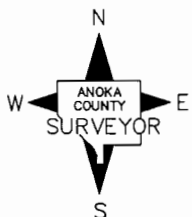
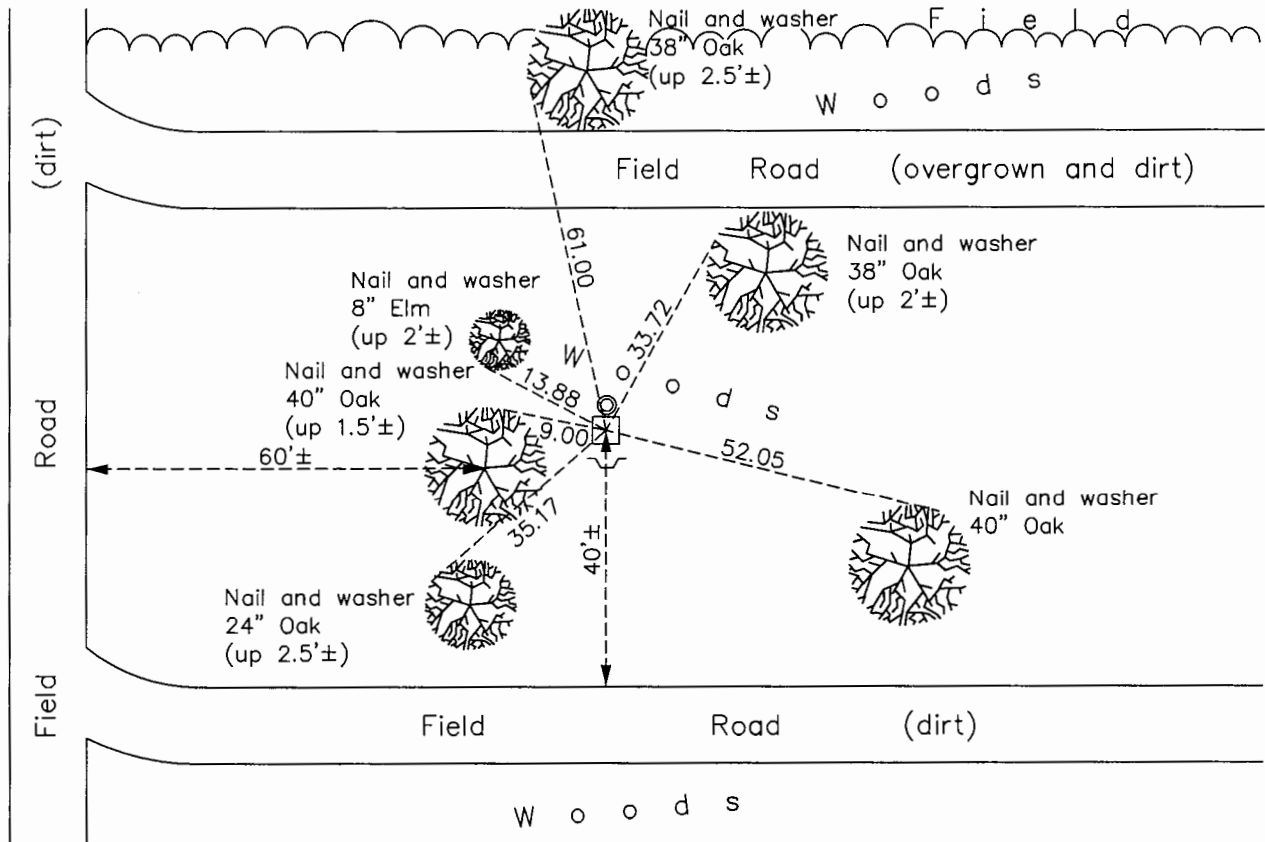

Revision Date
8/17/16

N.A.D. 1983 Coordinates
(1996 Adjustment)

County Project Coordinates	
Northing	169849.3789
Easting	444857.5742
Date	1/12/01

I hereby certify that this United States public land survey monument record is correct and complete to the best of my knowledge and belief.

Larry D. Hoium Date 8/30/16

Larry D. Hoium, Anoka County Surveyor
Minnesota License Number 18165

HISTORY OF GOVERNMENT CORNER

County of Anoka

State of Minnesota

South 1/4 Corner of Sec. 29 Township 32 Range 25

CORNER HISTORY:

September 14, 1943 - Cartwright found concrete monument flush with the surface and established ties to monument.

April 19, 1962 - Found 4" square concrete monument flush with the surface and set a 3/4" iron pipe on the north side of monument. Updated ties.

August 12, 1964 - Found concrete monument and updated ties.

June 20, 1969 - Found concrete monument down 0.2'± and updated ties.

August 18, 1972 - Found concrete monument and updated ties.

July 8, 1976 - Found concrete monument and updated ties.

June 22, 1979 - Found concrete monument and updated ties.

August 16, 1982 - Found concrete monument and updated ties.

June 24, 1988 - Found concrete monument and updated ties.

August 20, 1993 - Found concrete monument and updated ties.

January 12, 2001 - Found 4" square concrete monument with a 3/4" iron pipe on the north side and a sign and post on the south side. Established NAD 1983 (1996 Adjustment) Anoka County Project Coordinates by Static GPS methods. Updated ties.

May 17, 2010 - Found concrete monument down 0.3'± with a sign and post on the south side and updated ties.

October 2, 2015 - Found 4" square concrete monument down 0.3'± with a 3/4" iron pipe on the north side and a sign and post on the south side. Updated ties.