

CERTIFICATE OF LOCATION OF GOVERNMENT CORNER

County of Anoka

State of Minnesota

East 1/4 Corner of Sec. 36 Township 32 Range 25

On the 8th day of May, 1963, the described corner was evidenced by area resurvey

and to perpetuate the location of said corner, at the exact location thereof, a permanent marker was placed consisting of a cast iron monument

AND on the 23rd day of October, 2015, said permanent marker was found down 0.6' with a sign and post on the northwest side and the ties were updated.

Updated reference ties are as shown below.

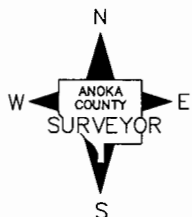
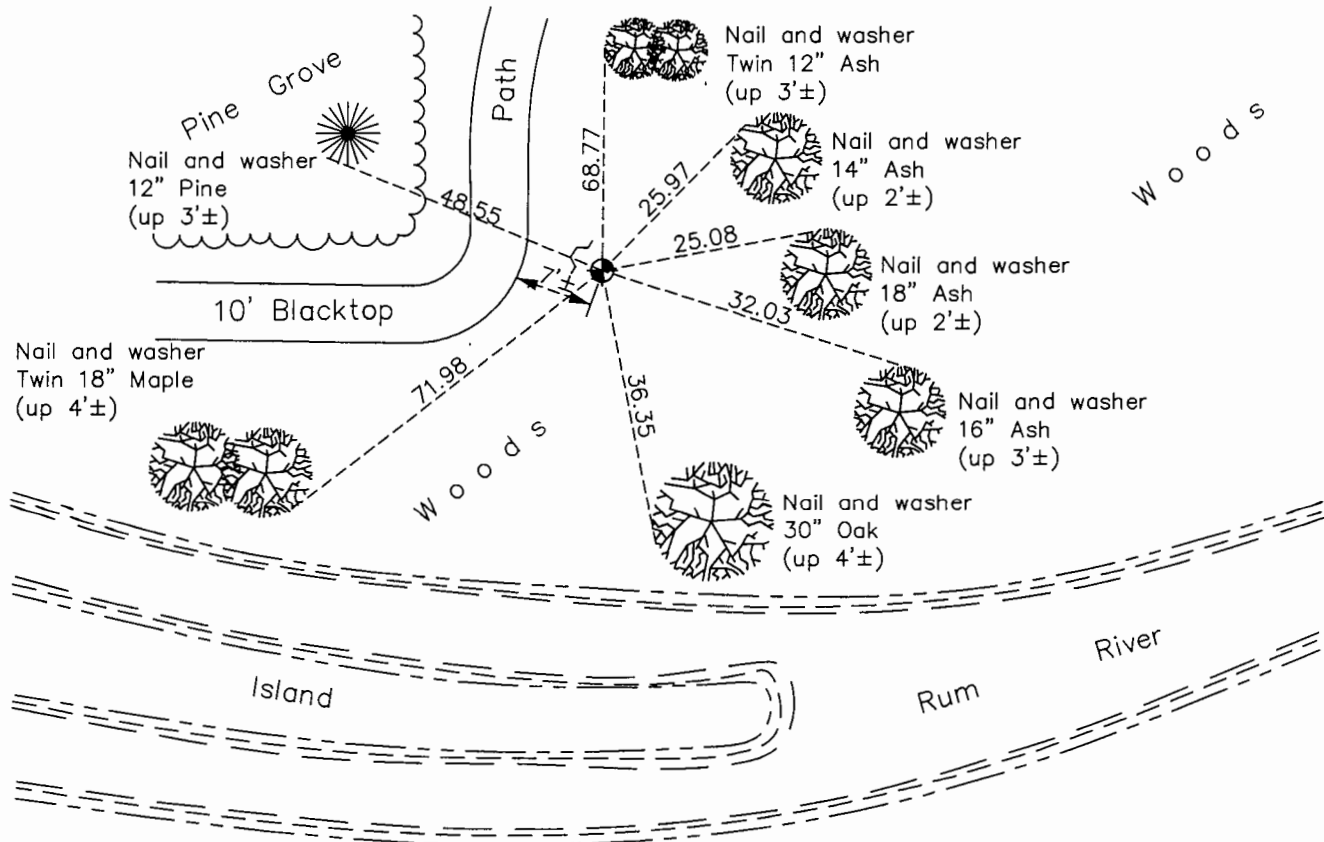

Revision Date
8/18/16

N.A.D. 1983 Coordinates
(1996 Adjustment)

County Project Coordinates	
Northing	167209.6384
Easting	468557.2486
Date	4/12/00

I hereby certify that this United States public land survey monument record is correct and complete to the best of my knowledge and belief.

Larry D. Hoium Date 8/30/16

Larry D. Hoium, Anoka County Surveyor

Minnesota License Number 18165

HISTORY OF GOVERNMENT CORNER

County of Anoka

State of Minnesota

East 1/4 Corner of Sec. 36 Township 32 Range 25

CORNER HISTORY:

May 8, 1963 - Set cast iron monument using area resurvey and established ties to monument.

August 12, 1964 - Found cast iron monument and updated ties.

June 27, 1969 - Found cast iron monument flush with the surface and updated ties. Set steel fence post on northwest side of monument.

August 22, 1972 - Found cast iron monument and updated ties.

May 7, 1976 - Replaced cast iron monument and updated ties. Set sign and post on the north side of monument.

July 6, 1979 - Found cast iron monument and updated ties.

August 17, 1982 - Found cast iron monument and updated ties.

July 29, 1985 - Found cast iron monument and updated ties.

June 29, 1988 - Found cast iron monument and updated ties.

August 20, 1993 - Found cast iron monument and updated ties.

April 12, 2000 - Found cast iron monument and established NAD 1983 (1996 Adjustment) Anoka County Project Coordinates by Static GPS methods.

April 16, 2010 - Found cast iron monument down 0.6'±. Set a sign and post on the northwest side and updated ties.

October 23, 2015 - Found cast iron monument down 0.6'± with a sign and post on the northwest side and updated ties.