

# CERTIFICATE OF LOCATION OF GOVERNMENT CORNER

County of Anoka

State of Minnesota

## Sixteenth Corner of Sec. 36 Township 32 Range 25 (On east line of SE1/4)

On the 18th day of April, 1963, the described corner was evidenced by an iron pipe set  
by N.C. Hoium

and to perpetuate the location of said corner, at the exact location thereof, a permanent marker  
was placed consisting of a cast iron monument with a sign and post on the south side

AND on the 6th day of April, 2010, said permanent marker was not found

Updated reference ties are as shown below.

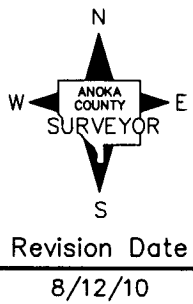
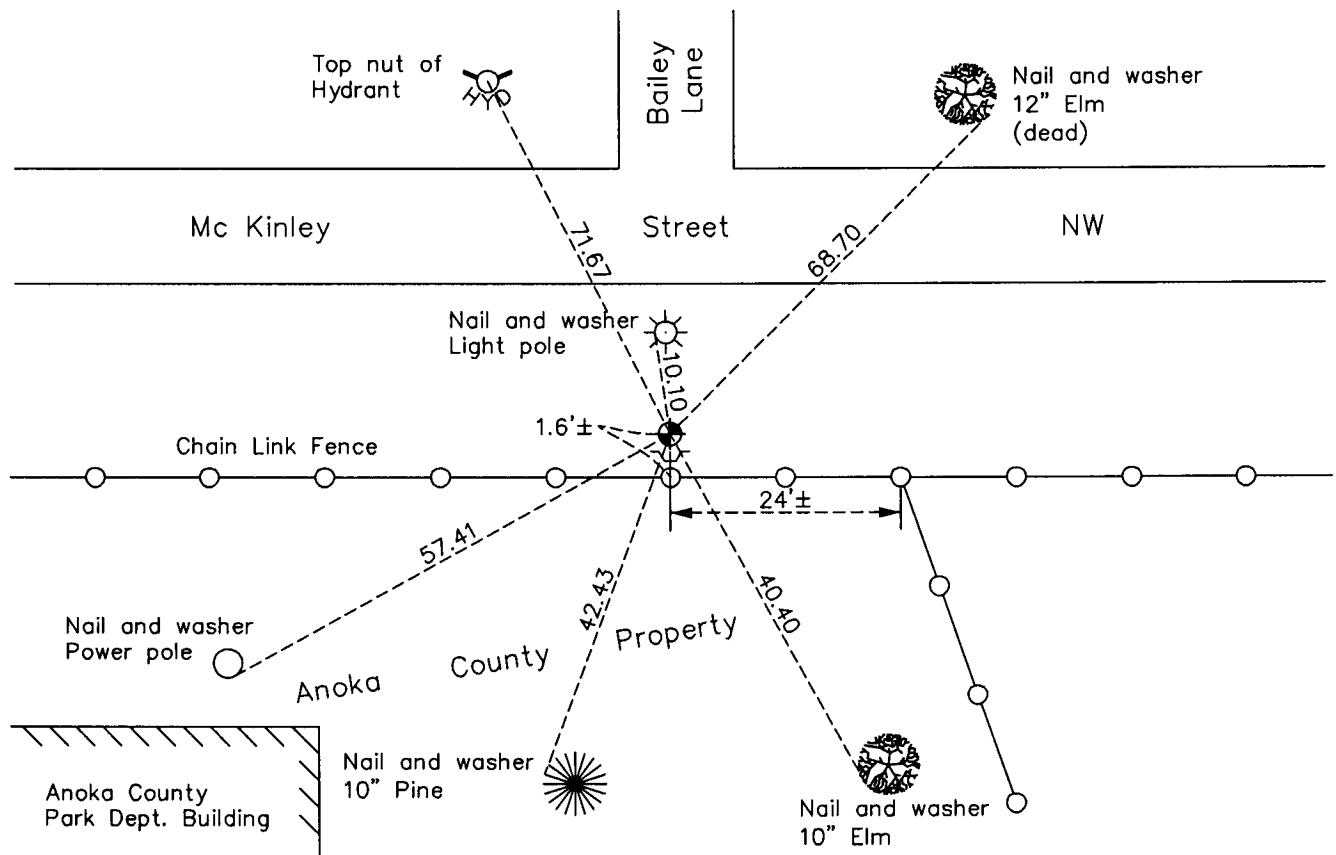

N.A.D. 1983 Coordinates  
(1996 Adjustment)

County Project Coordinates	
Northing	165905.1234
Easting	468550.4946
Date	12/17/99

I hereby certify that this United States public land survey monument record is correct and complete to the best of my knowledge and belief.

*Larry D. Hoium* Date 8/12/10

Larry D. Hoium, Anoka County Surveyor

Minnesota License Number 18165