

CERTIFICATE OF LOCATION OF GOVERNMENT CORNER

County of Anoka

State of Minnesota

Witness Corner of Sec. 36 Township 32 Range 25
 (On east line of section)

On the 27th day of March, 1963, the described corner was evidenced by area resurvey

and to perpetuate the location of said corner, at the exact location thereof, a permanent marker was placed consisting of a cast iron monument

AND on the 13th day of July, 2015, said permanent marker was found. Set a sign and post on the east side and the ties were updated.

Updated reference ties are as shown below.

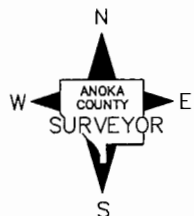
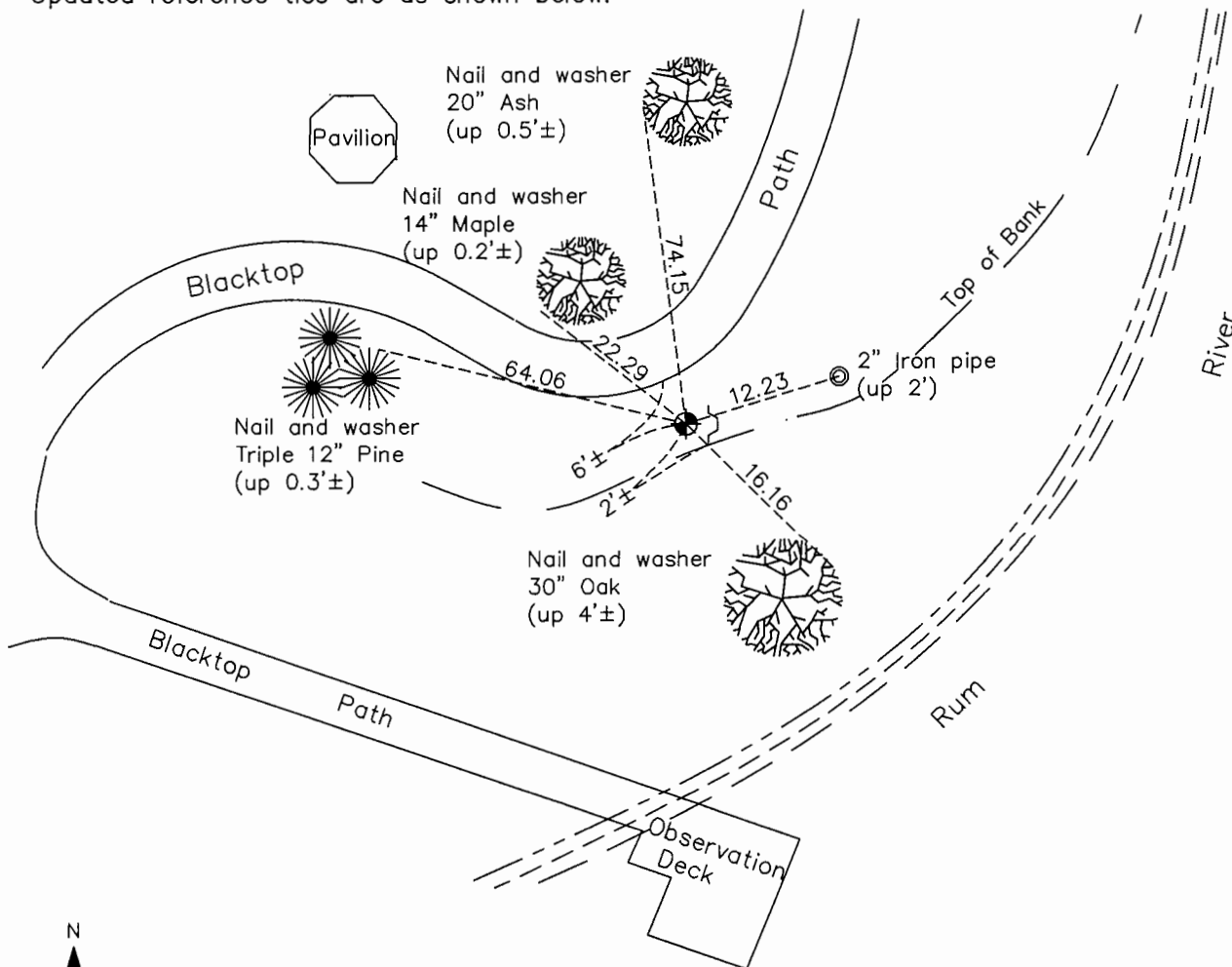

Revision Date

8/18/16

N.A.D. 1983 Coordinates
(1996 Adjustment)

County Project Coordinates	
Northing	<u>165290.4218</u>
Easting	<u>468547.2266</u>
Date	<u>4/06/00</u>

I hereby certify that this United States public land survey monument record is correct and complete to the best of my knowledge and belief.

Larry D. Hoium Date 8/30/16

Larry D. Hoium, Anoka County Surveyor

Minnesota License Number 18165

HISTORY OF GOVERNMENT CORNER

County of Anoka

State of Minnesota

Witness Corner of Sec. 36 Township 32 Range 25
(On east line of section)

CORNER HISTORY:

March 27, 1963 - Set cast iron monument using area resurvey and established ties to monument.

August 12, 1964 - Found cast iron monument and updated ties.

July 22, 1968 - Found cast iron monument and updated ties.

August 22, 1972 - Found cast iron monument and updated ties.

July 12, 1976 - Found cast iron monument and updated ties.

June 27, 1979 - Found cast iron monument and updated ties.

August 17, 1982 - Found cast iron monument and updated ties.

July 17, 1985 - Found cast iron monument and updated ties.

June 29, 1988 - Found cast iron monument and updated ties.

August 25, 1993 - Found cast iron monument and updated ties.

April 6, 2000 - Found cast iron monument and established NAD 1983 (1996 Adjustment) Anoka County Project Coordinates by Static GPS methods. Updated ties.

April 6, 2010 - Found cast iron monument 2'± west of edge of river bank and updated ties. Set a sign and post on the east side of monument.

July 13, 2015 - Found cast iron monument 2'± west of edge of river bank and updated ties. Set a new sign and post on the east side of monument.