

CERTIFICATE OF LOCATION OF GOVERNMENT CORNER

County of Anoka

State of Minnesota

Northeast Corner of Sec. 5 Township 31 Range 22

On the 13th day of May, 1963, the described corner was evidenced by a concrete monument

and to perpetuate the location of said corner, at the exact location thereof, a permanent marker was placed consisting of a cast iron monument set on top of the concrete monument (down 1'±)

AND on the 7th day of August, 2017, said permanent marker was found down 1.4'± and a partial cast iron monument was set flush with the surface on top of the existing CIM

Updated reference ties are as shown below.

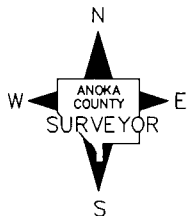
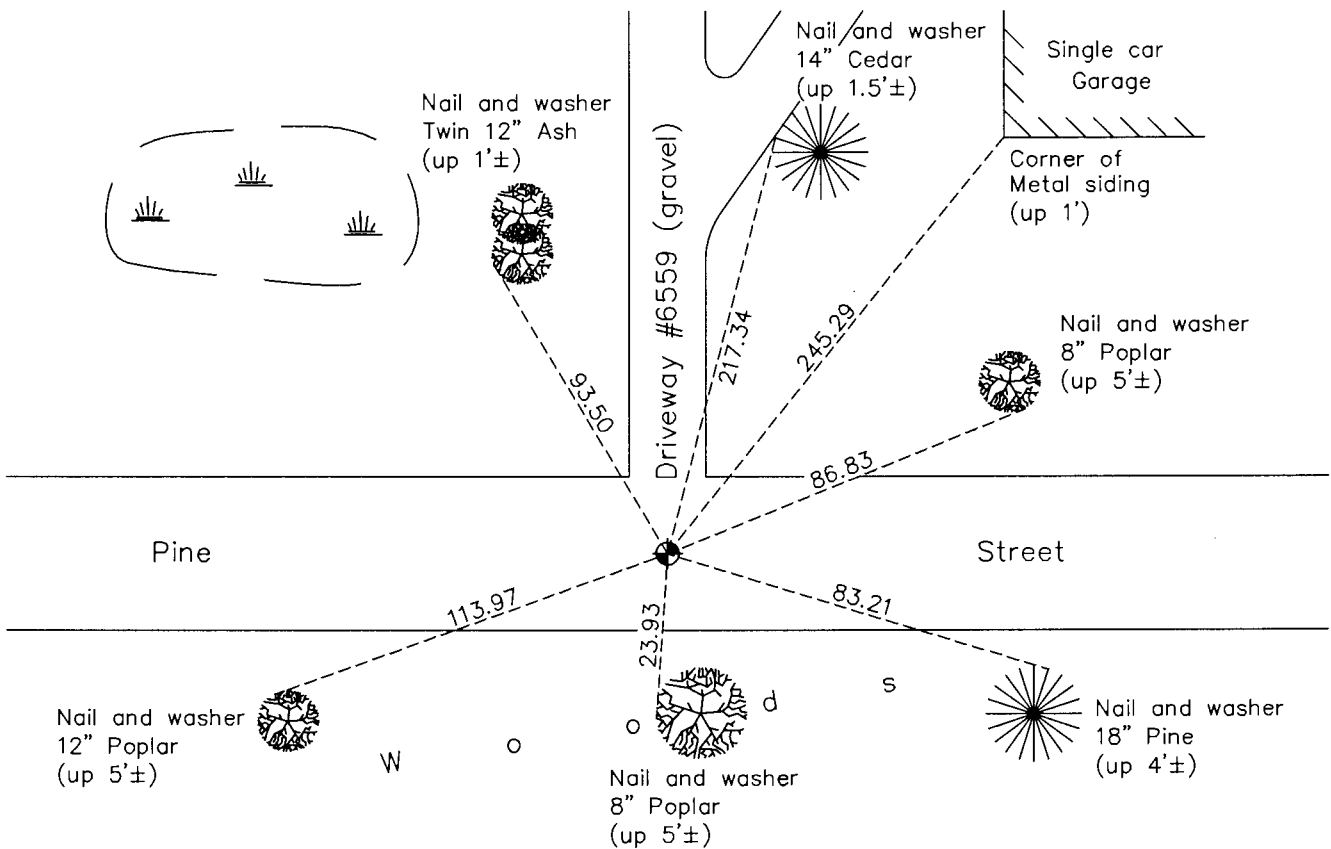

Revision Date

12/04/17

N.A.D. 1983 Coordinates
(1996 Adjustment)

County Project Coordinates	
Northing	<u>164099.8276</u>
Easting	<u>542645.5112</u>
Date	<u>3/02/98</u>

I hereby certify that this United States public land survey monument record is correct and complete to the best of my knowledge and belief.

Larry D. Hoium Date 12/04/17

Larry D. Hoium, Anoka County Surveyor

Minnesota License Number 18165

HISTORY OF GOVERNMENT CORNER

County of Anoka

State of Minnesota

Northeast Corner of Sec. 5 Township 31 Range 22

CORNER HISTORY:

September 6, 1943 - Cartwright found concrete monument and established ties to monument.

May 13, 1963 - Found 4" square concrete monument down 17"± with an iron pipe on north side. Set iron pipe down 0.1'± and established ties to iron pipe. Monument is 0.72' west and 0.47' north of a hub set by Milner Carley Associates as the approximate section corner.

June 18, 1965 - Found concrete monument and updated ties to iron pipe.

August 13, 1969 - Found concrete monument down 17"± and set cast iron monument down 0.4'± on top of concrete monument. Updated ties.

June 14, 1973 - Found cast iron monument and updated ties.

May 17, 1976 - Found cast iron monument and updated ties.

April 17, 1979 - Found cast iron monument, lowered it and updated ties.

July 30, 1980 - Found cast iron monument and updated ties.

July 14, 1986 - Found cast iron monument and updated ties.

June 27, 1991 - Found cast iron monument and updated ties.

March 2, 1998- Found cast iron monument and established NAD 1983 (1996 Adjustment) Anoka County Project Coordinates by Static GPS methods. Updated ties.

July 29, 2010 - Found cast iron monument down 1.4'± and updated ties.

August 3, 2016 - Found cast iron monument down 1.4'± and updated ties.

August 7, 2017 - Found cast iron monument down 1.4'± and set a partial cast iron monument flush with the surface on top of existing CIM. Verified location of corner by VRS GPS methods. Updated ties.