

CERTIFICATE OF LOCATION OF GOVERNMENT CORNER

County of Anoka

State of Minnesota

South 1/4 Corner of Sec. 33 Township 31 Range 22

On the 19th day of January, 1966, the described corner was evidenced by area resurvey

and to perpetuate the location of said corner, at the exact location thereof, a permanent marker was placed consisting of a cast iron monument

AND on the 9th day of August, 2017, said permanent marker was replaced with a new cast iron monument after road construction and the ties were updated

Updated reference ties are as shown below.

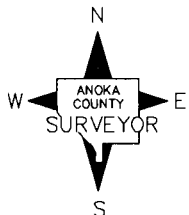
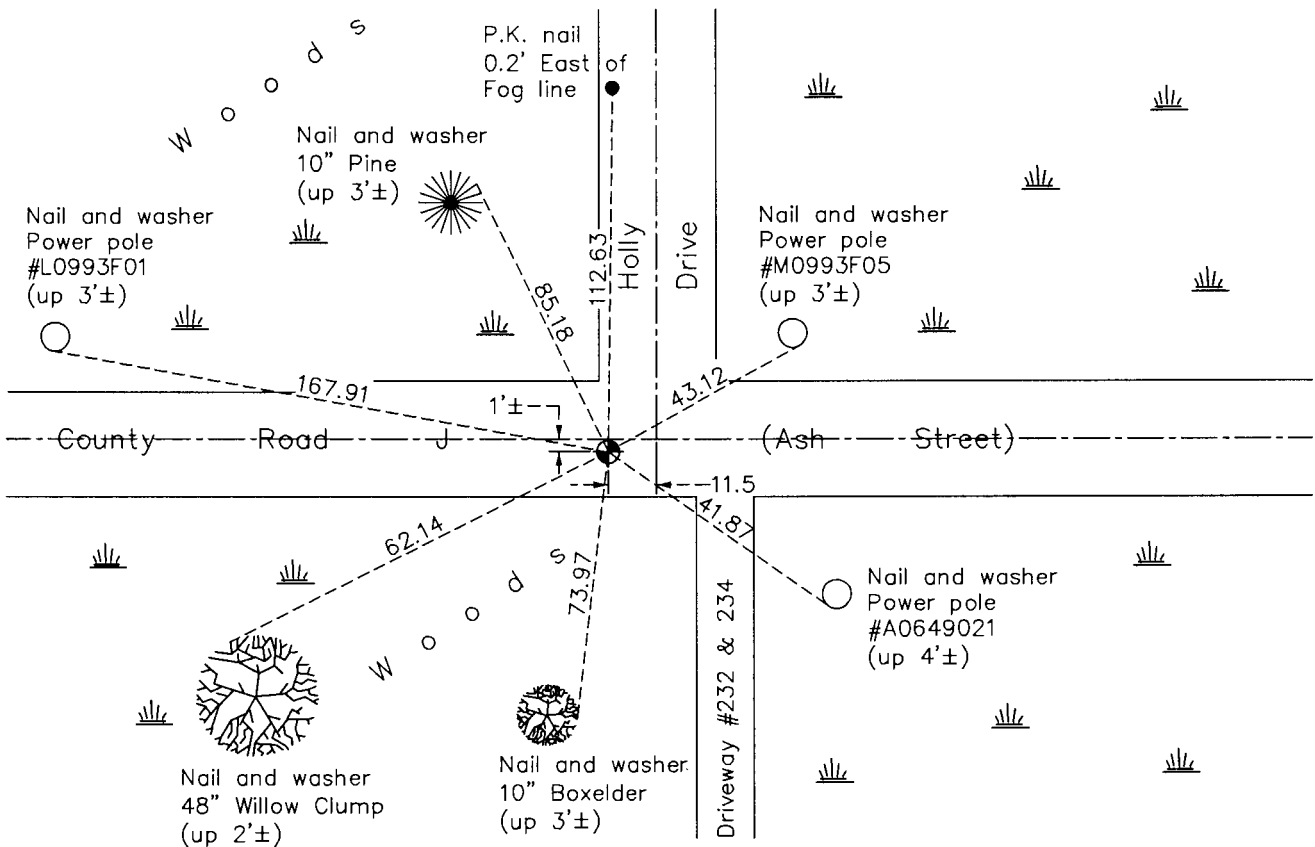

N.A.D. 1983 Coordinates
(1996 Adjustment)

| County Project Coordinates | |
|----------------------------|-------------|
| Northing | 132425.2199 |
| Easting | 545203.1572 |
| Date | 3/23/98 |

Revision Date

12/04/17

I hereby certify that this United States public land survey monument record is correct and complete to the best of my knowledge and belief.

Larry D. Hoium Date 12/04/17

Larry D. Hoium, Anoka County Surveyor

Minnesota License Number 18165

HISTORY OF GOVERNMENT CORNER

Page No. 146

County of Anoka

State of Minnesota

South 1/4 Corner of Sec. 33 Township 31 Range 22

CORNER HISTORY:

January 19, 1966 - Set P.K. nail for corner location using area resurvey. Also set P.K. nails 2.00' north and east of corner location. Established ties to corner.

September 14, 1967 - Set Cast Iron Monument 0.30' east of P.K. nail and updated ties.

August 27, 1969 - Found Cast Iron Monument and updated ties.

June 27, 1973 - Found Cast Iron Monument and updated ties.

June 8, 1977 - Found Cast Iron Monument and updated ties.

July 7, 1986 - Found Cast Iron Monument and updated ties.

April 18, 1990 - Set construction ties prior to road construction.

May 30, 1990 - Removed Cast Iron Monument prior to road construction.

August 27, 1990 - Set Cast Iron Monument flush with surface after road construction and updated ties.

October 24, 1991 - Found Cast Iron Monument and updated ties.

June 25, 1996 - Found Cast Iron Monument and updated ties.

March 23, 1998 - Found Cast Iron Monument and established NAD 1983 (1996 Adjustment) Anoka County Project Coordinates by Static GPS methods. Updated ties.

August 10, 2010 - Found Cast Iron Monument flush with the surface and updated ties.

January 23, 2017 - Found Cast Iron Monument flush with the surface and verified location of corner by VRS GPS methods. Updated ties.

June 9, 2017 - Set construction ties and removed cast iron monument prior to road construction.

August 9, 2017 - Set cast iron monument after road construction using construction ties. Verified location of corner by Static and VRS GPS methods. Updated ties.