

CERTIFICATE OF LOCATION OF GOVERNMENT CORNER

County of Anoka

State of Minnesota

Center Corner of Sec. 35 Township 32 Range 24

On the 30th day of March, 1962, the described corner was evidenced by a 6"x6" granite monument up 0.2'±

and to perpetuate the location of said corner, at the exact location thereof, a permanent marker was placed consisting of a cast iron monument. Not found on 12/11/2020 due to nearby road construction of detention basin.

AND on the 10th day of April, 2023, said permanent marker was set a 2"x2"x6' Telspar w/punchmarked cap up 0.4'± using RTK GPS methods. Established ties to monument.

Updated reference ties are as shown below.

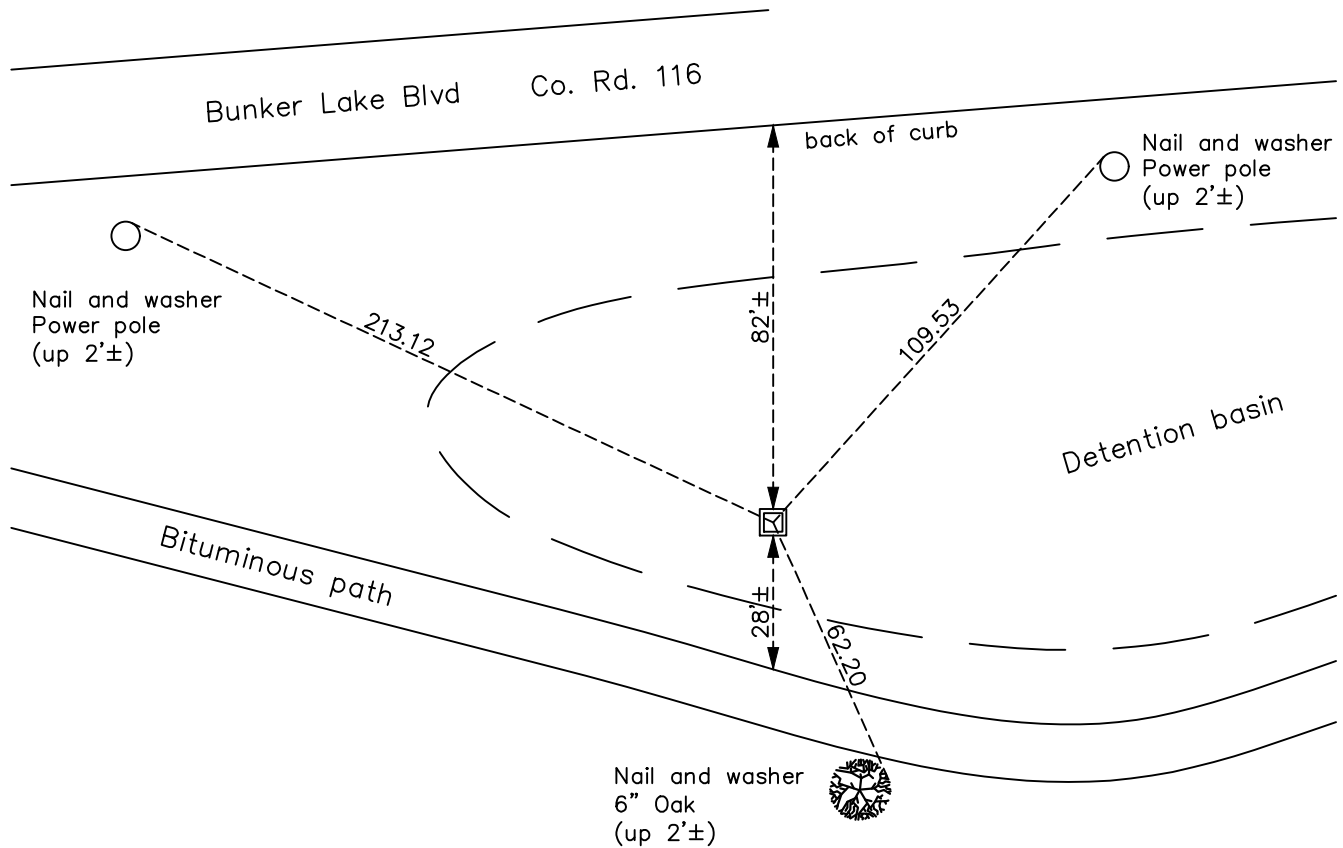

Revision Date
4/13/2023

N.A.D. 1983 Coordinates
 (2011 Adjustment)

County Project Coordinates	
Northing	<u>167034.310</u>
Easting	<u>492404.535</u>
Date	<u>4/6/23</u>

I hereby certify that this United States public land survey monument record is correct and complete to the best of my knowledge and belief.

David Zieglmeier Date 6/26/23

David M. Zieglmeier, Anoka County Surveyor
 Minnesota License Number 46179

HISTORY OF GOVERNMENT CORNER

Page No. 117

County of Anoka

State of Minnesota

Center Corner of Sec. 35 Township 32 Range 24

CORNER HISTORY:

March 30, 1962 - Found 6" x 6" granite monument up 0.2'± and updated ties.

August 20, 1964 - Found granite monument and updated ties.

July 23, 1968 - Found granite monument and updated ties.

July 7, 1972 - Found granite monument and updated ties.

June 15, 1976 - Found granite monument and updated ties.

October 12, 1977 - Set cast iron monument 3'± east of north/south fence line using area resurvey. Set monument for the parks department.

June 12, 1979 - Found cast iron monument and updated ties.

June 29, 1982 - Found cast iron monument and updated ties.

May 28, 1985 - Found cast iron monument and updated ties.

August 4, 1988 - Found cast iron monument and updated ties.

June 2015 - ANOKA COUNTY HIGHWAY RIGHT-OF-WAY PLAT NO. 94 shows position of location

December 11, 2020 - Cast iron monument missing due to nearby (2015) road construction of detention pond.

April 10, 2023 - Set a 2"x2"x6' Telspar w/punchmarked cap up 0.4'± using RTK GPS methods. Established ties to monument.