

# CERTIFICATE OF LOCATION OF GOVERNMENT CORNER

County of Anoka

State of Minnesota

## Northeast Corner of Sec. 36 Township 32 Range 24

On the 13th day of September, 1960, the described corner was evidenced by a granite monument

and to perpetuate the location of said corner, at the exact location thereof, a permanent marker was placed consisting of a cast iron monument

AND on the 4th day of November, 2020, said permanent marker was found flush with the surface and the ties were updated

Updated reference ties are as shown below.

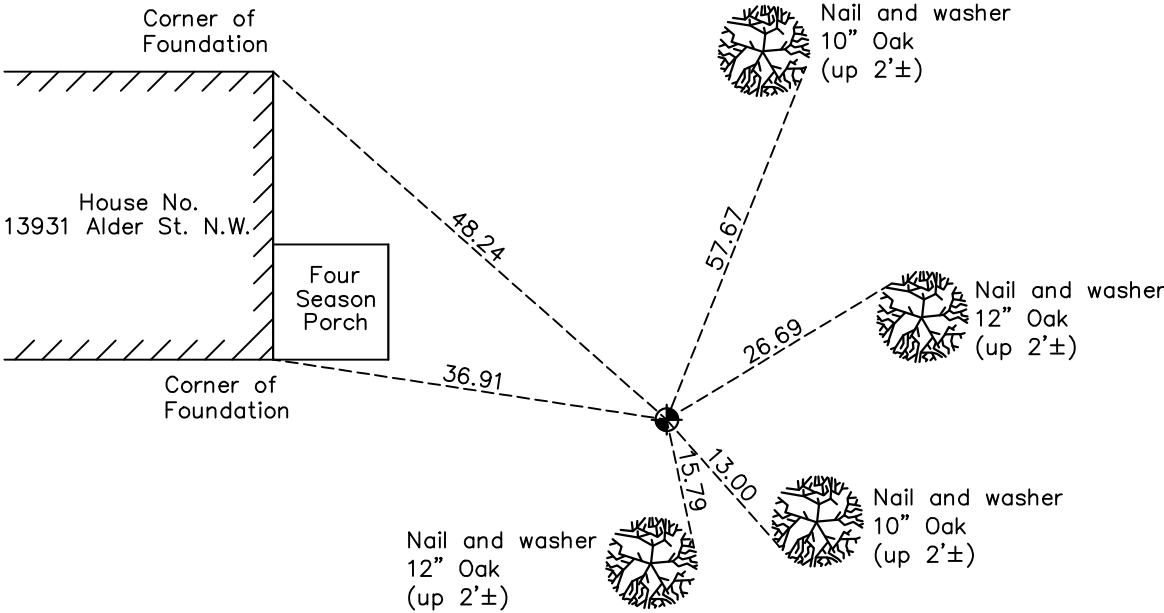

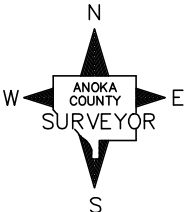
N  
  
 W ANOKA COUNTY SURVEYOR E  
 S

Revision Date  
03/18/2021

N.A.D. 1983 Coordinates  
(1996 Adjustment)

County Project Coordinates	
Northing	<u>169613.6568</u>
Easting	<u>500278.2289</u>
Date	<u>11/19/01</u>

I hereby certify that this United States public land survey monument record is correct and complete to the best of my knowledge and belief.

*David M Zieglmeier* Date 8/2/21

David M. Zieglmeier, Anoka County Surveyor  
 Minnesota License Number 46179

# HISTORY OF GOVERNMENT CORNER

Page No. 120

County of Anoka

State of Minnesota

## Northeast Corner of Sec. 36 Township 32 Range 24

### **CORNER HISTORY:**

September 13, 1960 found a granite monument. Replaced with a cast iron monument.

November 19, 2001 – Found corner monument missing due to construction. Reset position of corner with a cast iron monument using area resurvey and verified position by Static GPS methods.

January 31, 2011 – Found cast iron monument and updated ties.

July 6, 2016 – Found cast iron monument and updated ties.

November 4, 2020 – Found cast iron monument and updated ties.