

# CERTIFICATE OF LOCATION OF GOVERNMENT CORNER

County of Anoka

State of Minnesota

## Northeast Corner of Sec. 36 Township 32 Range 24

On the 13th day of September, 1960, the described corner was evidenced by a granite monument

and to perpetuate the location of said corner, at the exact location thereof, a permanent marker was placed consisting of a cast iron monument

AND on the 31st day of January, 2011, said permanent marker was found and the ties were updated

Updated reference ties are as shown below.

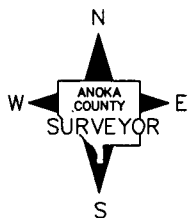
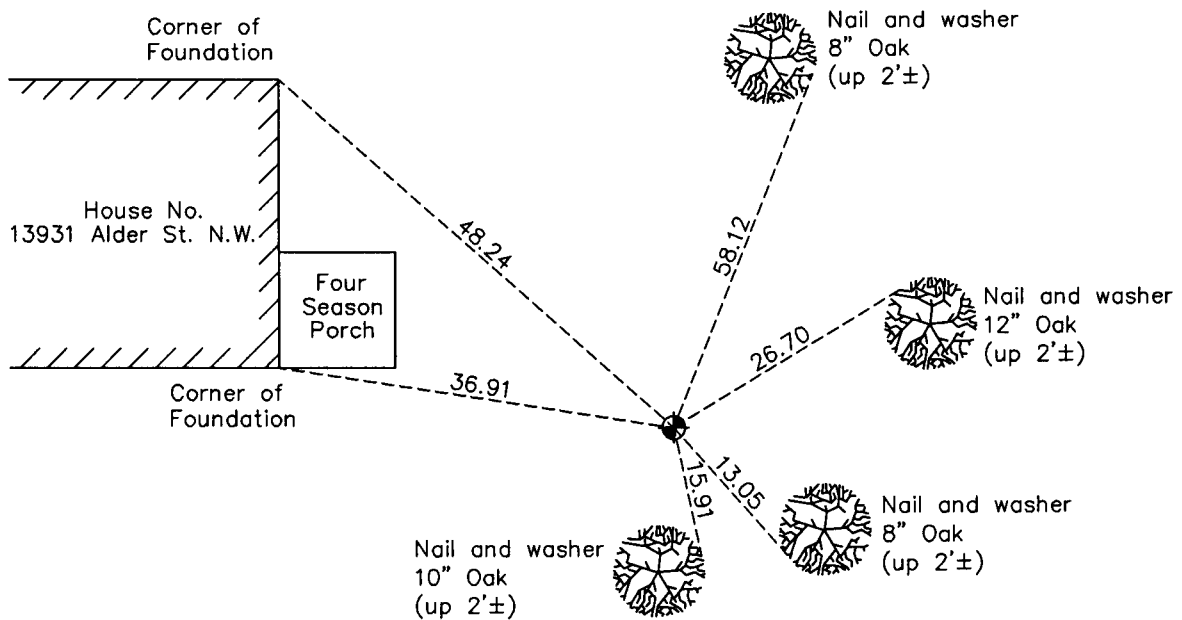

Revision Date

6/28/11

N.A.D. 1983 Coordinates  
(1996 Adjustment)

County Project Coordinates	
Northing	<u>169613.6568</u>
Easting	<u>500278.2289</u>
Date	<u>11/19/01</u>

I hereby certify that this United States public land survey monument record is correct and complete to the best of my knowledge and belief.

*Larry D. Hoium* Date 6/28/11

Larry D. Hoium, Anoka County Surveyor

Minnesota License Number 18165

# HISTORY OF GOVERNMENT CORNER

County of Anoka

State of Minnesota

## Northeast Corner of Sec. 36 Township 32 Range 24

### **CORNER HISTORY:**

Unable to locate field notes prior to November 19, 2001.

November 19, 2001 - Found corner monument missing due to construction. Reset position of corner with a cast iron monument using area resurvey and verified position by Static GPS methods.

January 31, 2011 - Found cast iron monument and updated ties.