

CERTIFICATE OF LOCATION OF GOVERNMENT CORNER

County of Anoka

State of Minnesota

Southeast Corner of Sec. 4 Township 31 Range 23

On the 18th day of September, 1959, the described corner was evidenced by a 3/4" iron pipe

and to perpetuate the location of said corner, at the exact location thereof, a permanent marker was placed consisting of a cast iron monument

AND on the 18th day of May, 2022, said permanent marker was found flush and the ties were updated

Updated reference ties are as shown below.

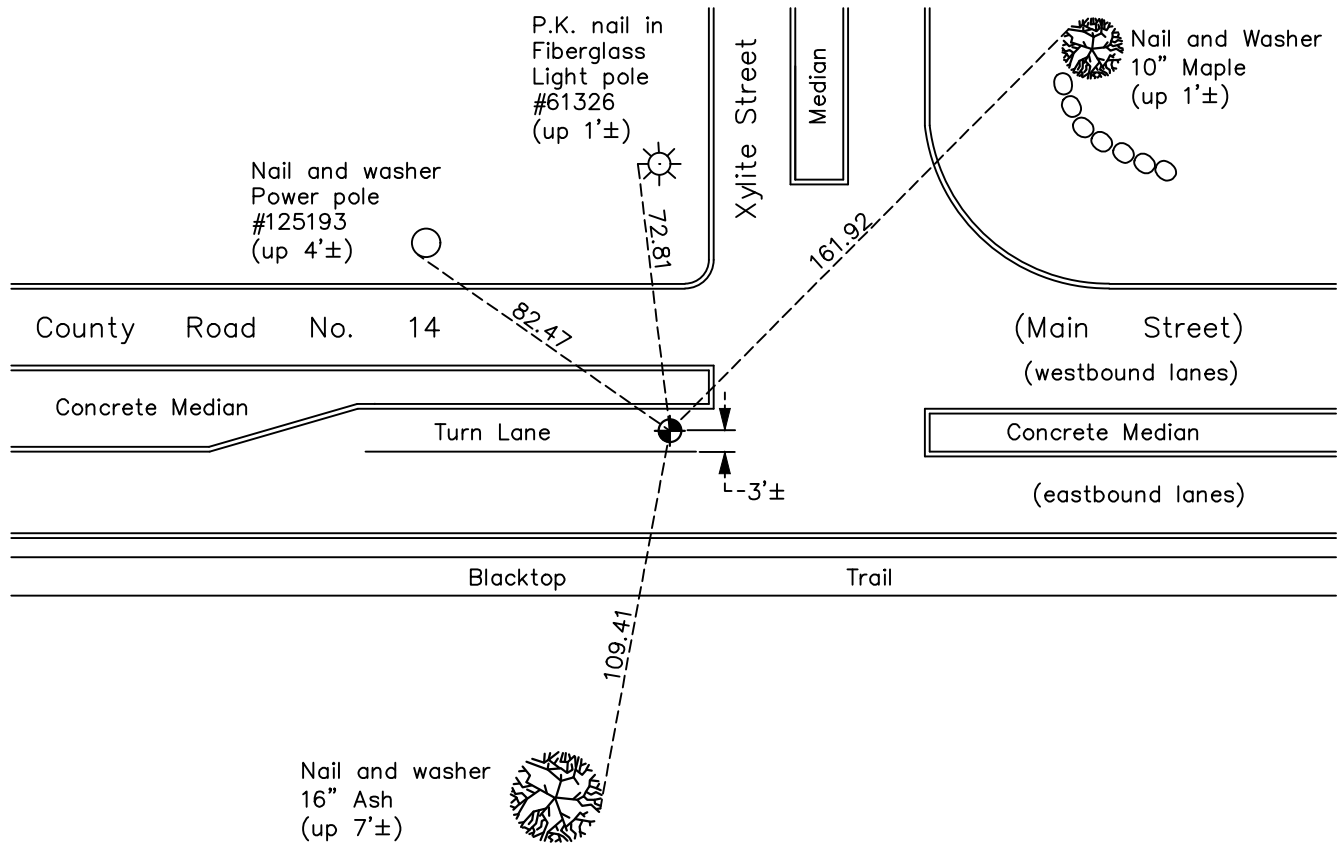

Revision Date
 07/13/2022

N.A.D. 1983 Coordinates
 (1996 Adjustment)

County Project Coordinates	
Northing	159022.6928
Easting	516200.6807
Date	9/03/98

I hereby certify that this United States public land survey monument record is correct and complete to the best of my knowledge and belief.

David Zieglmeier Date 2/8/23

David Zieglmeier Anoka County Surveyor
 Minnesota License Number 46179

HISTORY OF GOVERNMENT CORNER

Page No. 26

County of Anoka

State of Minnesota

Southeast Corner of Sec. 4 Township 31 Range 23

CORNER HISTORY:

Unknown date - Found monument and established ties to monument by Anoka County highway department.

September 18, 1959 - Found 3/4" iron pipe down 2" and updated ties.

May 3, 1963 - Found 3/4" iron pipe and drove iron down to set a bridge spike flush with the road. Updated ties.

July 6, 1964 - Found bridge spike and updated ties.

September 6, 1968 - Found bridge spike and replaced with a cast iron monument flush. Updated ties.

August 24, 1971 - Found cast iron monument and updated ties.

May 22, 1975 - Found cast iron monument and updated ties.

August 10, 1977 - Found cast iron monument and updated ties.

June 5, 1980 - Found cast iron monument and updated ties.

September 1, 1992 - Found cast iron monument and set construction ties prior to road construction.

July 12, 1993 - Set cast iron monument flush after road construction and updated ties.

August 2, 1995 - Found cast iron monument and updated ties.

September 3, 1998 - Found cast iron monument, established NAD 1983 (1996 adj.) Anoka County project coordinates by static GPS methods and updated ties.

May 11, 2006 - Found cast iron monument and updated ties.

July 13, 2010 - Found cast iron monument down after road overlay. Raised flush and updated ties.

June 4, 2014 - Found cast iron monument, verified position by VRS GPS methods and updated ties.

March 23, 2016 - Found cast iron monument, verified position by VRS GPS methods, set construction ties and updated corner ties prior to road construction. Removed monument.

November 15, 2016 - Set cast iron monument flush after road construction using static GPS methods and updated ties.

June 11, 2019 - Found cast iron monument, verified position by VRS GPS methods and updated ties.

May 18, 2022 - Found cast iron monument flush, verified position by VRS GPS methods and updated ties.