

CERTIFICATE OF LOCATION OF GOVERNMENT CORNER

County of Anoka

State of Minnesota

Southeast Corner of Sec. 6 Township 31 Range 23

On the 30th day of August, 1960, the described corner was evidenced by an iron pipe used by Cartwright

and to perpetuate the location of said corner, at the exact location thereof, a permanent marker was placed consisting of a cast iron monument

AND on the 23rd day of May, 2022, said permanent marker was found and the ties were updated

Updated reference ties are as shown below.

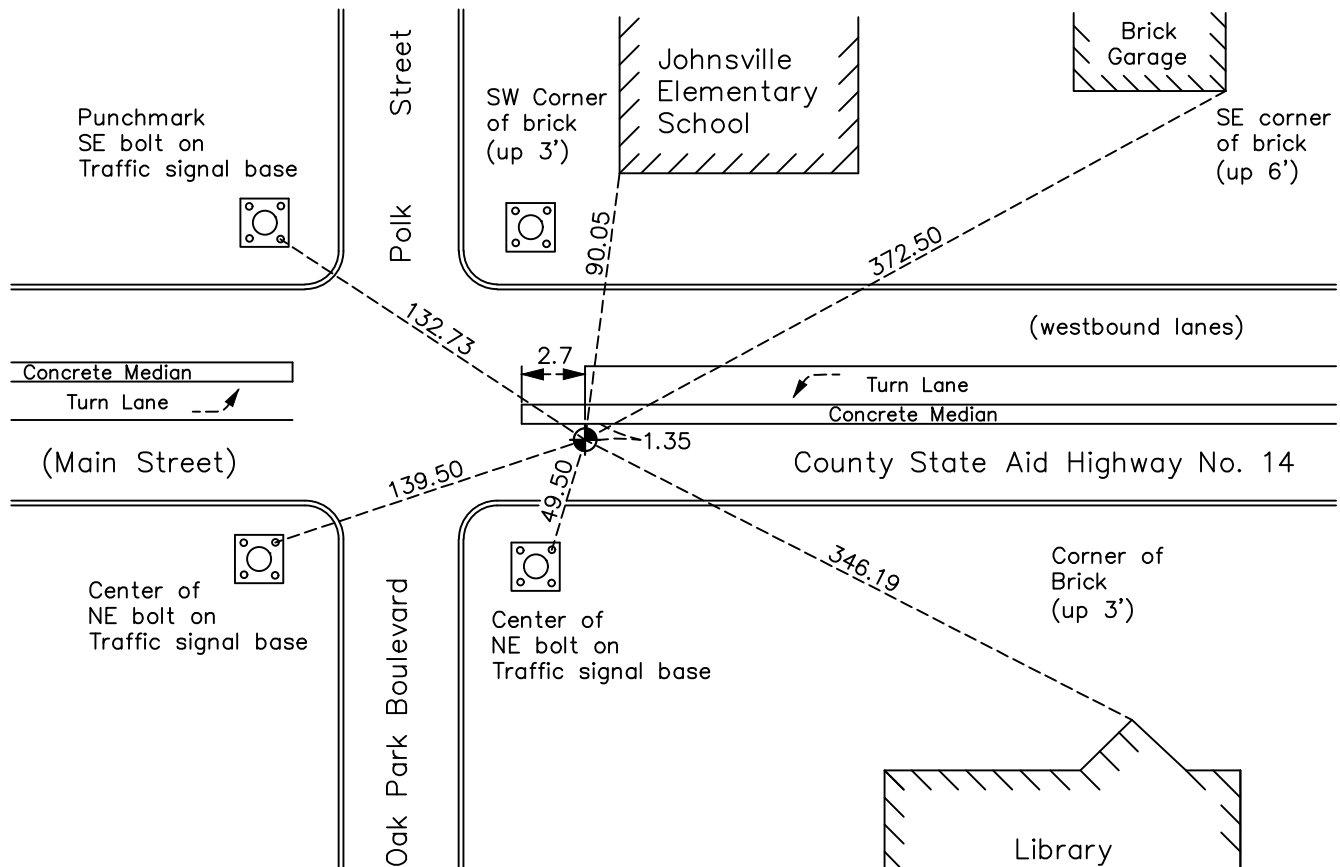

Revision Date
07/13/2022

N.A.D. 1983 Coordinates
(1996 Adjustment)

County Project Coordinates	
Northing	159021.0649
Easting	505546.5037
Date	9/03/98

I hereby certify that this United States public land survey monument record is correct and complete to the best of my knowledge and belief.
David Zieglmeier Date 2/8/23
David Zieglmeier Anoka County Surveyor
Minnesota License Number 46179

HISTORY OF GOVERNMENT CORNER

Page No. 30

County of Anoka

State of Minnesota

Southeast Corner of Sec. 6 Township 31 Range 23

CORNER HISTORY:

June 1957 - Found iron and established ties to iron by Harvey A. Cartwright.

August 30, 1960 - Found iron pipe flush and replaced with cast iron monument flush. Updated ties.

June 29, 1964 - Found cast iron monument and updated ties.

July 16, 1968 - Found cast iron monument and updated ties.

August 25, 1971 - Found cast iron monument and updated ties.

May 22, 1975 - Found cast iron monument and updated ties.

August 10, 1977 - Found cast iron monument and updated ties.

June 5, 1980 - Found cast iron monument and updated ties.

April 18, 1989 - Reset cast iron monument and updated ties after road construction.

August 3, 1990 - Found cast iron monument and updated ties.

August 17, 1995 - Found cast iron monument and updated ties.

September 3, 1998 - Found cast iron monument, established NAD 1983 (1996 adj.) Anoka County project coordinates by static GPS methods and updated ties.

May 2, 2006 - Found cast iron monument and updated ties.

August 2, 2006 - Found cast iron monument and updated ties.

June 22, 2011 - Found cast iron monument, verified position by VRS GPS methods and updated ties prior to road construction. Removed monument.

September 11, 2012 - Set cast iron monument flush after road construction using static GPS methods. Updated ties.

June 5, 2014 - Found cast iron monument and updated ties.

July 31, 2019 - Found cast iron monument, verified position by VRS GPS methods and updated ties.

May 23, 2022 - Found cast iron monument, verified position by VRS GPS methods and updated ties.