

CERTIFICATE OF LOCATION OF GOVERNMENT CORNER

County of Anoka

State of Minnesota

North 1/4 Corner of Sec. 13 Township 31 Range 23

On the 19th day of November, 1964, the described corner was evidenced by area resurvey

and to perpetuate the location of said corner, at the exact location thereof, a permanent marker was placed consisting of 2"x6' Telspar monument with cap and punchmark

AND on the 11th day of January, 2022, said permanent marker was found 2"x6' Telspar mont. w/cap & punchmark up 1.5'±. Ties were updated. Sign & post on east side.

Updated reference ties are as shown below.

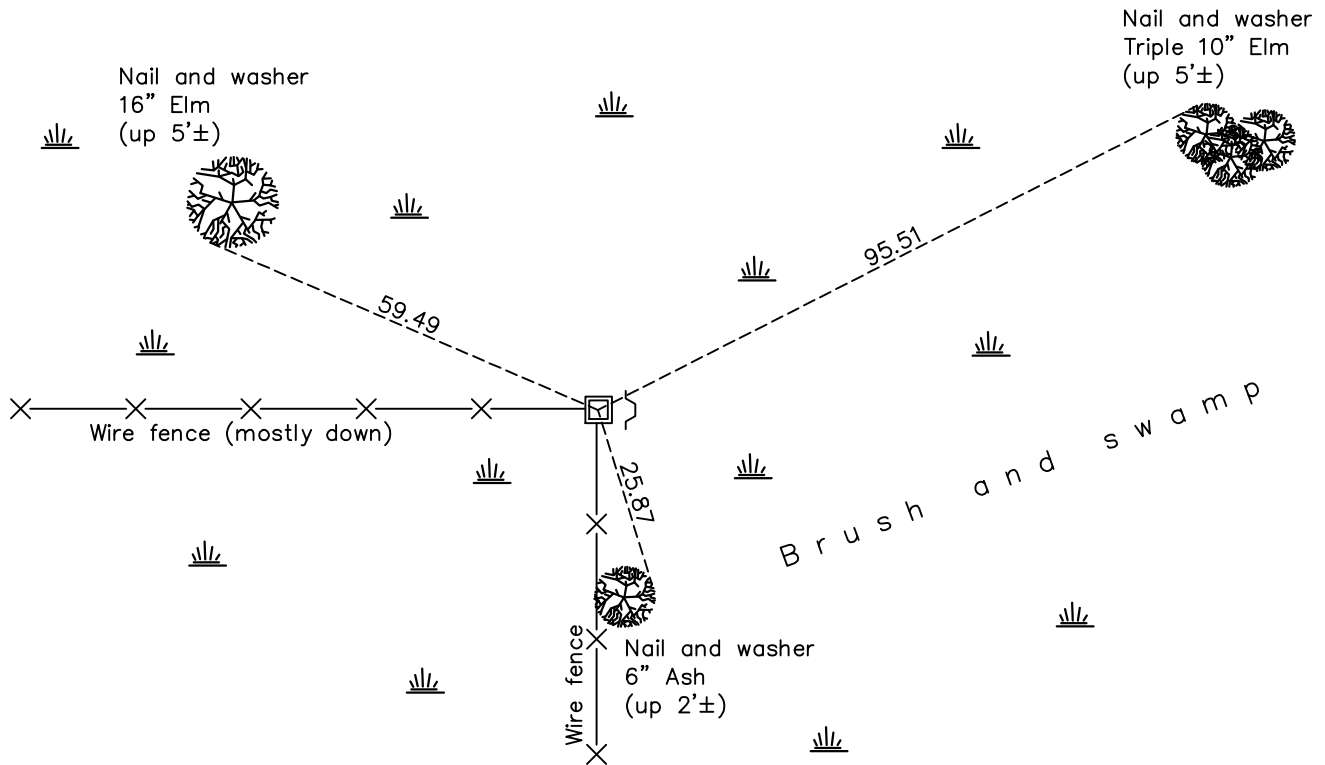

Revision Date
 03/18/22

N.A.D. 1983 Coordinates
 (1996 Adjustment)

County Project Coordinates	
Northing	153505.8269
Easting	529378.8726
Date	11/16/99

I hereby certify that this United States public land survey monument record is correct and complete to the best of my knowledge and belief.

David Zieglermeier Date 2/8/23

David M. Zieglermeier, Anoka County Surveyor
 Minnesota License Number 46179

HISTORY OF GOVERNMENT CORNER

Page No. 39

County of Anoka

State of Minnesota

North 1/4 Corner of Sec. 13 Township 31 Range 23

CORNER HISTORY:

November 19, 1964 - Found 1" iron pipe up 2' and 5.80' east of 1/4 corner according to area resurvey. Replaced found iron pipe with 1" x 10' red and white iron pipe. Established ties to red and white iron pipe.

January 15, 1974 - Found red and white iron pipe and updated ties.

November, 16 1999 - Found red and white iron pipe, established NAD 1983 (1996 adj.) Anoka County project coordinates by static GPS methods and updated ties.

August 23, 2006 - Found red and white iron pipe broken off (up 0.5'). Updated ties.

July 2, 2014 - Found red and white iron pipe in need of replacement. Verified position by VRS GPS methods.

September 17, 2014 - Found broken iron pipe and replaced with a 2" x 6' square steel Telspar with punchmarked cap using static GPS methods. Verified position by VRS GPS methods and updated ties.

January 11, 2022 - Found 2" x 6' square steel Telspar with punchmarked cap, verified position by VRS GPS methods and updated ties.