

# CERTIFICATE OF LOCATION OF GOVERNMENT CORNER

County of Anoka

State of Minnesota

## Southwest Corner of Sec. 11 Township 31 Range 23

On the 10th day of September, 1963, the described corner was evidenced by a concrete monument

and to perpetuate the location of said corner, at the exact location thereof, a permanent marker was placed consisting of a 2" x 7' square steel Telspar with 'County Surveyor' cap & Punchmark.  
Warning sign and post on the East side.

AND on the 12th day of May, 2022, said permanent marker was found up 3'± and the ties were updated.

Updated reference ties are as shown below.

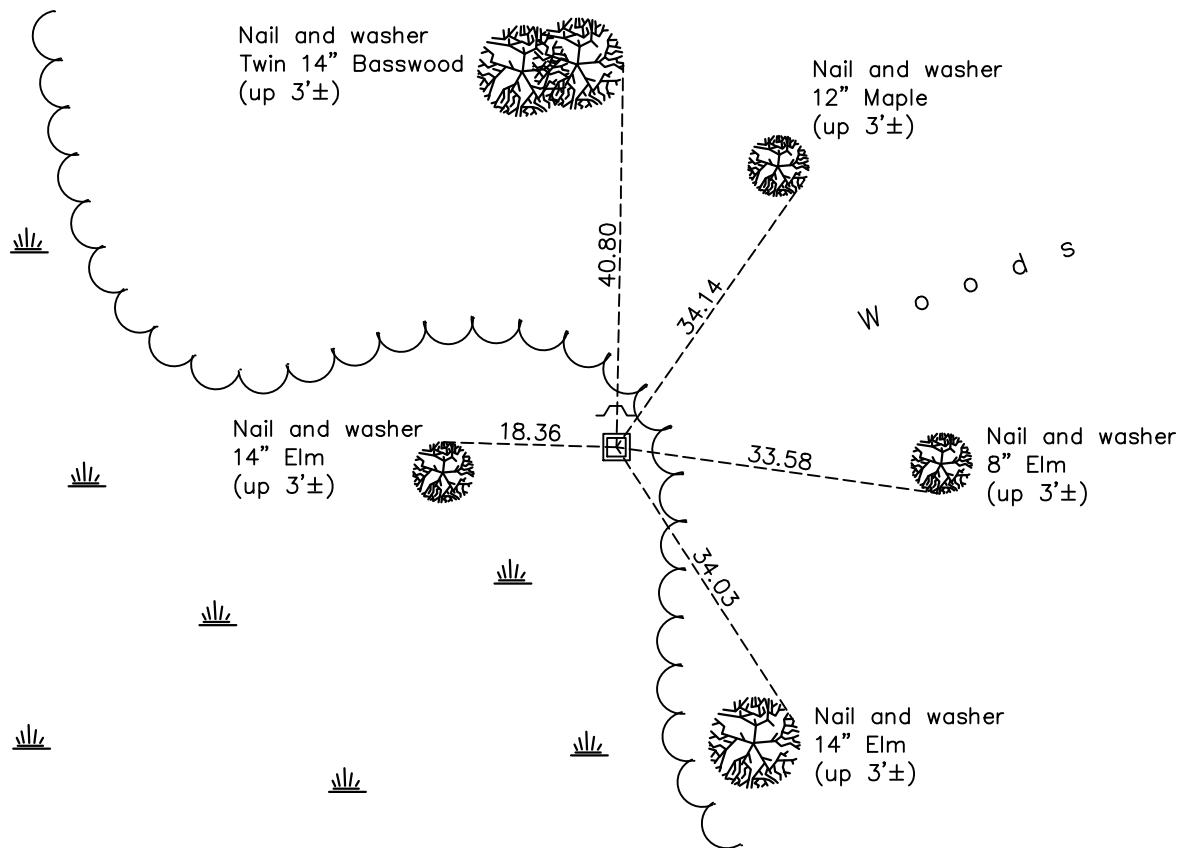

Revision Date

7/14/2022

N.A.D. 1983 Coordinates  
(1996 Adjustment)

County Project Coordinates	
Northing	<u>153554.4320</u>
Easting	<u>521366.4381</u>
Date	<u>8/24/99</u>

I hereby certify that this United States public land survey monument record is correct and complete to the best of my knowledge and belief.

David Zieglmeier Date 2/8/23

David Zieglmeier Anoka County Surveyor  
Minnesota License Number 46179

# HISTORY OF GOVERNMENT CORNER

Page No. 42

County of Anoka

State of Minnesota

## Southwest Corner of Sec. 11 Township 31 Range 23

### **CORNER HISTORY:**

November 23, 1948 - Found concrete monument up 0.5' and established ties to monument.

December 1956 - Found concrete monument and updated ties.

September 10, 1963 - Found 4" square concrete monument up 0.5' using Harvey A. Cartwright 1948 ties.  
Updated ties.

September 23, 1981 - Found concrete monument leaning slightly. Straightened and updated ties.

June 11, 1986 - Found concrete monument and updated ties.

August 8, 1990 - Found concrete monument and updated ties.

July 24, 1995 - Found concrete monument and updated ties.

August 24, 1999 - Found concrete monument, established NAD 1983 (1996 adj.) Anoka County project coordinates by static GPS methods and updated ties.

May 21, 2014 - Found concrete monument up 1'±, leaning and in need of reset.

July 29, 2014 - Found concrete monument and replaced with a 2" x 7" square steel Telspar monument with cap and punchmark up 1'± using static GPS methods. Updated ties.

June 11, 2019 - Found 2" square steel Telspar monument up 3'± and updated ties.

May 12, 2022 - Found 2" square steel Telspar monument up 3'±, verified position by GPS VRS method and updated ties.