

CERTIFICATE OF LOCATION OF GOVERNMENT CORNER

County of Anoka

State of Minnesota

East 1/4 Corner of Sec. 16 Township 31 Range 23

On the 30th day of October, 1964, the described corner was evidenced by area resurvey

and to perpetuate the location of said corner, at the exact location thereof, a permanent marker was placed consisting of a cast iron monument

AND on the 5th day of May, 2022, said permanent marker was found flush and the
ties were updated

Updated reference ties are as shown below.

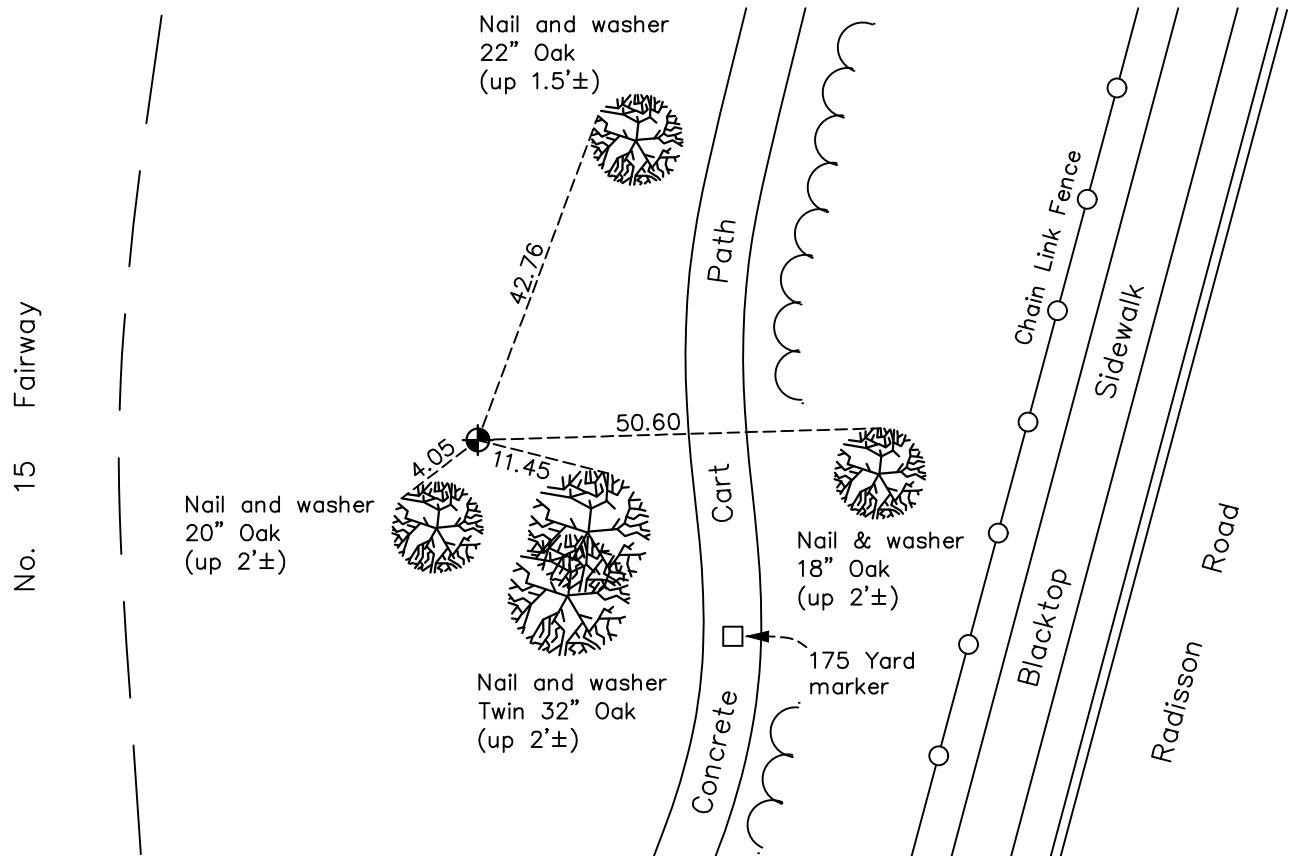

Revision Date
7/14/2022

N.A.D. 1983 Coordinates
 (1996 Adjustment)

County Project Coordinates	
Northing	<u>151059.4218</u>
Easting	<u>516065.5074</u>
Date	<u>10/27/98</u>

I hereby certify that this United States public land survey monument record is correct and complete to the best of my knowledge and belief.

David Zieglmeier Date 2/8/23

David Zieglmeier Anoka County Surveyor
 Minnesota License Number 46179

HISTORY OF GOVERNMENT CORNER

Page No. 53

County of Anoka

State of Minnesota

East 1/4 Corner of Sec. 16 Township 31 Range 23

CORNER HISTORY:

October 30, 1964 - Set cast iron monument up 0.1' using area resurvey and established ties to monument.

August 7, 1968 - Found cast iron monument and updated ties.

September 2, 1971 - Found cast iron monument and updated ties.

May 15, 1975 - Found cast iron monument and updated ties.

August 30, 1977 - Found cast iron monument and updated ties.

June 9, 1980 - Found cast iron monument and updated ties.

July 23, 1990 - Found cast iron monument and updated ties.

July 31, 1995 - Found cast iron monument and updated ties.

October 2, 1998 - Found cast iron monument and updated ties.

October 27, 1998 - Found cast iron monument, established NAD 1983 (1996 adj.) Anoka County project coordinates by static GPS methods and updated ties.

July 10, 2006 - Found cast iron monument and updated ties.

July 30, 2014 - Found cast iron monument and updated ties.

January 6, 2020 - Found cast iron monument, verified position by VRS GPS methods and updated ties.

May 5, 2022 - Found cast iron monument, verified position by VRS GPS method and updated ties.