

CERTIFICATE OF LOCATION OF GOVERNMENT CORNER

County of Anoka

State of Minnesota

Southeast Corner of Sec. 14 Township 31 Range 23

On the 16th day of November, 1964, the described corner was evidenced by area resurvey

and to perpetuate the location of said corner, at the exact location thereof, a permanent marker was placed consisting of a cast iron monument

AND on the 24th day of May, 2023, said permanent marker was set cast iron monument after road construction, verified position using RTK GPS methods. Updated ties.

Updated reference ties are as shown below.

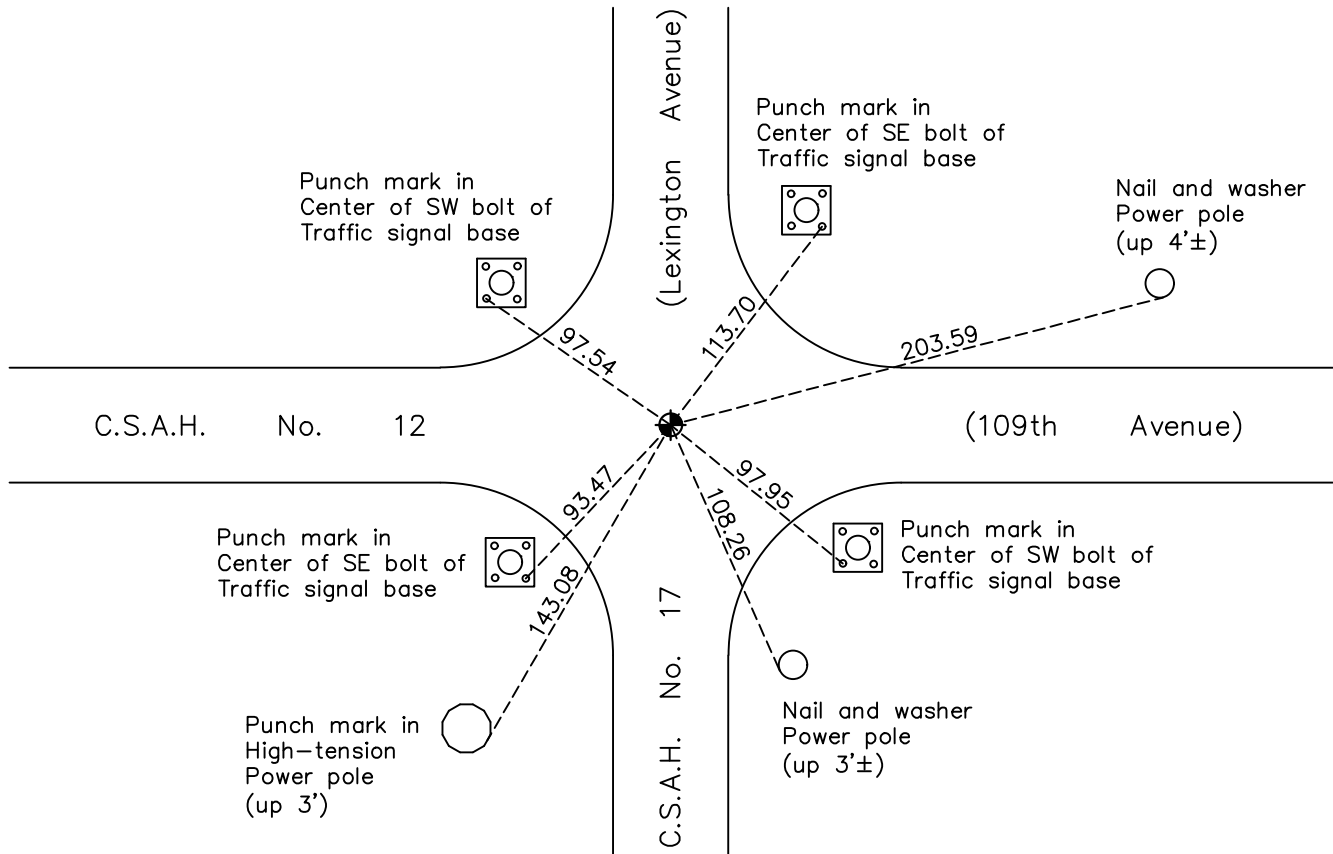

Revision Date

5/31/2023

N.A.D. 1983 Coordinates
(1996 Adjustment)

County Project Coordinates	
Northing	148291.6904
Easting	526714.0655
Date	10/15/98

I hereby certify that this United States public land survey monument record is correct and complete to the best of my knowledge and belief.

David Zieglmeier Date 6/28/23

David Zieglmeier Anoka County Surveyor
Minnesota License Number 46179

HISTORY OF GOVERNMENT CORNER

Page No. 58

County of Anoka

State of Minnesota

Southeast Corner of Sec. 14 Township 31 Range 23

CORNER HISTORY:

November 16, 1964 - Set cast iron monument flush using area resurvey and established ties to monument.

July 22, 1968 - Found cast iron monument and updated ties.

September 1, 1971 - Found cast iron monument and updated ties.

May 22, 1975 - Found cast iron monument and updated ties.

September 26, 1975 - Found cast iron monument down and raised flush.

August 24, 1977 - Found cast iron monument and updated ties.

June 9, 1980 - Found cast iron monument and updated ties.

September 1, 1992 - Found cast iron monument down, raised flush and updated ties.

June 26, 1995 - Found cast iron monument and updated ties.

October 15, 1998 - Established NAD 1983 (1996 adj.) Anoka County project coordinates by static GPS methods.

October 17, 2005 - Found cast iron monument and updated ties.

May 20, 2014 - Found cast iron monument, verified position by VRS GPS methods and updated ties.

July 29, 2019 - Found cast iron monument and updated ties.

May 24, 2023 - set cast iron monument after road construction, verified position using RTK GPS methods.
Updated ties. Job no. 22-131