

CERTIFICATE OF LOCATION OF GOVERNMENT CORNER

County of Anoka

State of Minnesota

Southeast Corner of Sec. 17 Township 31 Range 23

On the 29th day of October, 1964, the described corner was evidenced by area resurvey

and to perpetuate the location of said corner, at the exact location thereof, a permanent marker was placed consisting of a cast iron monument

AND on the 18th day of May, 2022, said permanent marker was found flush and the ties were updated

Updated reference ties are as shown below.

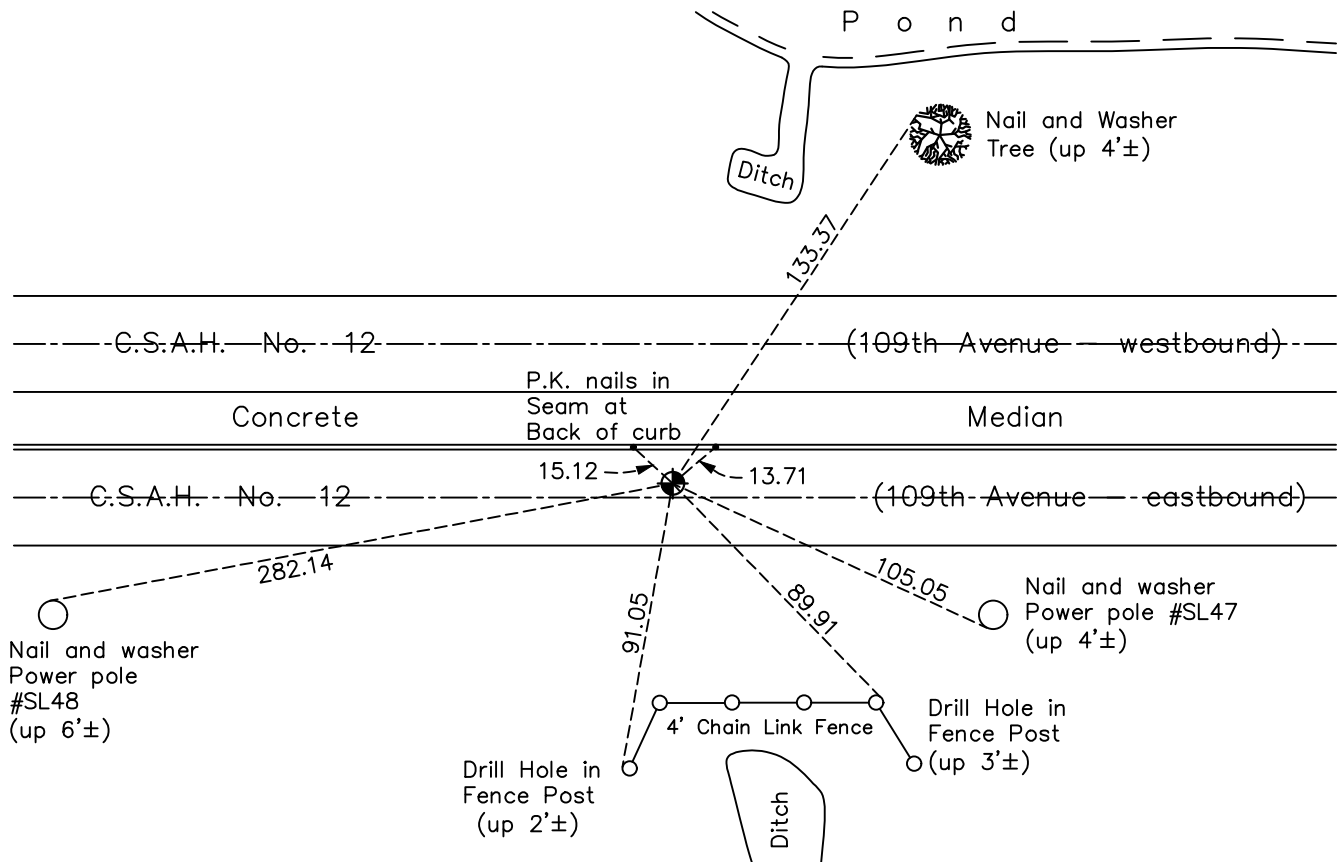

Revision Date
 07/18/2022

N.A.D. 1983 Coordinates
 (1996 Adjustment)

County Project Coordinates	
Northing	148421.2539
Easting	510744.9041
Date	9/03/98

I hereby certify that this United States public land survey monument record is correct and complete to the best of my knowledge and belief.
David Zieglmeier Date 2/8/23
 David Zieglmeier Anoka County Surveyor
 Minnesota License Number 46179

HISTORY OF GOVERNMENT CORNER

Page No. 64

County of Anoka

State of Minnesota

Southeast Corner of Sec. 17 Township 31 Range 23

CORNER HISTORY:

October 29, 1964 - Set cast iron monument flush using area resurvey and established ties to monument.

August 13, 1968 - Found cast iron monument and updated ties.

May 30, 1975 - Found cast iron monument and updated ties.

August 29, 1977 - Found cast iron monument and updated ties.

August 27, 1984 - Found cast iron monument and set construction ties prior to construction.

August 8, 1985 - Set cast iron monument down 0.5'± after construction and updated ties.

March 17, 1986 - Reset cast iron monument using area resurvey and updated ties.

July 17, 1990 - Found cast iron monument and updated ties.

November 18, 1994 - Found cast iron monument and set construction ties prior to construction. Removed monument.

March 31, 1995 - Set cast iron monument after construction and updated ties

July 10, 1995 - Found cast iron monument and updated ties.

September 3, 1998 - Found cast iron monument and updated ties. Established NAD 1983 (1996 adj.) Anoka County project coordinates by static GPS methods.

May 12, 2014 - Found cast iron monument flush. Verified position by VRS GPS methods. Updated ties.

July 29, 2019 - Found cast iron monument flush and updated ties.

May 18, 2022 - Found cast iron monument flush. Verified position by VRS GPS methods. Updated ties.