

# CERTIFICATE OF LOCATION OF GOVERNMENT CORNER

County of Anoka

State of Minnesota

## South 1/4 Corner of Sec. 18 Township 31 Range 23

On the 1st day of November, 1960, the described corner was evidenced by an iron pipe

and to perpetuate the location of said corner, at the exact location thereof, a permanent marker was placed consisting of a cast iron monument

AND on the 10th day of May, 2022, said permanent marker was found flush and the ties were updated

Updated reference ties are as shown below.

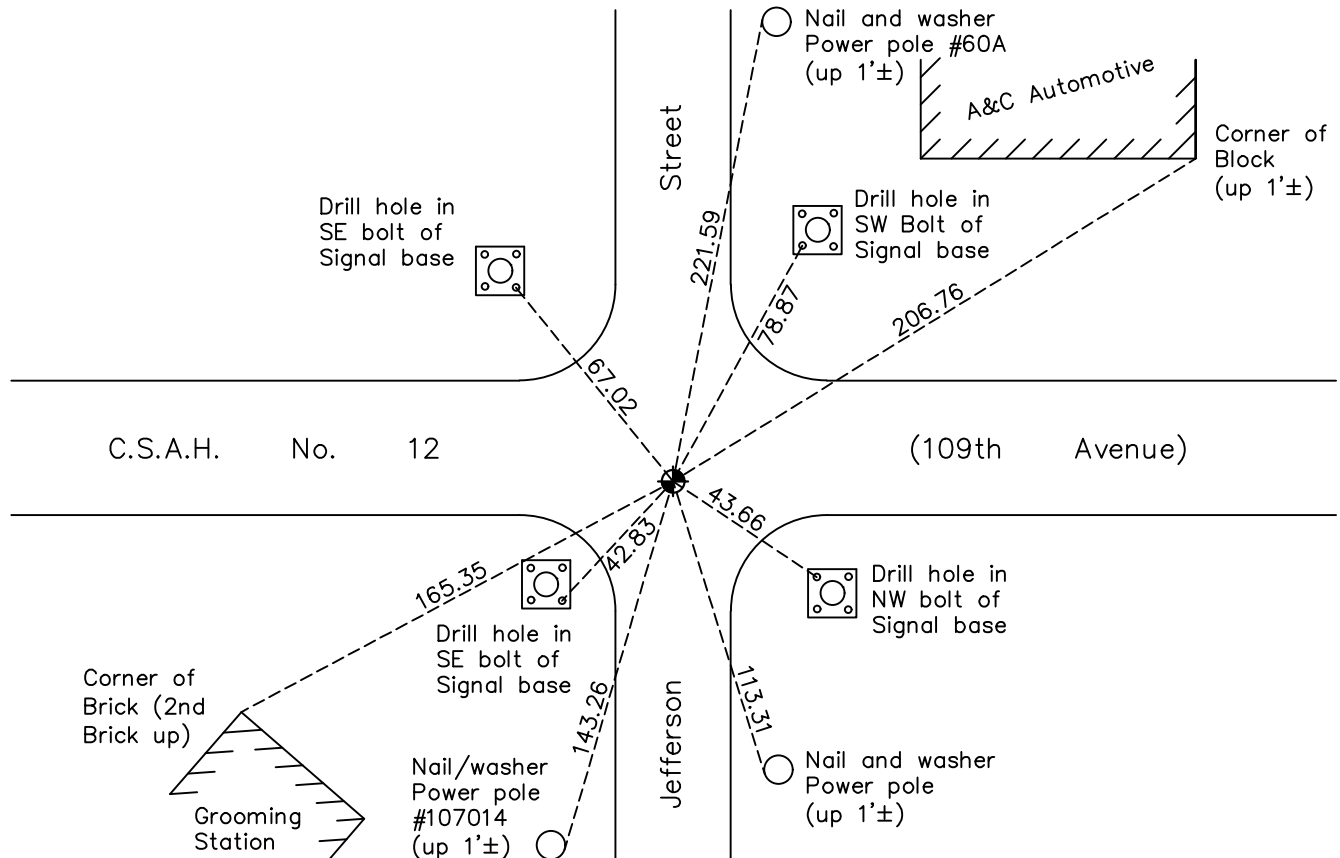

N.A.D. 1983 Coordinates  
(1996 Adjustment)

County Project Coordinates	
Northing	148419.7154
Easting	502831.2463
Date	9/30/98

I hereby certify that this United States public land survey monument record is correct and complete to the best of my knowledge and belief.

*David Zieglmeier* Date 2/28/23

David Zieglmeier Anoka County Surveyor  
Minnesota License Number 46179

Revision Date  
**07/18/2022**

# HISTORY OF GOVERNMENT CORNER

Page No. 67

County of Anoka

State of Minnesota

## South 1/4 Corner of Sec. 18 Township 31 Range 23

### **CORNER HISTORY:**

- January 1960 - Found iron pipe and established ties to monument by Suburban Engineering, Inc.
- November 1, 1960 - Found pinched iron pipe and updated ties.
- August 1, 1961 - Found corner and added ties.
- June 9, 1964 - Found cast iron monument and updated ties prior to road construction.
- August 4, 1964 - Set cast iron monument after construction and updated ties.
- July 29, 1968 - Found cast iron monument and updated ties.
- October 5, 1971 - Found cast iron monument and updated ties.
- June 19, 1975 - Found 1" iron pipe and replaced with a cast iron monument flush. Updated ties.
- August 23, 1977 - Found cast iron monument and updated ties.
- June 4, 1980 - Found cast iron monument and updated ties.
- May 29, 1986 - Found cast iron monument and updated ties.
- July 17, 1990 - Found cast iron monument and updated ties.
- June 6, 1995 - Found cast iron monument and updated ties.
- June 10, 1998 - Found cast iron monument and set construction ties prior to road construction. Removed monument.
- September 3, 1998 - Established NAD 1983 (1996 adj.) Anoka County project coordinates by static GPS methods.
- November 29, 1999 - Set cast iron monument after road construction and updated ties.
- 2006 - Found cast iron monument and updated ties.
- May 12, 2014 - Found cast iron monument and updated ties.
- July 31, 2019 - Found cast iron monument. Verified position by VRS GPS methods. Updated ties.
- May 10, 2022 - Found cast iron monument flush. Verified position by VRS GPS methods. Updated ties.